



SUPERMINI UND MINI
ERWEITERUNGEN IN DER
BOHRUNGS- UND AXIALBEARBEITUNG

SUPERMINI AND MINI
EXTENSIONS FOR BORING AND
AXIAL MACHINING



DER UNTERSCHIED: MEHR MÖGLICHKEITEN

THE DIFFERENCE:
MORE POSSIBILITIES

- **Neue Schneidenausführungen
für die Innenbearbeitung von
Bohrungen**

New insert types for boring

- **Hochleistungsschicht für
allgemeine Stähle**

High performance coating for
common steels

- **Erweiterte Möglichkeiten
beim Axialstechen**

Expanded possibilities for
axial grooving

Schneidplatte

Insert

105

$\varnothing \geq 2 \text{ mm}$

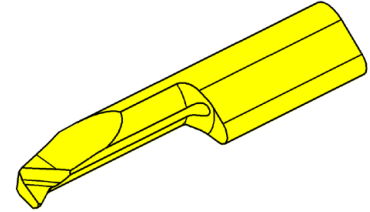
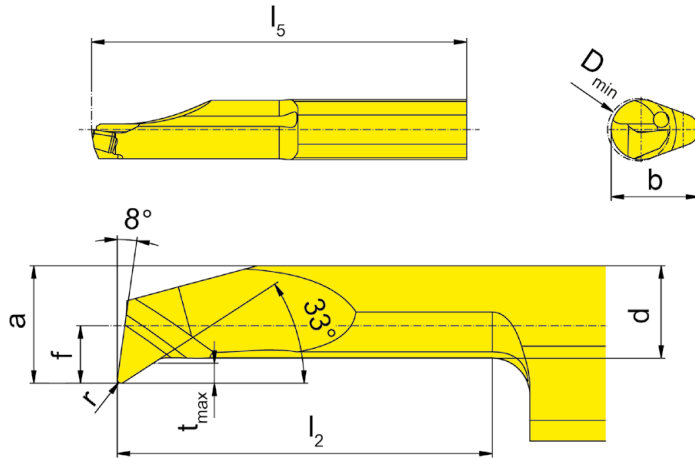
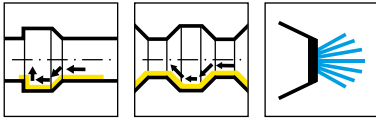

R = rechts wie gezeichnet
R = right hand version shown

L = links spiegelbildlich
L = left hand version

▲ ab Lager
on stock

HM-Sorten
Carbide grades
Δ 4 Wochen
4 weeks

Bestellnummer Part number	r	f	a	d	b	l_2	l_5	t_{max}	D_{min}	HIS	EG35
R105.3315.005.1.2	0,05	1,5	1,9	1,45	5,9	9	25	0,3	2	105123	▲
R105.3315.005.2.2	0,05	1,5	1,9	1,45	5,9	12	30	0,3	2	105123	▲
R105.3313.005.1.3	0,05	1,3	2,6	2	5,9	10	25	0,4	3	105123	▲
R105.3313.005.2.3	0,05	1,3	2,6	2	5,9	15	30	0,4	3	105123	▲
R105.3319.1.4	0,15	1,9	3,7	2,9	6,4	10	25	0,6	4	105124	▲
R105.3319.3.4	0,15	1,9	3,7	2,9	6,4	20	35	0,6	4	105124	▲
R105.3323.2.5	0,15	2,3	4,7	3,7	7	15	30	0,8	5	105125	▲
R105.3323.4.5	0,15	2,3	4,7	3,7	7	25	40	0,8	5	105125	▲
R105.3333.3.6	0,15	3,3	5,7	3,7	7	20	35	1,8	6	105125	▲
R105.3333.5.6	0,15	3,3	5,7	3,7	7	30	45	1,8	6	105125	▲
L105.3319.1.4	0,15	1,9	3,7	2,9	6,4	10	25	0,6	4	105124	Δ
L105.3319.3.4	0,15	1,9	3,7	2,9	6,4	20	35	0,6	4	105124	Δ
L105.3323.2.5	0,15	2,3	4,7	3,7	7	15	30	0,8	5	105125	Δ
L105.3323.4.5	0,15	2,3	4,7	3,7	7	25	40	0,8	5	105125	Δ
L105.3333.3.6	0,15	3,3	5,7	3,7	7	20	35	1,8	6	105125	Δ
L105.3333.5.6	0,15	3,3	5,7	3,7	7	30	45	1,8	6	105125	Δ

P	●
M	●
K	o
N	-
S	-
H	-

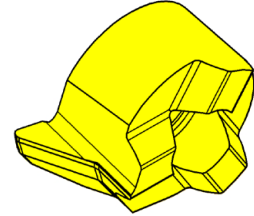
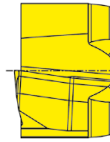
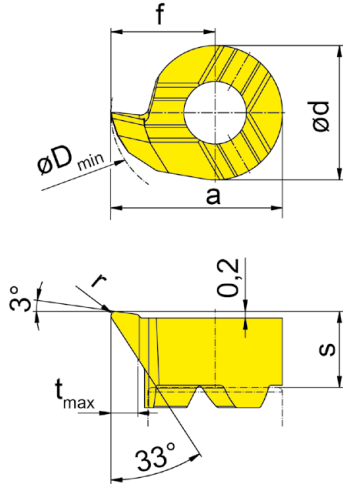
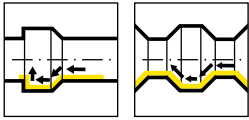

R = rechts wie gezeichnet
R = right hand version shown

L = links spiegelbildlich
L = left hand version

▲ ab Lager
on stock

HM-Sorten
Carbide grades
Δ 4 Wochen
4 weeks

Bestellnummer Part number	s	f	a	r	d	t _{max}	D _{min}	HIS	EG55
R108.3348.01	3,4	4,65	7,65	0,1	6	1,2	7,8	306060R	▲
R108.3348.02	3,4	4,65	7,65	0,2	6	1,2	7,8	306060R	▲
R108.3348.04	3,4	4,65	7,65	0,4	6	1,2	7,8	306060R	▲
L108.3348.01	3,4	4,65	7,65	0,1	6	1,2	7,8	306060L	Δ
L108.3348.02	3,4	4,65	7,65	0,2	6	1,2	7,8	306060L	Δ
L108.3348.04	3,4	4,65	7,65	0,4	6	1,2	7,8	306060L	Δ
									P ●
									M ○
									K ○
									N -
									S -
									H -

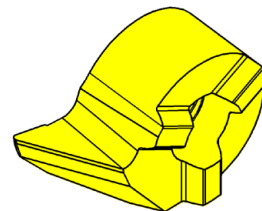
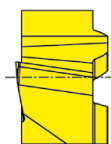
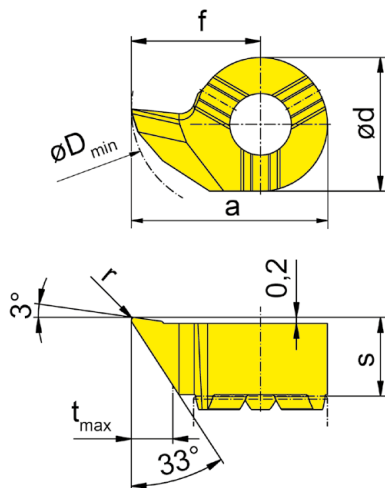
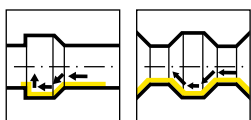

R = rechts wie gezeichnet
R = right hand version shown

L = links spiegelbildlich
L = left hand version

▲ ab Lager
on stock

HM-Sorten
Carbide grades
Δ 4 Wochen
4 weeks

Bestellnummer Part number	s	f	a	r	d	t _{max}	D _{min}	HIS	EG55
R114.3387.02	5,3	8,7	13,2	0,2	9	2,8	13,8	311090R	▲
R114.3387.04	5,3	8,7	13,2	0,4	9	2,8	13,8	311090R	▲
L114.3387.02	5,3	8,7	13,2	0,2	9	2,8	13,8	311090L	Δ
L114.3387.04	5,3	8,7	13,2	0,4	9	2,8	13,8	311090L	Δ

P	●
M	○
K	○
N	-
S	-
H	-

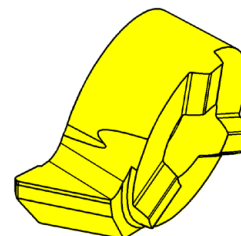
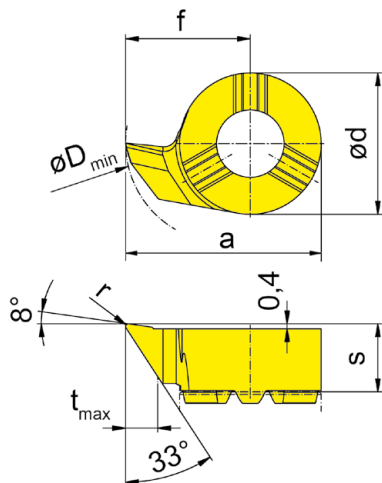
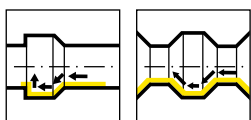

R = rechts wie gezeichnet
R = right hand version shown

L = links spiegelbildlich
L = left hand version

▲ ab Lager
on stock

HM-Sorten
Carbide grades
Δ 4 Wochen
4 weeks

Bestellnummer Part number	s	f	a	r	d	t _{max}	D _{min}	HIS	EG55
R116.3302.02	5,3	9,7	15,2	0,2	11	2,5	15,5	116110R	▲
R116.3302.04	5,3	9,7	15,2	0,4	11	2,5	15,5	116110R	▲
L116.3302.02	5,3	9,7	15,2	0,2	11	2,5	15,5	116110L	Δ
L116.3302.04	5,3	9,7	15,2	0,4	11	2,5	15,5	116110L	Δ
									P ●
									M ○
									K ○
									N -
									S -
									H -

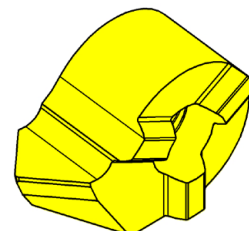
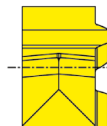
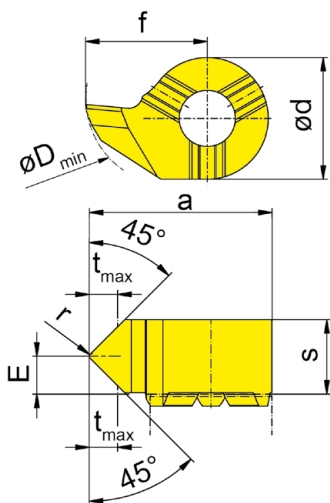
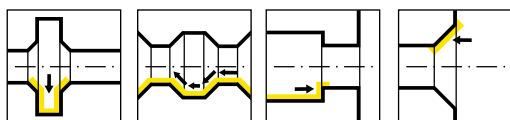

R = rechts wie gezeichnet
R = right hand version shown

L = links spiegelbildlich
L = left hand version

▲ ab Lager
on stock

HM-Sorten
Carbide grades
Δ 4 Wochen
4 weeks

Bestellnummer Part number	E	s	f	a	r	d	t _{max}	D _{min}	HIS	EG55
R114.4545.02	2,8	5,5	9	13,5	0,2	9	2,1	14	311090R	▲
L114.4545.02	2,8	5,5	9	13,5	0,2	9	2,1	14	311090L	Δ
										P ●
										M ○
										K ○
										N -
										S -
										H -

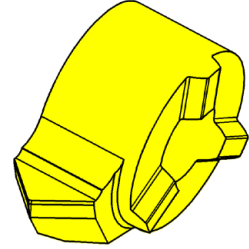
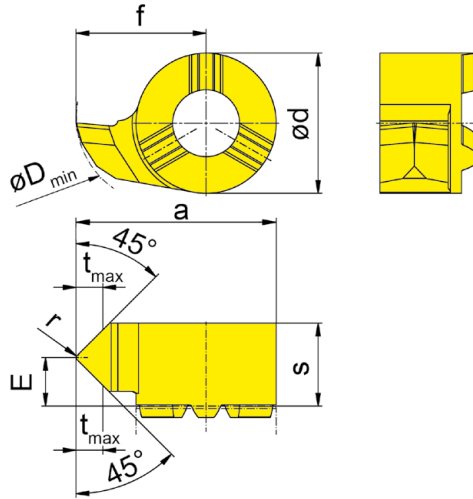
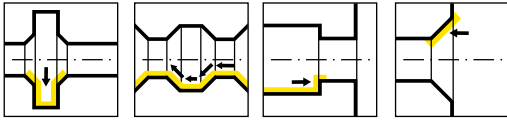

R = rechts wie gezeichnet
R = right hand version shown

L = links spiegelbildlich
L = left hand version

▲ ab Lager
on stock

HM-Sorten
Carbide grades
Δ 4 Wochen
4 weeks

Bestellnummer Part number	E	s	f	a	r	d	t _{max}	D _{min}	HIS	EG55
R116.4545.02	3,8	6,5	10,2	15,7	0,2	11	2,1	16	116110R	▲
L116.4545.02	3,8	6,5	10,2	15,7	0,2	11	2,1	16	116110L	Δ
										P ●
										M ○
										K ○
										N -
										S -
										H -

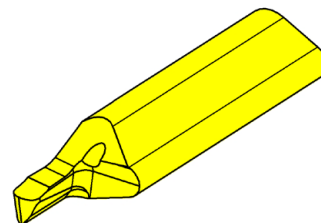
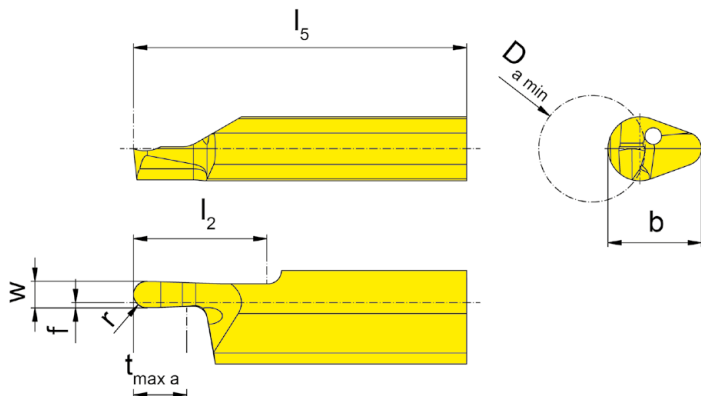
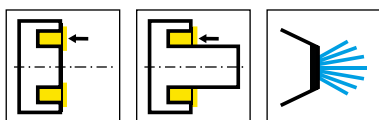

R = rechts wie gezeichnet
R = right hand version shown

L = links spiegelbildlich
L = left hand version

▲ ab Lager
on stock

HM-Sorten
Carbide grades
Δ 4 Wochen
4 weeks

Bestellnummer Part number	w	r	f	b	l_2	l_5	$t_{\max a}$	$D_{a \min}$	HIS	EG35
R105.8V10.1.9	1	0,5	0,4	7	10	25	2	8	105125	▲
R105.8V16.1.9	1,6	0,8	0,4	7	10	25	3	8	105125	▲
R105.8V20.1.9	2	1	0,4	7	10	25	4	8	105125	▲
R105.8V25.1.9	2,5	1,25	0,4	7	10	25	5	8	105125	▲
R105.8V30.1.9	3	1,5	1	7	10	25	6	8	105125	▲
L105.8V10.1.9	1	0,5	0,4	7	10	25	2	8	105125	▲
L105.8V16.1.9	1,6	0,8	0,4	7	10	25	3	8	105125	▲
L105.8V20.1.9	2	1	0,4	7	10	25	4	8	105125	▲
L105.8V25.1.9	2,5	1,25	0,4	7	10	25	5	8	105125	▲
L105.8V30.1.9	3	1,5	1	7	10	25	6	8	105125	▲
										P ●
										M ●
										K ○
										N -
										S -
										H -

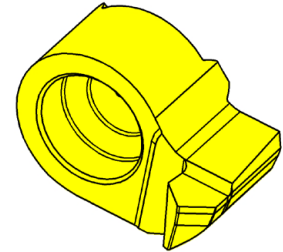
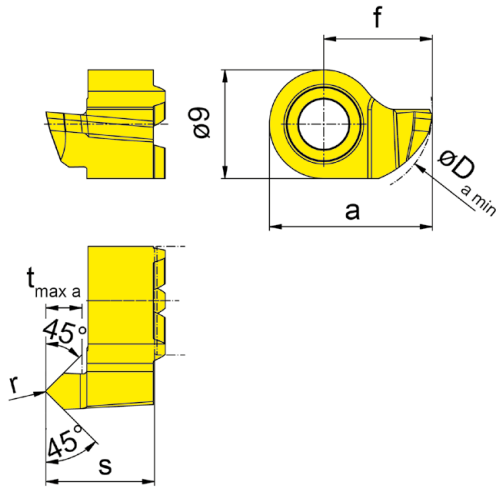
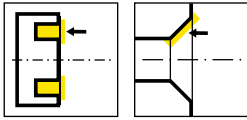

R = rechts wie gezeichnet
R = right hand version shown

L = links spiegelbildlich
L = left hand version

▲ ab Lager
on stock

HM-Sorten
Carbide grades
Δ 4 Wochen
4 weeks

Bestellnummer Part number	s	f	a	r	$t_{\max a}$	$D_{a \min}$	HIS	EG55
R114.4545.14	9	9	13,5	0,1	3	14	311090R	▲
L114.4545.14	9	9	13,5	0,1	3	14	311090L	Δ
								P ●
								M ○
								K ○
								N -
								S -
								H -



**FINDEN SIE JETZT IHRE
PASSENDE WERKZEUGLÖSUNG.**

FIND YOUR RIGHT
TOOLING SOLUTION NOW.

horn-group.com

DEUTSCHLAND, STAMMSITZ

GERMANY, HEADQUARTERS

—

Hartmetall-Werkzeugfabrik

Paul Horn GmbH

Horn-Straße 1

72072 Tübingen

Tel +49 7071 / 7004-0

Fax +49 7071 / 72893

info@de.horn-group.com

horn-group.com