

Plaquette de Coupe Inserto

DGRR

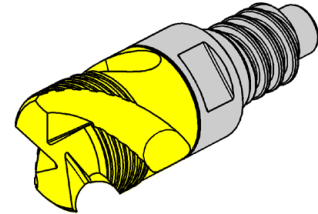
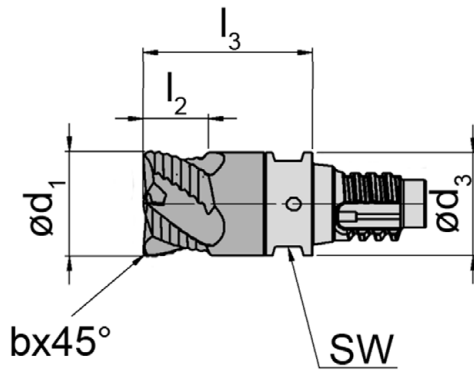
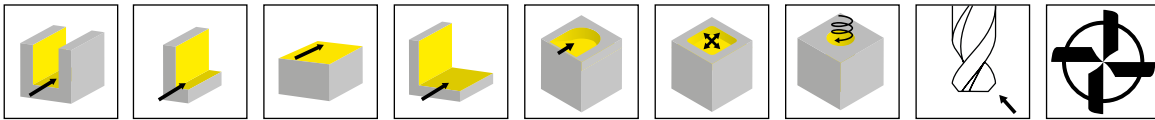

Illustration de coupe à droite représentée
Figura = taglio destro

Nuance
Leghe
▲ en stock
a stock
Δ 4 semaines
4 settimane



N° de commande Codice prodotto	Système Sistema	SW	Z	d ₁	d ₃	l ₃	l ₂	b	HIS	AN2P
DGRR.3.10.1000.00	DG10	8	3	10	9,8	16,8	5,5	0,3	DG0101	▲
DGRR.4.10.1000.00	DG10	8	4	10	9,8	16,8	5,5	0,3	DG0101	▲
DGRR.3.12.1200.00	DG12	10	3	12	11,7	19,3	6,5	0,5	DG0121	▲
DGRR.4.12.1200.00	DG12	10	4	12	11,7	19,3	6,5	0,5	DG0121	▲
DGRR.5.16.1600.00	DG16	13	5	16	15,6	24,8	8,5	0,5	DG0161	▲
DGRR.5.20.2000.00	DG20	17	5	20	19,5	30,3	12	0,5	DG0201	▲
										P ●
										M o
										K -
										N -
										S -
										H -



G



Conditions de coupe DGRR

Parametro di taglio DGRR



	 vc = m/min	 vc = m/min
P1.1	120	140
P1.2	120	140
P1.3	120	140
P1.4	120	140
P1.5	120	140
P1.6	130	150
P2.1	120	140
P2.2	120	140
P2.3	120	140
P2.4	120	140
P3.1	110	130
P3.2	100	120
P4.1	110	130
P4.2	110	130
P5.1	100	120

	 vc = m/min	 vc = m/min
M1.1	80	100
M1.2	60	80
M1.3	50	70
K1.1	120	140
K1.2	120	140
K2.1	110	130
K2.2	100	120
K3.1	100	120
K3.2	100	120
K4.1	90	110
K4.2	80	100
K4.3	80	100
S1.1	80	100
S1.2	70	90
S2.1	50	70
S2.2	40	60

d ₁	 α						
		f _z	a _e	a _p	f _z	a _e	a _p
10	5°	0,06	10	5	0,07	8	5
10	4°	0,05	10	5	0,06	8	5
12	3°	0,06	12	6	0,07	9	6
12	3°	0,06	12	6	0,07	9	6
16	3°	0,09	16	8	0,10	12	8
20	3°	0,11	20	10	0,13	15	10

