

Poli miroir en tournage

Superfinitura in tornitura



**Poli miroir en tournage
avec du MCD**

**Superfinitura in tornitura
con MCD**

B

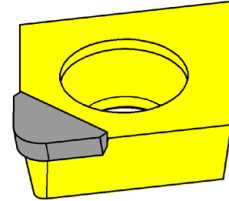
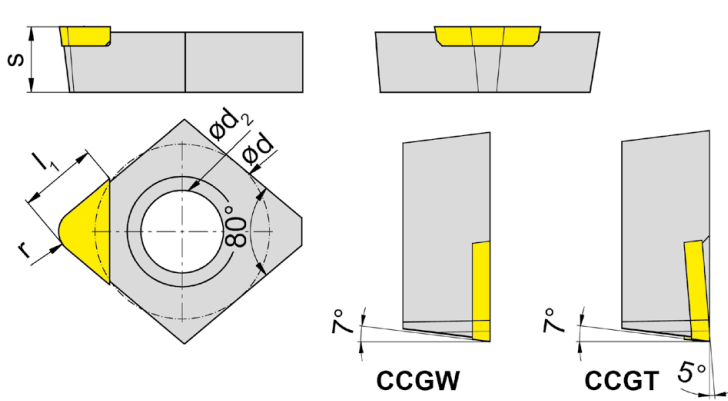
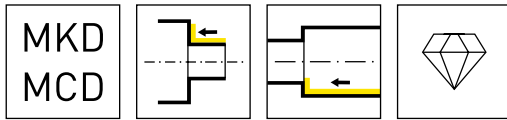

Nuance
Leghe

▲ en stock
a stock

Δ 4 semaines
4 settimane

N° de commande Codice prodotto	d	d ₂	s	l ₁	r	MD10
CCGT060202.MD.W0	6,35	2,8	2,38	2	0,2	▲
CCGW060202.MD.A0	6,35	2,8	2,38	2	0,2	▲
CCGW060202.MD.K0	6,35	2,8	2,38	2	0,2	▲
CCGW060202.MD.M0	6,35	2,8	2,38	2	0,2	▲
CCGT060208.MD.W0	6,35	2,8	2,38	2	0,8	▲
CCGW060208.MD.A0	6,35	2,8	2,38	2	0,8	▲
CCGW060208.MD.K0	6,35	2,8	2,38	2	0,8	▲
CCGW060208.MD.M0	6,35	2,8	2,38	2	0,8	▲
						P -
						M -
						K -
						N ●
						S -
						H -

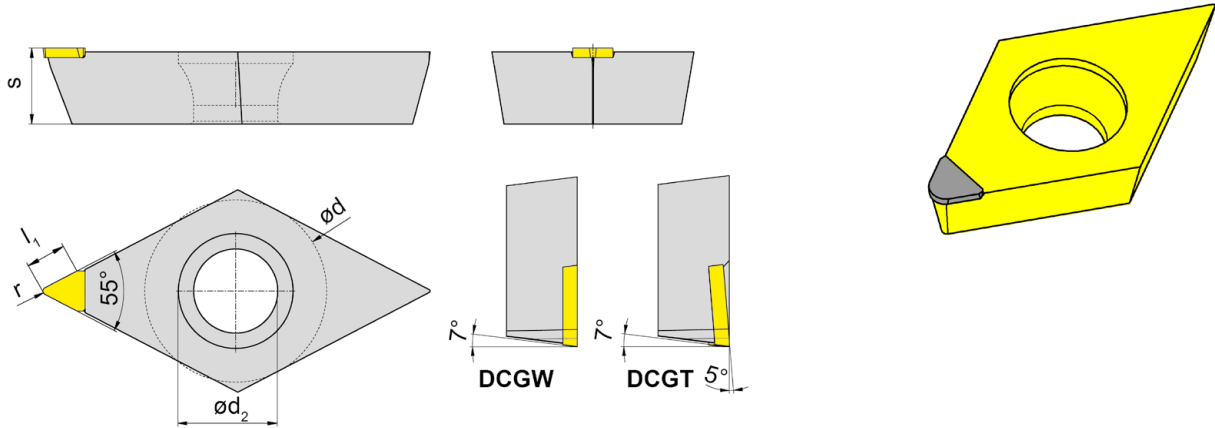
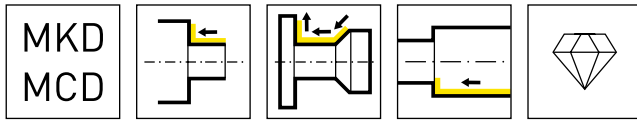

Nuance
Leghe

▲ en stock
a stock

Δ 4 semaines
4 settimane

N° de commande Codice prodotto	d	d ₂	s	l ₁	r	MD10
DCGW11T302.MD.A0	9,525	4,4	3,97	2	0,2	▲
DCGW11T302.MD.K0	9,525	4,4	3,97	2	0,2	▲
DCGW11T302.MD.M0	9,525	4,4	3,97	2	0,2	▲
DCGT11T302.MD.W0	9,525	4,4	3,97	2	0,2	▲
DCGW11T308.MD.A0	9,525	4,4	3,97	2	0,8	▲
DCGW11T308.MD.K0	9,525	4,4	3,97	2	0,8	▲
DCGW11T308.MD.M0	9,525	4,4	3,97	2	0,8	▲
DCGT11T308.MD.W0	9,525	4,4	3,97	2	0,8	▲
						P -
						M -
						K -
						N ●
						S -
						H -

B

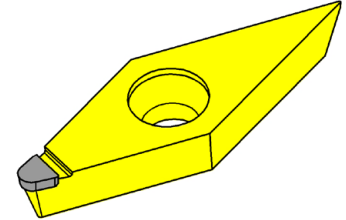
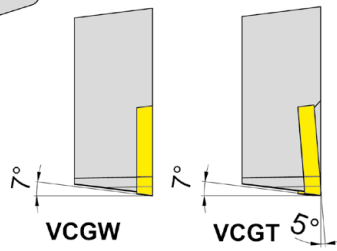
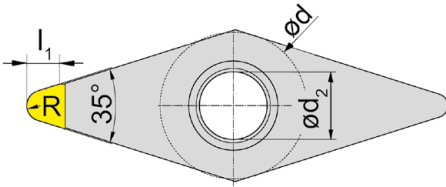
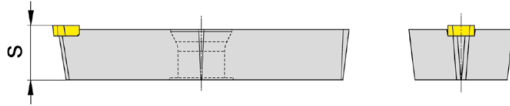
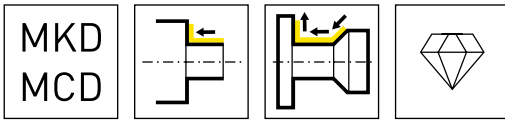

Nuance
Leghe

▲ en stock
a stock

Δ 4 semaines
4 settimane

N° de commande Codice prodotto	d	d ₂	s	l ₁	r	MD10
VCGW160410.MD.A0	9,525	4,4	4,76	2,5	1	▲
VCGW160410.MD.K0	9,525	4,4	4,76	2,5	1	▲
VCGW160410.MD.M0	9,525	4,4	4,76	2,5	1	▲
VCGT160410.MD.W0	9,525	4,4	4,76	2,5	1	▲
						P -
						M -
						K -
						N ●
						S -
						H -

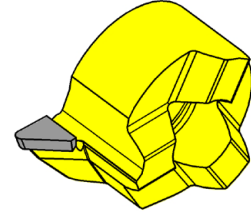
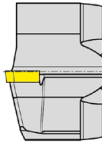
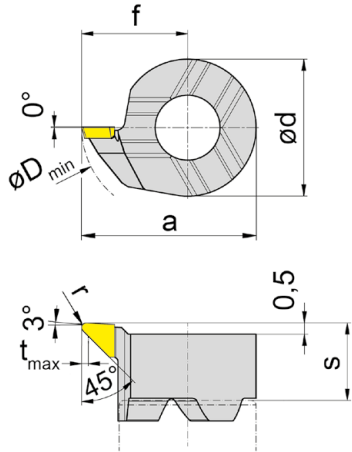
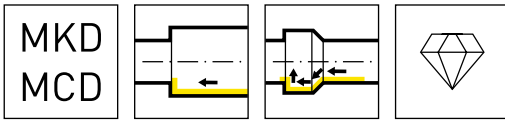

R = version à droite représentée
R = versione destra come in figura

Nuance
Leghe
▲ en stock Δ 4 semaines
a stock 4 settimane

N° de commande Codice prodotto	s	f	a	r	d	t _{max}	D _{min}	HIS	MD10
R108.MDA0.02	3,4	4,65	7,65	0,2	6	0,3	7,8	306060R	▲
R108.MDK0.02	3,4	4,65	7,65	0,2	6	0,3	7,8	306060R	▲
R108.MDM0.02	3,4	4,65	7,65	0,2	6	0,3	7,8	306060R	▲
R108.MDA0.08	3,4	4,65	7,65	0,8	6	0,3	7,8	306060R	▲
R108.MDK0.08	3,4	4,65	7,65	0,8	6	0,3	7,8	306060R	▲
R108.MDM0.08	3,4	4,65	7,65	0,8	6	0,3	7,8	306060R	▲
									P -
									M -
									K -
									N ●
									S -
									H -

B

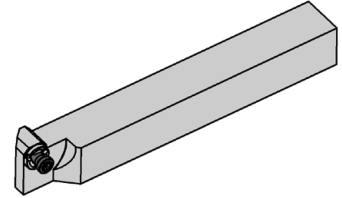
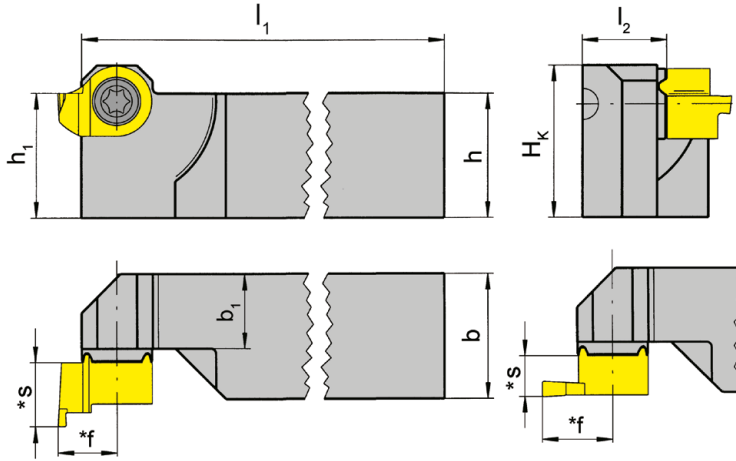
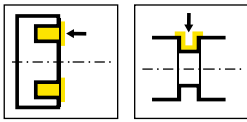

R = version à droite représentée
R = versione destra come in figura

L = version à gauche
L = versione sinistra a specchio

N° de commande Codice prodotto	h	b	l ₁	l ₂	h ₁	b ₁	H _k	HWS
RHC114.1212.01	12	12	122	11,2	12	9,5	15,6	311090R • 311090L
RHC114.1616.01	16	16	122	11,2	16	9,5	19,6	311090R • 311090L
RHC114.2020.01	20	20	122	15,2	20	13,5	23,6	311090R • 311090L
RHC114.2525.01	25	25	147	20,2	25	18,5	28,6	311090R • 311090L
LHC114.1212.01	12	12	122	11,2	12	9,5	15,6	311090R • 311090L
LHC114.1616.01	16	16	122	11,2	16	9,5	19,6	311090R • 311090L
LHC114.2020.01	20	20	122	15,2	20	13,5	23,6	311090R • 311090L
LHC114.2525.01	25	25	147	20,2	25	18,5	28,6	311090R • 311090L

* voir plaquettes
* vd. inserti

Pièces Détachées

Ricambi

Porte outils Portainsero	Vis de serrage Vite di serraggio	Tournevis TORX PLUS® Cacciavite TORX PLUS®
R/LHC114...	4.12T15EP	T15PQ

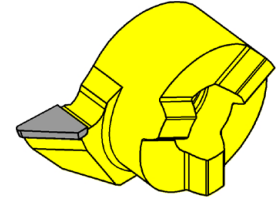
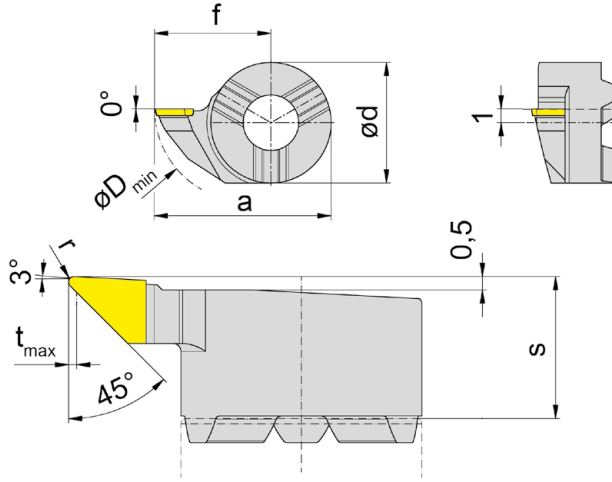
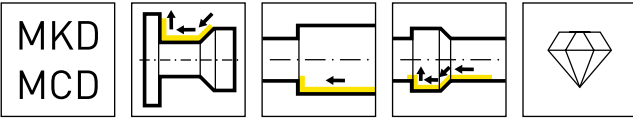

Nuance
Leghe

▲ en stock
a stock

Δ 4 semaines
4 settimane

N° de commande Codice prodotto	s	f	a	r	d	t _{max}	D _{min}	HIS	MD10
R114.MDA0.02	5,3	8,7	13,5	0,2	9	0,3	13,8	311090R	▲
R114.MDK0.02	5,3	8,7	13,5	0,2	9	0,3	13,8	311090R	▲
R114.MDM0.02	5,3	8,7	13,5	0,2	9	0,3	13,8	311090R	▲
R114.MDA0.08	5,3	8,7	13,5	0,8	9	0,3	13,8	311090R	▲
R114.MDK0.08	5,3	8,7	13,5	0,8	9	0,3	13,8	311090R	▲
R114.MDM0.08	5,3	8,7	13,5	0,8	9	0,3	13,8	311090R	▲
									P -
									M -
									K -
									N ●
									S -
									H -

B

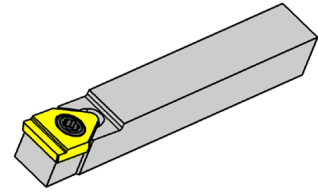
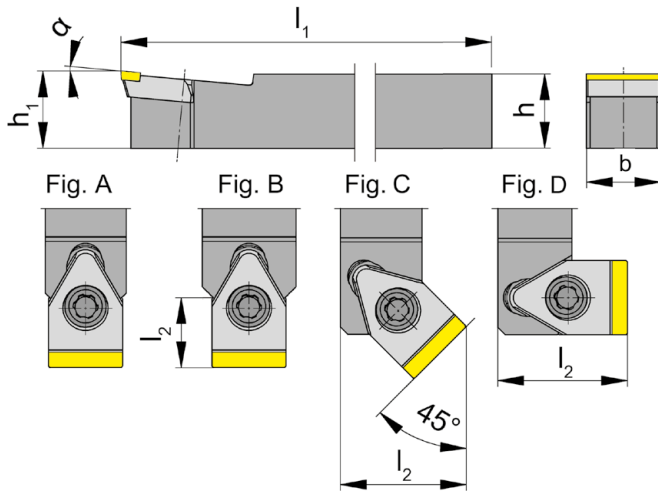
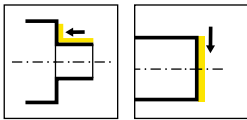

R = version à droite représentée
R = versione destra come in figura

L = version à gauche
L = versione sinistra a specchio

N° de commande Codice prodotto	h	b	l ₁	h ₁	α	Figure	l ₂
RH117.MD10.45.5.10	10	11	100	10,4	5°	C	17
RH117.MD10.90.5.10	10	10	100	10,4	5°	d	17,5
LH117.MD10.45.5.10	10	11	100	10,4	5°	C	17
LH117.MD10.90.5.10	10	10	100	10,4	5°	d	17,5
H117.MD10.00.5.10	10	10	100	10,4	5°	A	-

Pièces Détachées
Ricambi

Porte outils Portainsero	Vis de serrage Vite di serraggio	Tournevis TORX PLUS® Cacciavite TORX PLUS®
H117.MD10.00.5.10	030.400P.0227	T15PQ
R/LH117.MD10...	030.400P.0227	T15PQ

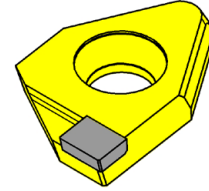
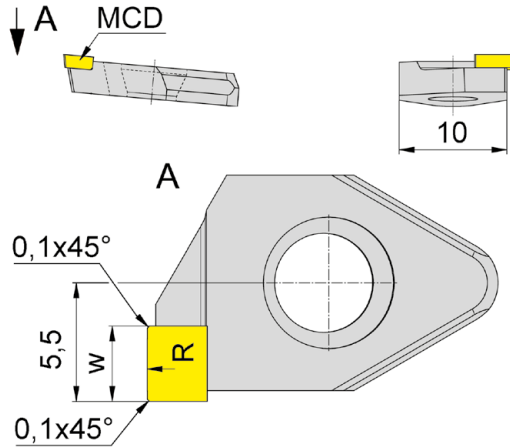
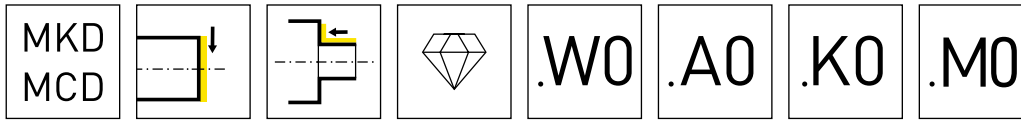

R = version à droite représentée
R = versione destra come in figura

L = version à gauche
L = versione sinistra a specchio

▲ en stock
a stock

Nuance
Leghe
Δ 4 semaines
4 settimane

N° de commande Codice prodotto	r	w	HIS	MD10
RS117.100.00.W0.10	100	3,5	1171005	▲
RS117.300.00.A0.10	300	3,5	1171005	Δ
RS117.300.00.K0.10	300	3,5	1171005	Δ
RS117.300.00.M0.10	300	3,5	1171005	Δ
LS117.100.00.W0.10	100	3,5	1171005	Δ
LS117.300.00.A0.10	300	3,5	1171005	Δ
LS117.300.00.K0.10	300	3,5	1171005	Δ
LS117.300.00.M0.10	300	3,5	1171005	Δ
				P -
				M -
				K -
				N ●
				S -
				H -

B

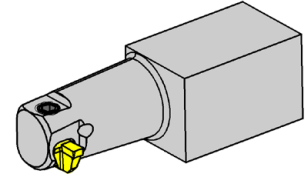
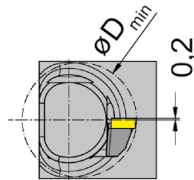
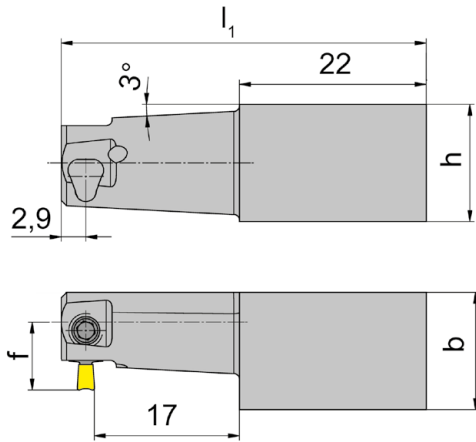
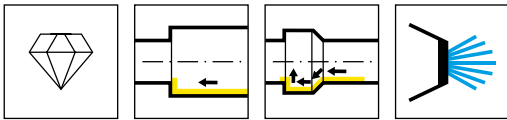

N° de commande Codice prodotto	h	b	l_1	f	D_{min}
RHC105.MD1414.2.10	13,8	13,8	42	8	13,5

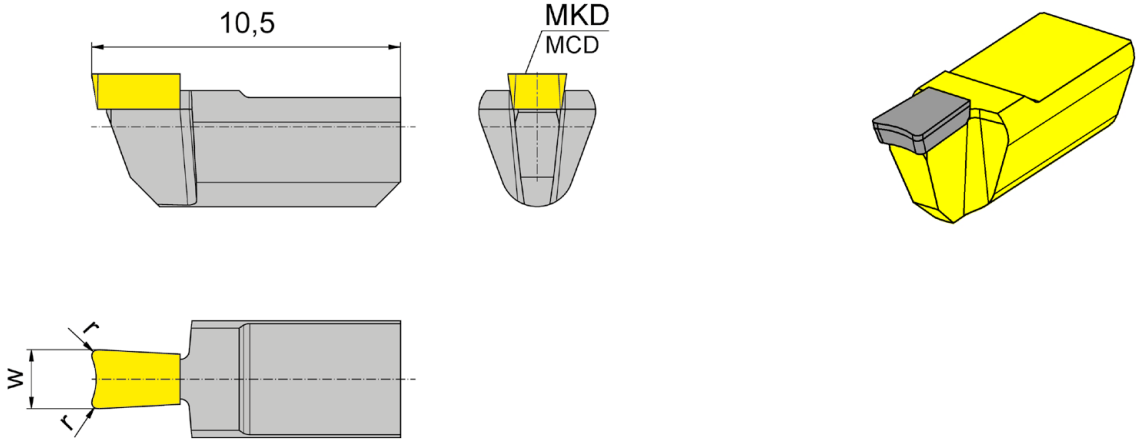
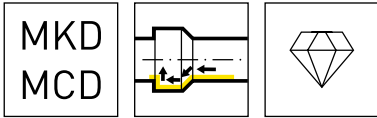

Nuance
Leghe
▲ en stock
a stock
Δ 4 semaines
4 settimane

N° de commande Codice prodotto	r	w	HIS	MD10
105.2020.MD.10	0,2	2	105MD01	▲
				P -
				M -
				K -
				N ●
				S -
				H -

B

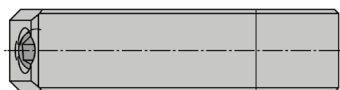
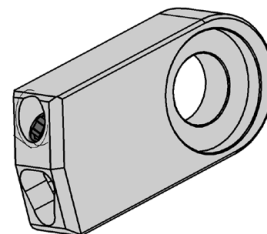
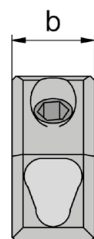
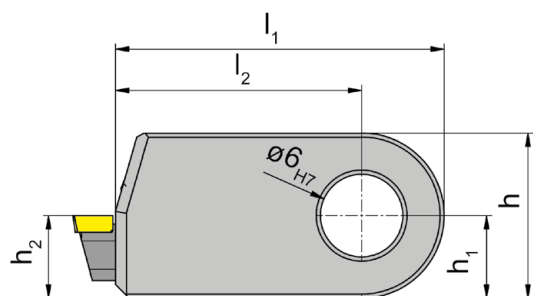
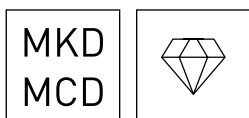

N° de commande Codice prodotto	b	h	h ₂	l ₂	h ₁	l ₁	HWS
NH105.MD06.3.01	6	12	6	17,9	6	23,9	105MD02
NH105.MD06.4.01	6	12	6	17,9	6	24,8	105MD02
NH105.MD06.5.01	6	12	6	19,4	6	23,9	105MD02

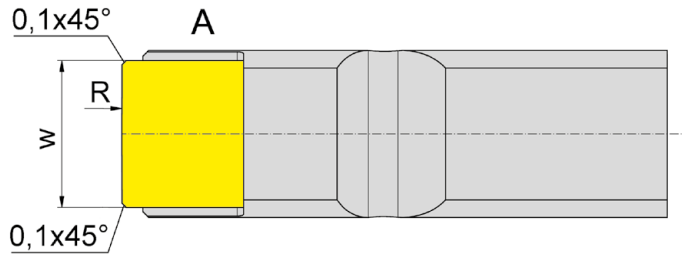
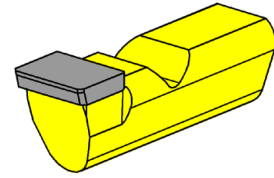
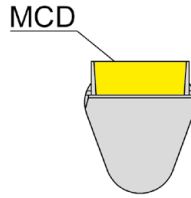
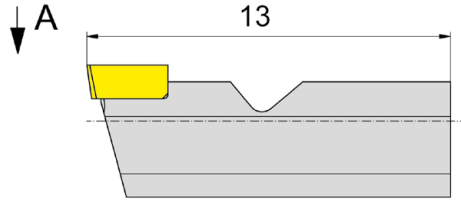

Nuance
Leghe

▲ en stock
a stock

Δ 4 semaines
4 settimane

N° de commande Codice prodotto	r	w	HIS	MD10
105.300.AD.06	300	3,5	105MD02	Δ
105.300.KD.06	300	3,5	105MD02	Δ
105.300.MD.06	300	3,5	105MD02	▲
105.100.WD.06	100	3,5	105MD02	Δ
				P -
				M -
				K -
				N ●
				S -
				H -

B

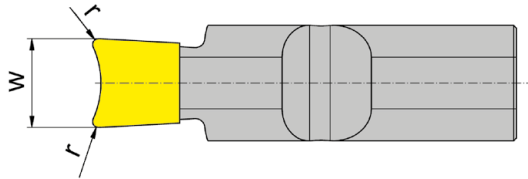
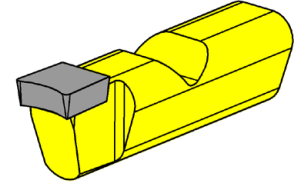
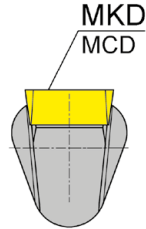
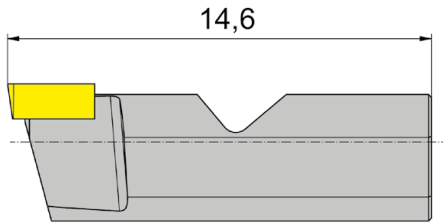
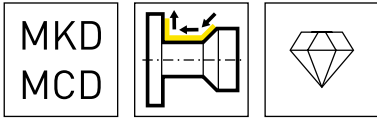

Nuance
Leghe

▲ en stock
a stock

Δ 4 semaines
4 settimane

N° de commande Codice prodotto	r	w	HIS	MD10
105.3030.MD06	3	3,05	105MD02	▲
				P -
				M -
				K -
				N ●
				S -
				H -

Conditions de coupe

Parametri di taglio



B

Matière à usiner Materiale da lavorare	v_c		f_n / f_z (mm/trs) (mm/giro)	a_p (mm)	Géométrie Geometria	Refroidissement recommandé Raffreddamento consigliato
	min	max				
Ag	50	300	0,010 - 0,06	0,005 - 0,05	M	Huile Olio
Al / Mg	100	2.500	0,005 - 0,15	0,005 - 0,05	A	Émulsion Emulsione
Au	50	300	0,005 - 0,06	0,005 - 0,05	M	Huile Olio
Cu	50	500	0,005 - 0,08	0,005 - 0,04	A	Huile Olio
CuNi	40	250	0,010 - 0,06	0,005 - 0,04	M / A	Émulsion Emulsione
CuSn	50	300	0,005 - 0,08	0,005 - 0,04	A	Huile Olio
CuW	40	250	0,010 - 0,07	0,005 - 0,04	A	Huile Olio
CuZn	50	450	0,005 - 0,10	0,005 - 0,05	M	Huile Olio
CuZn sans plomb / faible plomb senza piombo / a basso tenore di piombo	50	350	0,005 - 0,10	0,005 - 0,05	A	Huile Olio
Ir / Pd / Pt	30	100	0,005 - 0,05	0,005 - 0,03	A	Émulsion Emulsione
Mo	35	120	0,010 - 0,05	0,005 - 0,03	A	Émulsion Emulsione
Ni	40	200	0,010 - 0,06	0,005 - 0,03	M / A	Émulsion Emulsione
Ti	40	200	0,010 - 0,06	0,005 - 0,03	K	Émulsion Emulsione
Zn	80	350	0,005 - 0,12	0,005 - 0,05	A	Émulsion Emulsione
PA	60	220	0,010 - 0,25	0,010 - 0,10	spéciales speciali	Émulsion Emulsione
PC	50	200	0,005 - 0,20	0,010 - 0,10	K	Émulsion / Air Emulsione / Aria
PE	80	350	0,010 - 0,25	0,010 - 0,10	spéciales speciali	Émulsion Emulsione
PEEK	60	250	0,010 - 0,25	0,010 - 0,10	spéciales speciali	Émulsion Emulsione
PMMA	80	300	0,005 - 0,20	0,010 - 0,10	K	Émulsion / Air Emulsione / Aria
POM	80	350	0,010 - 0,25	0,010 - 0,10	K	Émulsion Emulsione
PTFE	70	300	0,01 - 0,25	0,010 - 0,10	spéciales speciali	Émulsion Emulsione
PVC	60	250	0,01 - 0,25	0,010 - 0,10	spéciales speciali	Émulsion Emulsione

Fraises à surfer et à contourner
Fresa per scrittura
DSFF.MD/DST.MD

MKD
MCD

Page/Pag.
182

Microfraise hemispherique
Microfrese raggio completo
DSK.MD

MKD
MCD

Page/Pag.
183

Fraise Hémisferique
Frese Sferiche
DSK.MD

MKD
MCD

Page/Pag.
184

Fraise à moyeu
Fresa a manicotto
DTM

MKD
MCD

Page/Pag.
186

Plaquette
Inserto
DTS/105

MKD
MCD

Page/Pag.
187, 193

Masselotte
Inserto di bilanciatura
DTS

MKD
MCD

Page/Pag.
188

Conditions de coupe
Parametri di taglio

Page/Pag.
194