

Serrated Tool Bodies | Insert Holders

Diameter Range: 20.00 mm - 32.00 mm

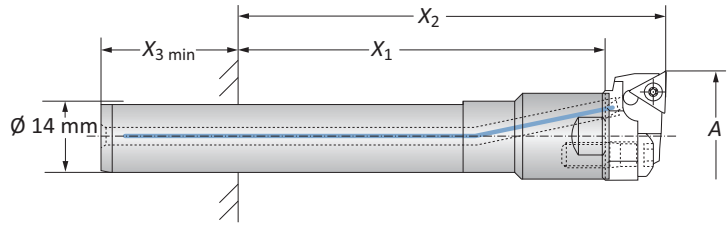

Serrated Tool Bodies

Substrate	Boring Range A	Serrated Tool Body*			Weight	Part No.
		X ₁	X ₂	X _{3 min}		
Steel	20.00 - 32.00	37.00 - 72.00	49.00 - 84.00	30.00	0.13 (kg)	514029
Carbide	20.00 - 32.00	65.00 - 100.00	77.00 - 112.00	30.00	0.25 (kg)	514030
Carbide	20.00 - 32.00	100.00 - 135.00	112.00 - 147.00	30.00	0.33 (kg)	514031

*Fixture-through reducing sleeve (B10-A: 17)

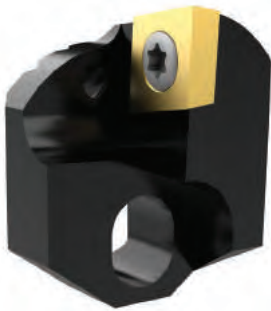

Form 101

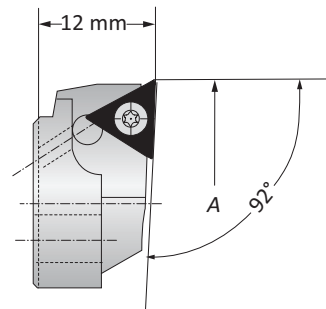

Form 20

Insert Holders

Boring Range A	Weight	Insert Form	Part No.	Insert Form	Part No.
20.00 - 22.00	0.01 (kg)	101	502052	20*	502046
22.00 - 24.00	0.01 (kg)	101	502053	20*	502047
24.00 - 26.00	0.01 (kg)	101	502054	20*	502048
26.00 - 28.00	0.01 (kg)	101	502055	20*	502049
28.00 - 30.00	0.01 (kg)	101	502056	20*	502050
30.00 - 32.00	0.01 (kg)	101	502057	20*	502051

*Not suitable for indexable inserts with a radius of 0.80 mm

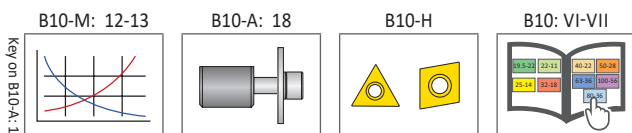

m = Metric (mm)
Inserts sold separately

Serrated Tool Bodies | Insert Holders

Diameter Range: 29.00 mm - 53.00 mm

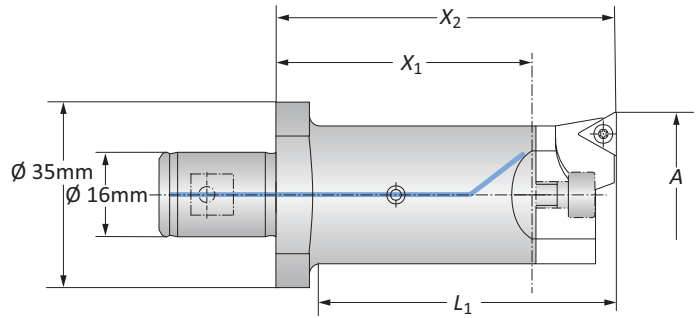

Serrated Tool Bodies

	Boring Range	Serrated Tool Body			Weight	Part No.
	A	X ₁	X ₂	L ₁		
m	29.00 - 53.00	48.00	64.00	56.00	0.20 (kg)	236021
	29.00 - 53.00	84.00	100.00	92.00	0.30 (kg)	236031

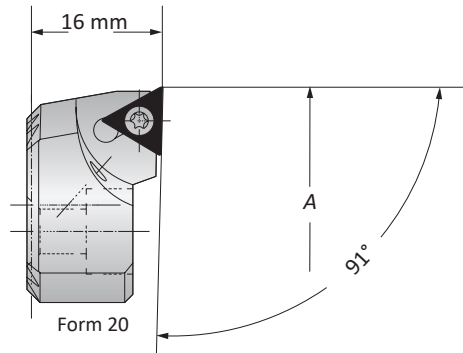

Insert Holders

	Boring Range	Weight	Insert Form	Part No.
	A			
m	29.00 - 41.00	0.04 (kg)	101	236023
	29.00 - 41.00	0.04 (kg)	20*	236022
	40.00 - 53.00	0.06 (kg)	101	236025
	40.00 - 53.00	0.06 (kg)	20*	236024

*Not suitable for indexable inserts with a radius of 0.80 mm

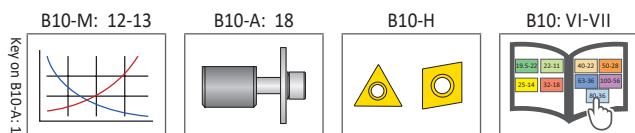

B10-A: 12

www.alliedmachine.com | +44 (0) 1384 400 900 | enquiries.eu@alliedmachine.com

m = Metric (mm)
Inserts sold separately

Alu-Line Serrated Slides | Insert Holders

Diameter Range: 68.00 mm - 152.00 mm

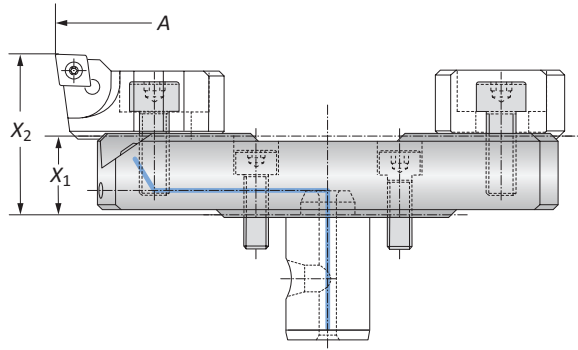

Alu-Line Serrated Slides

	Boring Range		Serrated Slide		Weight	Part No.
	A	X ₁	X ₂			
	68.00 - 96.00	16.00	32.50		0.10 (kg)	501054
	96.00 - 124.00	16.00	32.50		0.10 (kg)	501055
	124.00 - 152.00	16.00	32.50		0.20 (kg)	501056

Insert Holders

	Boring Range		Weight	Insert Form	Part No.
	A				
	68.00 - 152.00	0.05 (kg)	101	502064	
	68.00 - 152.00	0.05 (kg)	20	502069	



Form 20

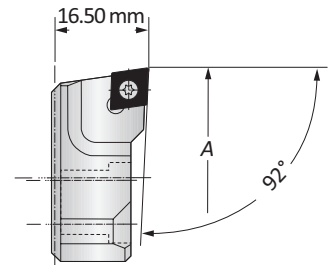

Form 101

Counterweight

	Counterweight		Part No.
	X ₁	Weight	
	13.40	0.05 (kg)	502165

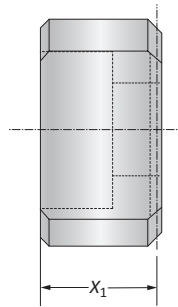

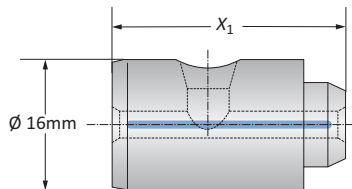

Alu-Line Coolant Delivery Section

	Coolant Delivery		Part No.
	X ₁	Weight	
	25.50	0.01 (kg)	450137

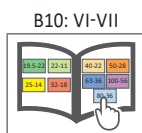
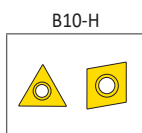
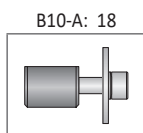

B10-M: 12-13
Key on B10-A-1



 = Metric (mm)
Inserts sold separately

Insert Holders for Boring Heads

Diameter Range: 52.00 mm - 102.00 mm



Form 101

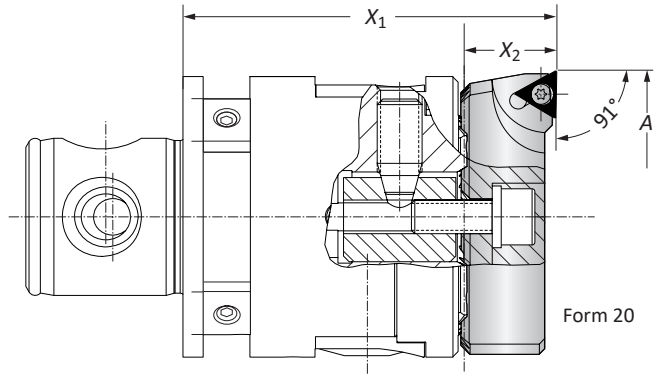

Form 20

Insert Holders for Boring Heads

	Boring Range		Insert Holder		Weight	Insert Form	Part No.
	A		X ₁	X ₂			
Ⓜ	52.00 - 77.00		66.00	16.50	0.06 (kg)	101	236027
	52.00 - 77.00		66.00	16.50	0.06 (kg)	20	236026
	76.00 - 102.00		66.00	16.50	0.10 (kg)	101	236029
	76.00 - 102.00		66.00	16.50	0.10 (kg)	20	236028

Clamping Piece for Insert Holder for Boring Heads

	Boring Range	Service Key	Complete Part No.
Ⓜ	52.00 - 102.00	s5	236020

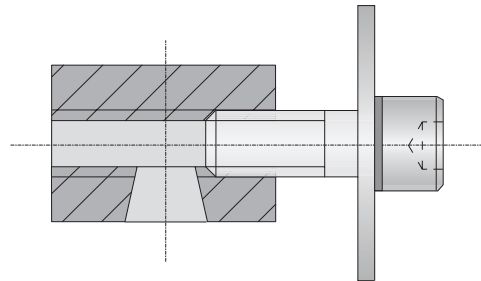

B10-M: 12-13

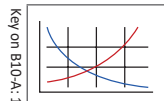

B10-A: 18

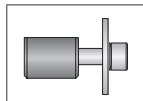

B10-H

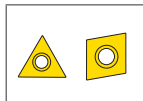

B10: VI-VII

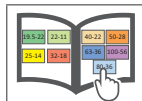

B10-A: 14

www.alliedmachine.com | +44 (0) 1384 400 900 | enquiries.eu@alliedmachine.com

Ⓜ = Metric (mm)
Inserts sold separately

Outside Turning Insert Holders for Boring Heads

Outside Turning | Diameter Range: 4.00 mm - 66.00 mm

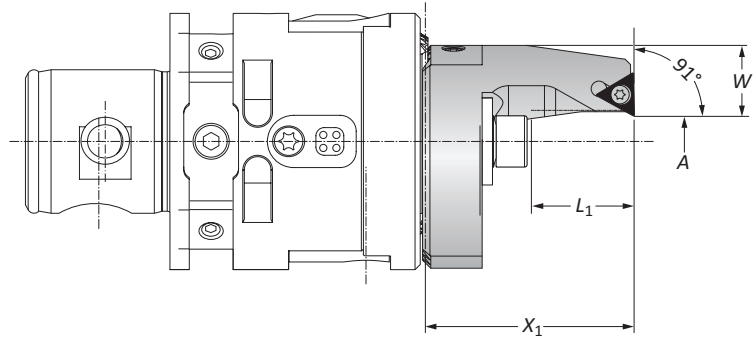

Type A Insert Holders

	Boring Range		Insert Holder			Weight	Type	Insert Form	Part No.
	A	X ₁	L ₁	W					
m	4.00 - 17.50	40.50	20.00	16.60	0.10	A	20*	236081	
	16.50 - 30.00	50.50	30.00	11.10	0.10	A	20*	236082	

NOTE: Clockwise and neutral execution

*Not suitable for indexable inserts with a radius of 0.80 mm

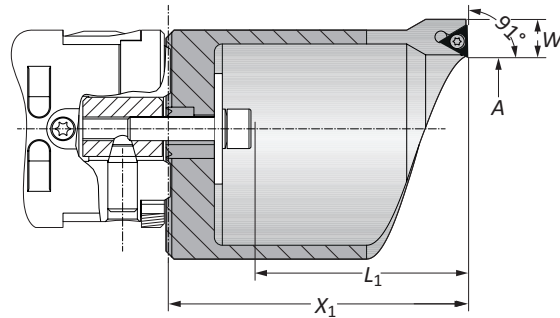
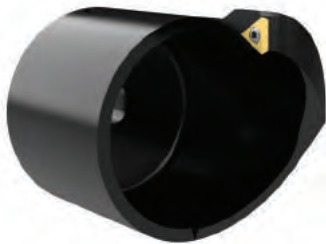

Type B Insert Holders

	Boring Range		Insert Holder			Weight	Type	Insert Form	Part No.
	A	X ₁	L ₁	W					
m	29.00 - 44.00	75.50	54.00	9.60	0.30 (kg)	B	20*	236083	
	43.00 - 66.00	100.50	79.00	9.60	0.40 (kg)	B	20*	236084	

NOTE: Clockwise and neutral execution

*Not suitable for indexable inserts with a radius of 0.80 mm

Clamping Pieces for Outside Turning Insert Holders

Insert Holder Type	Boring Range	Service Key	Complete Part No.
A	4.00 - 30.00	s5	236088
B	29.00 - 66.00	s5	236089

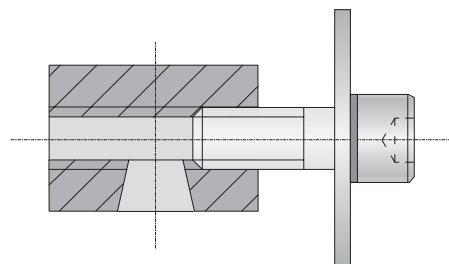

Key on B10-A-1

B10-M: 12-13

B10-A: 18

B10-H

B10: VI-VII

m = Metric (mm)
Inserts sold separately

Outside Turning Serrated Slides | Insert Holders

Diameter Range: 2.00 mm - 58.00 mm

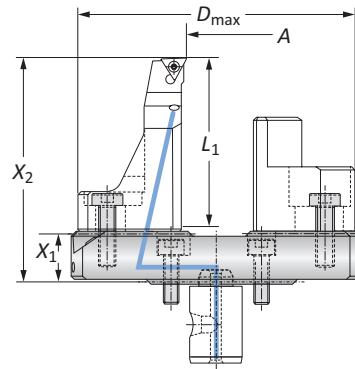

Serrated Slides

	Outside Turning Range	Serrated Slide			Weight	Interfering Diameter	Part No.
	A	X ₁	X ₂	L ₁		D _{max}	
Ⓜ	2.00 - 30.00	16.00	73.00	55.00	0.35 (kg)	101.00	501064
	30.00 - 58.00	16.00	73.00	55.00	0.44 (kg)	129.00	501065



Insert Holder

	Boring Range	Insert Holder	Weight	Insert Form	Part No.
	A	X ₁			
Ⓜ	2.00 - 58.00	57.00	0.15 (kg)	20*	502082

*Clockwise and neutral execution

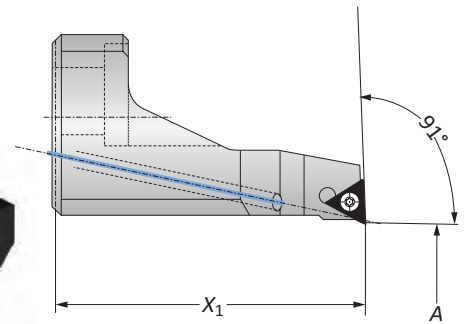

Counterweight

	Counterweight	Weight	Part No.
	X ₁		
Ⓜ	37.75	0.16 (kg)	502183

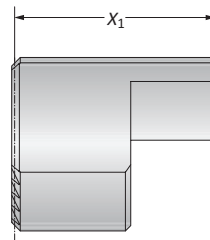

Alu-Line Coolant Delivery Section

	Coolant Delivery Section	Weight	Part No.
	X ₁		
Ⓜ	25.50	0.01 (kg)	450137

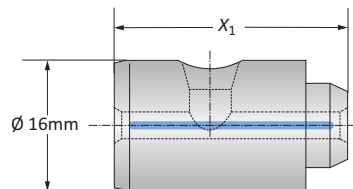

B10-M: 12-13

B10-A: 18

B10-H

B10: VI-VII

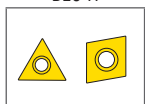
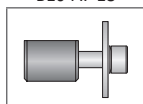
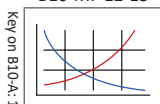

Ⓜ = Metric (mm)
Inserts sold separately