

Mini



CVD diamant et PCD avec brise copeaux 3D HORN

Les porte-outils correspondants
se trouvent dans le catalogue
SUPERMINI & MINI

Diamante CVD e riporto PCD con rompitruciolo 3D HORN

Per i Portainseriti prego vedere il
nostro catalogo SUPERMINI & MINI

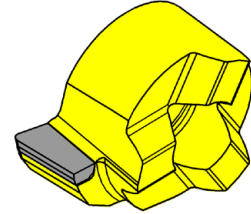
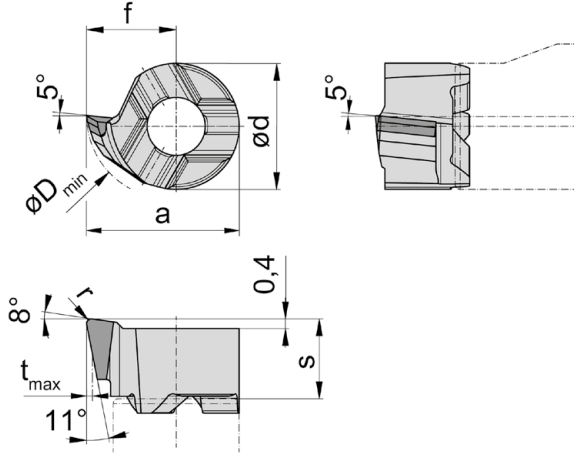
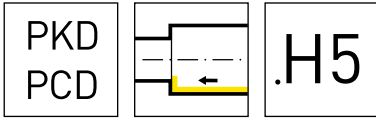

R = version à droite représentée
R = versione destra come in figura

Nuance
Leghe
▲ en stock Δ 4 semaines
a stock 4 settimane

N° de commande Codice prodotto	s	f	a	r	d	t _{max}	D _{min}	HIS	PD75
R107.1002.1.H5.P	3,3	3,7	6,3	0,2	5,2	0,3	6,8	107052R	▲
R107.1004.1.H5.P	3,3	3,7	6,3	0,4	5,2	0,3	6,8	107052R	▲
									P -
									M -
									K -
									N ●
									S -
									H -

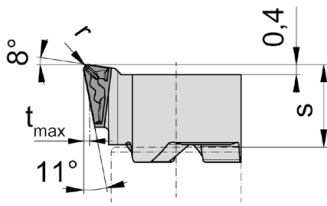
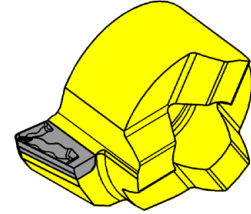
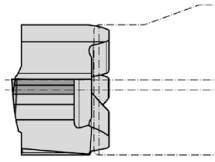
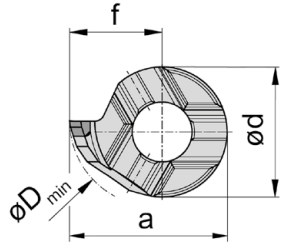
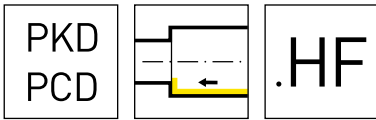

R = version à droite représentée
R = versione destra come in figura

Nuance
Leghe
▲ en stock Δ 4 semaines
a stock 4 settimane

N° de commande Codice prodotto	s	f	a	r	d	t _{max}	D _{min}	HIS	PD75
R107.1002.1.HF.P	3,3	3,7	6,3	0,2	5,2	0,3	6,8	107052R	▲
									P -
									M -
									K -
									N ●
									S -
									H -

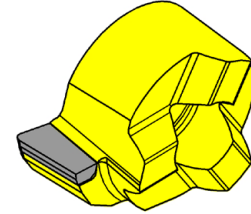
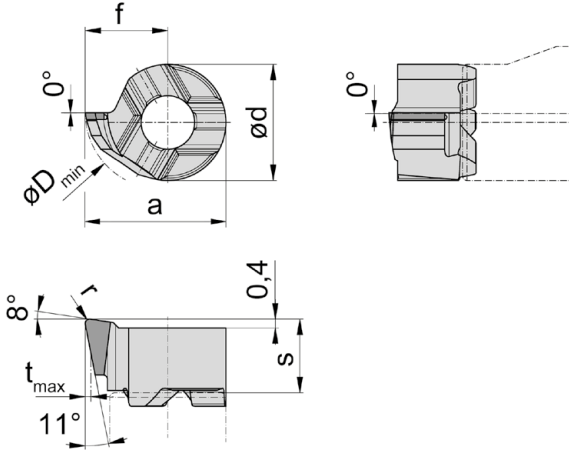
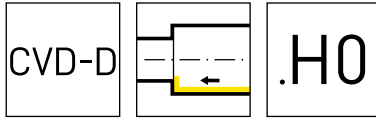

R = version à droite représentée
R = versione destra come in figura

Nuance
Leghe
▲ en stock
a stock
Δ 4 semaines
4 settimane

N° de commande Codice prodotto	s	f	a	r	d	t _{max}	D _{min}	HIS	HD03
R107.1002.1.H0.C	3,3	3,7	6,3	0,2	5,2	0,3	6,8	107052R	▲
R107.1004.1.H0.C	3,3	3,7	6,3	0,4	5,2	0,3	6,8	107052R	▲
									P -
									M -
									K -
									N ●
									S -
									H -

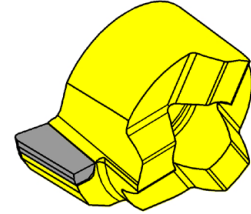
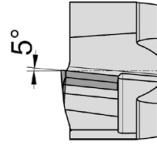
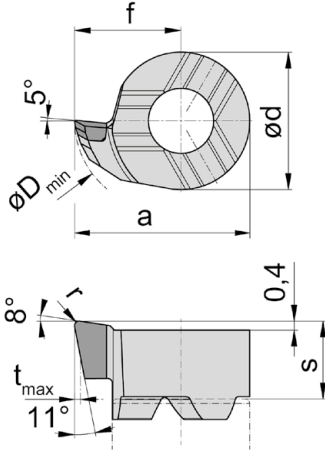
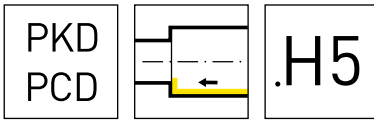

R = version à droite représentée
R = versione destra come in figura

Nuance
Leghe
▲ en stock
a stock
Δ 4 semaines
4 settimane

N° de commande Codice prodotto	s	f	a	r	d	t _{max}	D _{min}	HIS	PD75
R108.1002.H5.P	3,4	4,65	7,65	0,2	6	0,3	7,8	306060R	▲
R108.1004.H5.P	3,4	4,65	7,65	0,4	6	0,3	7,8	306060R	▲
									P -
									M -
									K -
									N ●
									S -
									H -

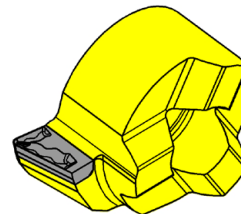
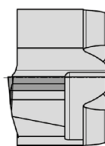
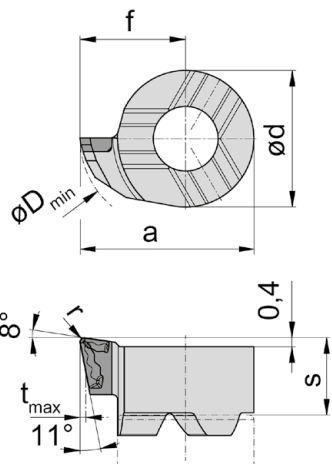
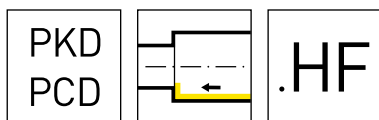

R = version à droite représentée

R = versione destra come in figura

Nuance
Leghe

▲ en stock
a stock

Δ 4 semaines
4 settimane

N° de commande Codice prodotto	s	f	a	r	d	t _{max}	D _{min}	HIS	PD75
R108.1002.HF.P	3,4	4,65	7,65	0,2	6	0,3	7,8	306060R	▲
R108.1004.HF.P	3,4	4,65	7,65	0,4	6	0,3	7,8	306060R	▲
									P -
									M -
									K -
									N ●
									S -
									H -

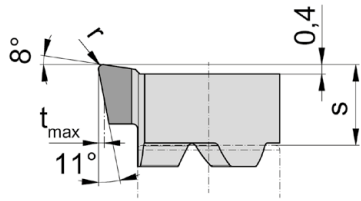
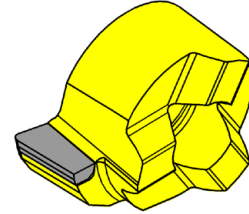
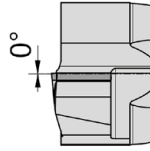
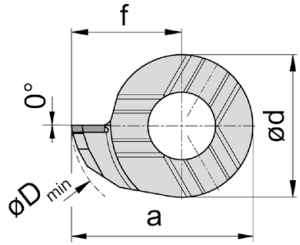
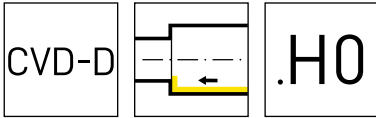

R = version à droite représentée
R = versione destra come in figura

Nuance
Leghe
▲ en stock Δ 4 semaines
a stock 4 settimane

N° de commande Codice prodotto	s	f	a	r	d	t _{max}	D _{min}	HIS	HD03
R108.1002.H0.C	3,4	4,65	7,65	0,2	6	0,3	7,8	306060R	▲
R108.1004.H0.C	3,4	4,65	7,65	0,4	6	0,3	7,8	306060R	▲
									P -
									M -
									K -
									N ●
									S -
									H -

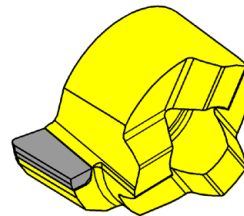
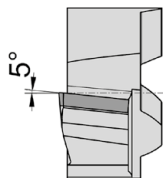
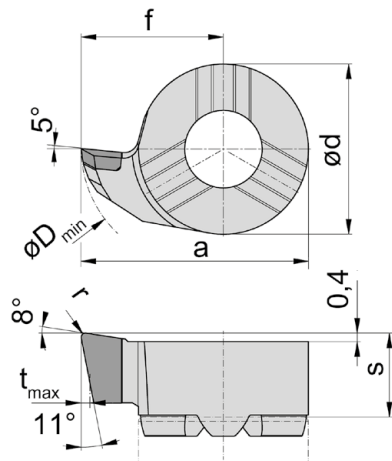
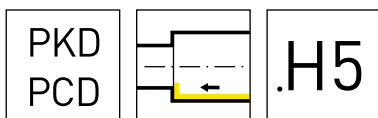

R = version à droite représentée

R = versione destra come in figura

Nuance

Leghe

▲ en stock
a stock

Δ 4 semaines
4 settimane

N° de commande Codice prodotto	s	f	a	r	d	t _{max}	D _{min}	HIS	PD75
R111.1002.H5.P	3,95	6,7	10,7	0,2	8	0,4	11	308080R	▲
R111.1004.H5.P	3,95	6,7	10,7	0,4	8	0,4	11	308080R	▲
									P -
									M -
									K -
									N ●
									S -
									H -

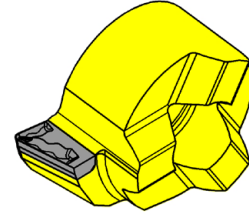
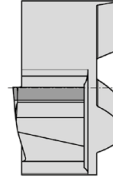
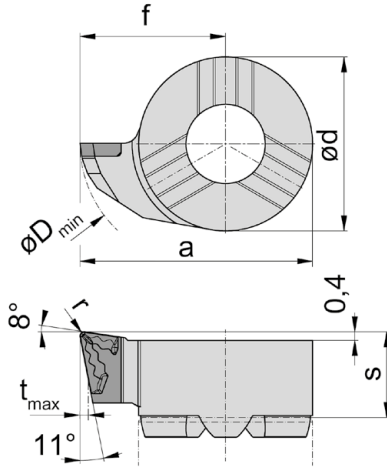
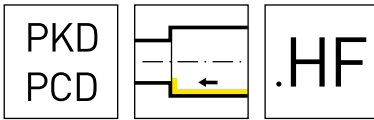

R = version à droite représentée
R = versione destra come in figura

Nuance
Leghe
▲ en stock
a stock
Δ 4 semaines
4 settimane

N° de commande Codice prodotto	s	f	a	r	d	t _{max}	D _{min}	HIS	PD75
R111.1002.HF.P	3,95	6,7	10,7	0,2	8	0,4	11	308080R	▲
R111.1004.HF.P	3,95	6,7	10,7	0,4	8	0,4	11	308080R	▲
									P -
									M -
									K -
									N ●
									S -
									H -

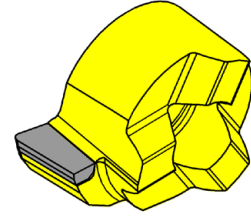
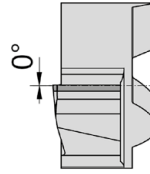
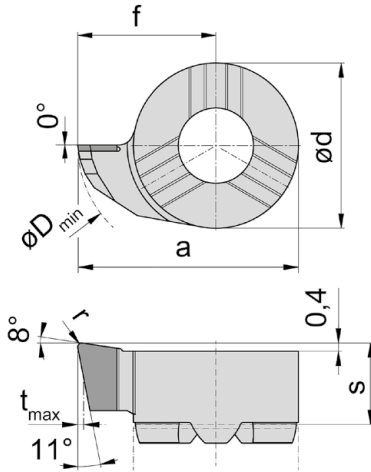
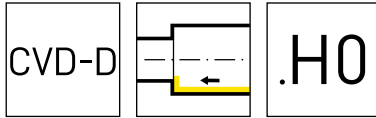

R = version à droite représentée
R = versione destra come in figura

▲ en stock
a stock

Nuance
Leghe
Δ 4 semaines
4 settimane

N° de commande Codice prodotto	s	f	a	r	d	t _{max}	D _{min}	HIS	HD03
R111.1002.H0.C	3,95	6,7	10,7	0,2	8	0,4	11	308080R	▲
R111.1004.H0.C	3,95	6,7	10,7	0,4	8	0,4	11	308080R	▲
									P -
									M -
									K -
									N ●
									S -
									H -

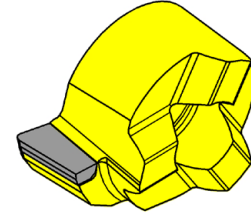
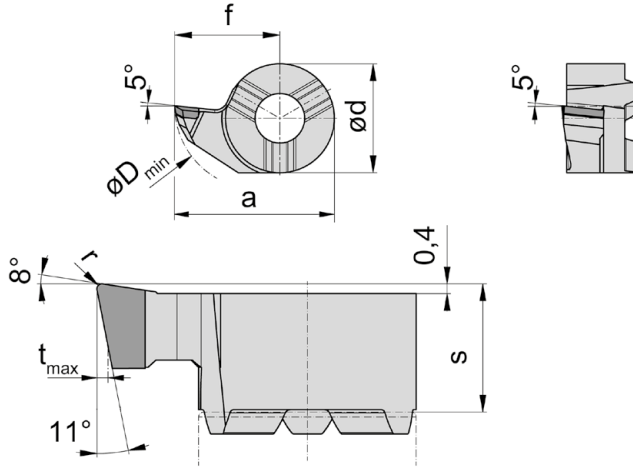
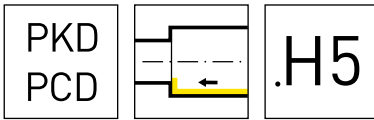

R = version à droite représentée
R = versione destra come in figura

Nuance
Leghe
▲ en stock
a stock
Δ 4 semaines
4 settimane

N° de commande Codice prodotto	s	f	a	r	d	t _{max}	D _{min}	HIS	PD75
R114.1002.H5.P	5,3	8,7	13,2	0,2	9	0,4	13,8	311090R	▲
R114.1004.H5.P	5,3	8,7	13,2	0,4	9	0,4	13,8	311090R	▲
R114.1008.H5.P	5,3	8,7	13,2	0,8	9	0,4	13,8	311090R	▲
									P -
									M -
									K -
									N ●
									S -
									H -

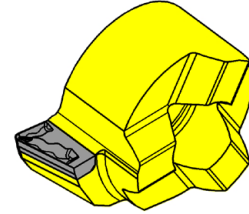
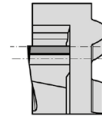
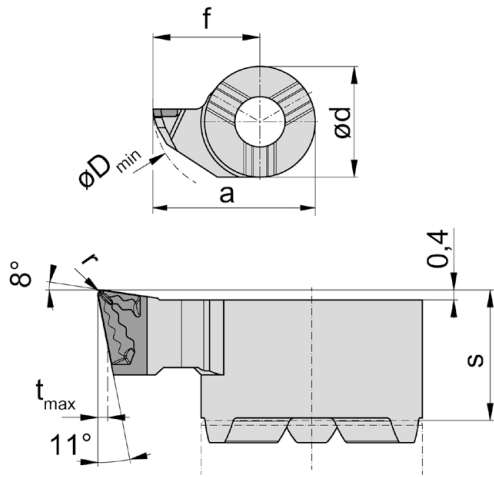
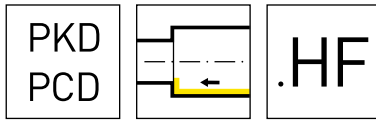

R = version à droite représentée
R = versione destra come in figura

▲ en stock
a stock

Nuance
Leghe
Δ 4 semaines
4 settimane

N° de commande Codice prodotto	s	f	a	r	d	t _{max}	D _{min}	HIS	PD75
R114.1002.HF.P	5,3	8,7	13,2	0,2	9	0,4	13,8	311090R	▲
R114.1004.HF.P	5,3	8,7	13,2	0,4	9	0,4	13,8	311090R	▲
R114.1008.HF.P	5,3	8,7	13,2	0,8	9	0,4	13,8	311090R	▲
									P -
									M -
									K -
									N ●
									S -
									H -

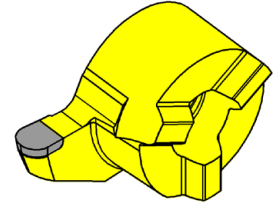
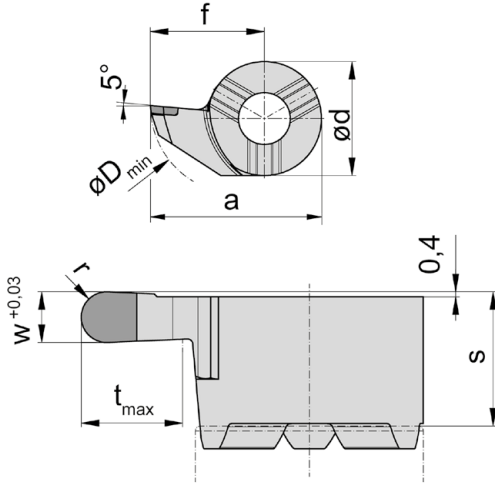
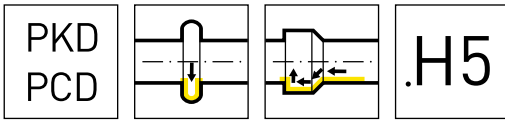

R = version à droite représentée
R = versione destra come in figura

Nuance
Leghe
▲ en stock
a stock
Δ 4 semaines
4 settimane

N° de commande Codice prodotto	w	s	f	a	r	d	t _{max}	D _{min}	HIS	PD75
R114.VR20.H5.P	2	5,3	9	13,5	1	9	4	14	311090R	▲
R114.VR30.H5.P	3	5,3	9	13,5	1,5	9	4	14	311090R	▲
										P -
										M -
										K -
										N ●
										S -
										H -

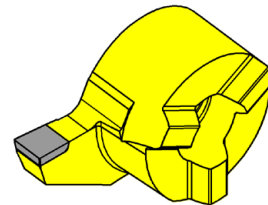
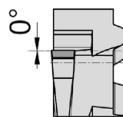
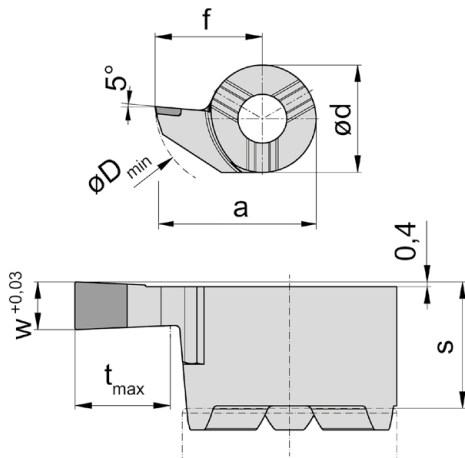
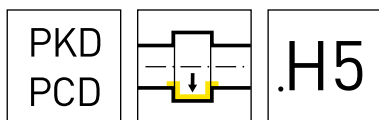

Nuance
Leghe

R = version à droite représentée

R = versione destra come in figura

▲ en stock
a stock

Δ 4 semaines
4 settimane

N° de commande Codice prodotto	w	s	f	a	d	t _{max}	D _{min}	HIS	PD75
R114.0100.H5.P	1	5,3	9	13,5	9	4	14	311090R	▲
R114.0200.H5.P	2	5,3	9	13,5	9	4	14	311090R	▲
R114.0300.H5.P	3	5,3	9	13,5	9	4	14	311090R	▲
									P -
									M -
									K -
									N ●
									S -
									H -

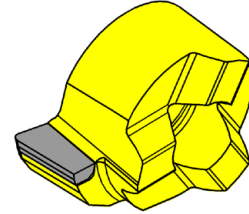
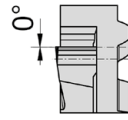
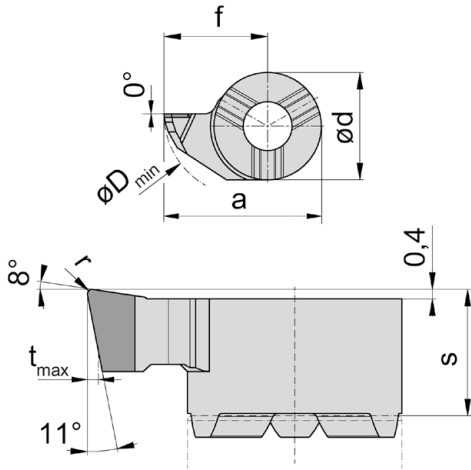
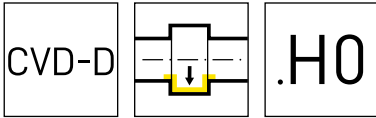

R = version à droite représentée
R = versione destra come in figura

Nuance
Leghe
▲ en stock Δ 4 semaines
a stock 4 settimane

N° de commande Codice prodotto	s	f	a	r	d	t _{max}	D _{min}	HIS	HD03
R114.1002.H0.C	5,3	8,7	13,2	0,2	9	0,4	13,8	311090R	▲
R114.1004.H0.C	5,3	8,7	13,2	0,4	9	0,4	13,8	311090R	▲
R114.1008.H0.C	5,3	8,7	13,2	0,8	9	0,4	13,8	311090R	▲
									P -
									M -
									K -
									N ●
									S -
									H -

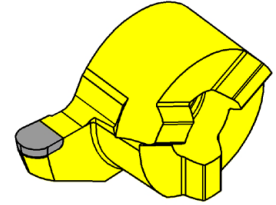
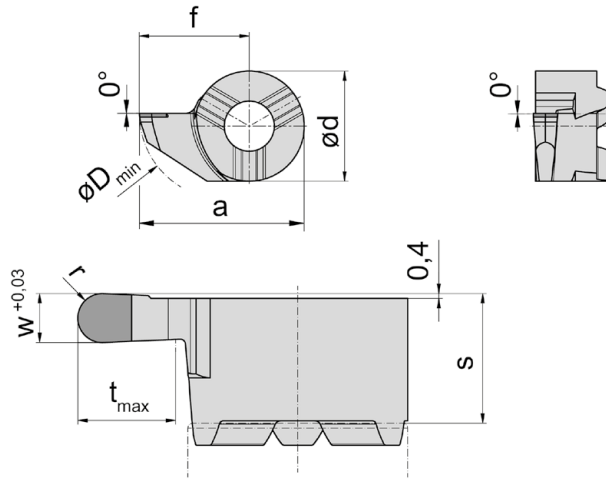
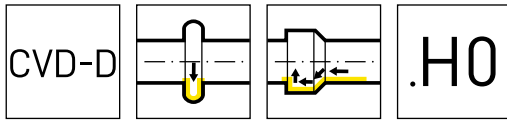

R = version à droite représentée
R = versione destra come in figura

▲ en stock
a stock

Nuance
Leghe
Δ 4 semaines
4 settimane

N° de commande Codice prodotto	w	s	f	a	r	d	t _{max}	D _{min}	HIS	HD03
R114.VR20.H0.C	2	5,3	9	13,5	1	9	4	14	311090R	▲
R114.VR30.H0.C	3	5,3	9	13,5	1,5	9	4	14	311090R	▲
										P -
										M -
										K -
										N ●
										S -
										H -

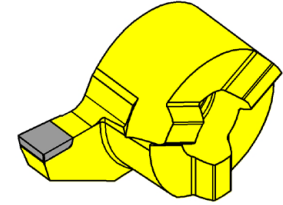
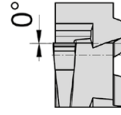
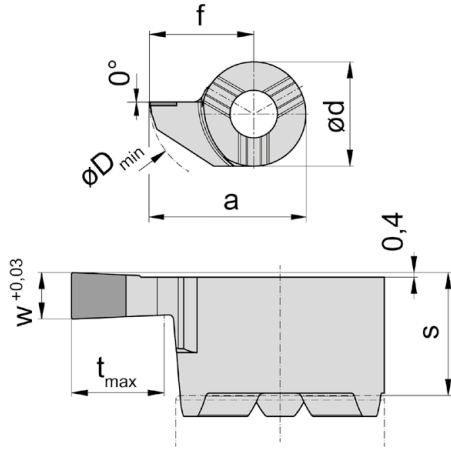
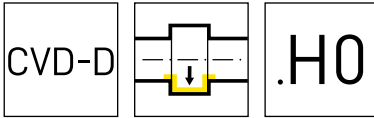

R = version à droite représentée
R = versione destra come in figura

Nuance
Leghe
▲ en stock
a stock
Δ 4 semaines
4 settimane

N° de commande Codice prodotto	w	s	f	a	d	t _{max}	D _{min}	HIS	HD03
R114.0100.H0.C	1	5,3	9	13,5	9	4	14	311090R	▲
R114.0200.H0.C	2	5,3	9	13,5	9	4	14	311090R	▲
R114.0300.H0.C	3	5,3	9	13,5	9	4	14	311090R	▲
									P -
									M -
									K -
									N ●
									S -
									H -

Matière à usiner Materiale da lavorare	Version Versione	Vitesse de coupe v_c Velocità di taglio v_c		Refroidissement recommandé Raffreddamento consigliato
		min	max	
Alliage d'aluminium (brut de fonderie) Ghise pressofuse	.HF	150	4500	Émulsion Emulsione
Alliages d'aluminium allant jusqu'à 12% de Si Leghe di alluminio max. 12% di Si	.HF	100	3500	Émulsion Emulsione
Alliages d'aluminium avec un contenu de Si compris entre 12-20% Leghe di alluminio con Si 12-20%	.HF	80	1500	Émulsion Emulsione
Magnésium Magnesio	.H5 / .HF	100	4000	Émulsion Emulsione
Cuivre, bronze, laiton sans plomb Rame, bronzo, ottone senza piombo	.H5 / .HF	90	1600	Huile Olio
Cuivre OFHC, Tungstène cuivre Rame OFHC, Tungsteno rame	.H5	50	800	Huile Olio
Zinc, Laiton (MS58) Zinco, Ottone (MS58)	.H5 / .HF	100	1800	Huile Oliol
Nickel argent, Alliages cuivre-nickel Nichel argento, Leghe di rame-nichel	.H5	80	450	Émulsion Emulsione
Titane, molybdène, platine, iridium Titanio, molibdeno, platino, iridio	.H5	40	250	Emulsion Emulsion
Graphite Grafite	.H0	50	1000	Air Aria
Carbure et céramique, fritté Metallo duro e ceramico, sinterizzato	.H0	25	80	Air Aria
Carbure et céramique, pré-fritté Metallo duro e ceramico, presinterizzato	.H0	40	100	Air Aria
Synthétiques, plastique renforcé Sintetici, materiali plastici	.H5	120	1700	Air Aria
Plastique renforcé de fibre GFRP	.H5 / .H0	100	500	Air Aria
CFK Plastiche rinforzate	.H5 / .H0	80	300	Air Aria

Géométrie .HF Geometria

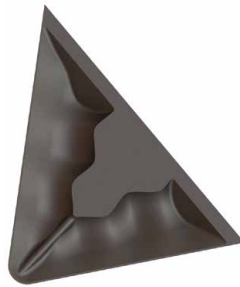

usinage d'alésage barenatura

Matière à usiner Materiale da lavorare	Rayon d'angles Spigolo raggiato [mm]	Brise copeaux HORN 3D Rompitruciolo HORN 3D .HF			
		Profondeur de passe a_p [mm] Profondità di passata a_p [mm]		Avances f [mm/trs] Avanzamento f [mm/giro]	
		min	max	min	max
Aluminium, Alliage d'Aluminium forgé Alluminio, Alluminio e sue leghe	0,2	0,05	1,1	0,05	0,10
	0,4	0,07	1,2	0,06	0,15
Laiton sans plomb Ottone senza piombo	0,2	0,05	1,0	0,05	0,10
	0,4	0,1	1,2	0,08	0,15

S'il vous plaît considerer l' a_p par rapport à l'angle d'approche du porte outil.
Attenzione, considerare l' a_p in relazione all'angolo d'impostazione del portainsero.

La spécification D_{min} peut être affectée par les propriétés du matériau.
Il D_{min} specifico può variare a seconda del materiale che si lavora.

Fraise à moyeu
Fresa a manicotto
DTM

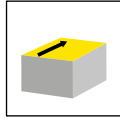

Page/Pag.
114, 116, 120



Page/Pag.
115

Plaquette
Inserto
DTS



Page/Pag.
117, 121

Adapteur
Adattatore

Page/Pag.
122-123