

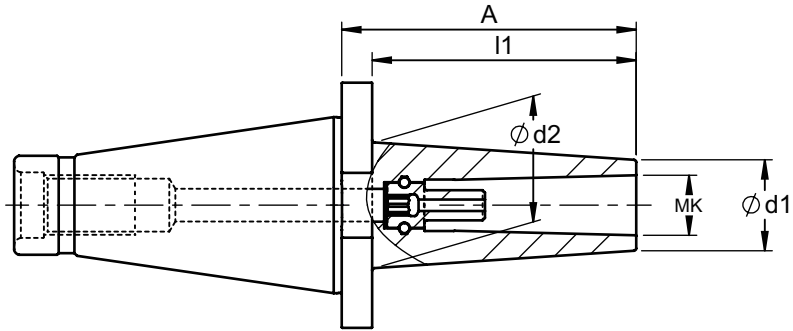



**Fräserhülsen SK50  
mit Anzugsgewinde für Morsekegel, DIN 2080**

morse taper adaptor SK50



Bestell-Nr. order number	MK	d1	d2	l1	A				
909 - 50 MK260	MK 2	30	35	44,8	60	959-MK2	957-MK2	952-MK2	
909 - 50 MK2110	MK 2	30	40	94,8	110	959-MK2	957-MK2	952-MK2	
<b>909 - 50 MK2160</b>	<b>MK 2</b>	<b>30</b>	<b>45</b>	<b>144,8</b>	<b>160</b>	<b>959-MK2</b>	<b>957-MK2</b>	<b>952-MK2</b>	
909 - 50 MK3170	MK 3	36	60	154,8	170	959-MK3	957-MK3	952-MK3	
909 - 50 MK3220	MK 3	36	70	204,8	220	959-MK3	957-MK3	952-MK3	
909 - 50 MK4150	MK 4	44	60	134,8	150	959-MK4	957-MK4	952-MK4	
909 - 50 MK5120	MK 5	56	70	104,8	120	959-MK5	957-MK5	952-MK5	
909 - 50 MK5170	MK 5	56	70	154,8	170	959-MK5	957-MK5	952-MK5	
909 - 50 MK5220	MK 5	56	75	204,8	220	959-MK5	957-MK5	952-MK5	

**Werkzeugaufnahmen BT**

Tool holders BT

**Seite  
Page**

Fräsaufnahmen für Einschraubfräser  
Modular screw on holder

139 - 143

Fräsdorne  
Arbors for shell cutters

144 - 145

Fräserhülsen / Zwischenhülsen  
Morse taper adaptors

146 - 147

Spannzangenfutter  
Collet chucks

148 - 149

CNC-Bohrfutter  
CNC-drill chucks

151

Rohlinge  
Blanks

152

Andere Ausführungen und Längen auf Anfrage lieferbar.  
Specials on request.

## Fräsaufnahme BT30 für Einschraubfräser

modular screw on holder BT30

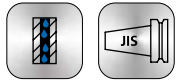
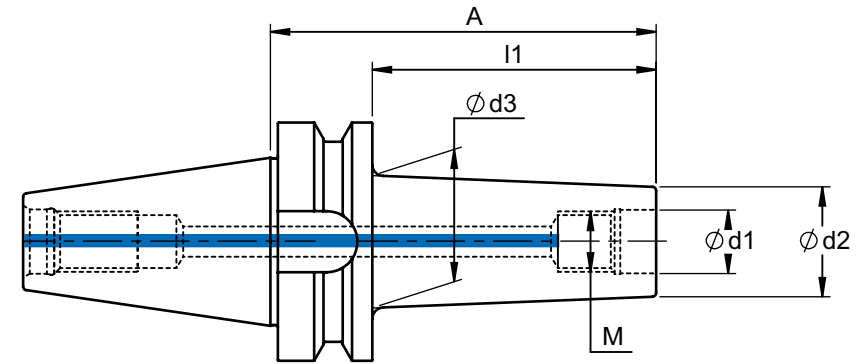

JIS B6339  
MAS403BT

Bestell-Nr. order number	M	d1	d2	d3	A	l1	
962 - BT300825	M8	8,5	14	18	47	25	G6,3/10.000
962 - BT300850	M8	8,5	14	23	72	50	
962 - BT301025	M10	10,5	18	23	47	25	
962 - BT301050	M10	10,5	18	27	72	50	
962 - BT301225	M12	12,5	21	25	47	25	
962 - BT301250	M12	12,5	21	31	72	50	
962 - BT301625	M16	17	29	29	47	25	
962 - BT301650	M16	17	29	34	47	50	

## Fräsaufnahme BT40 für Einschraubfräser

modular screw on holder BT40

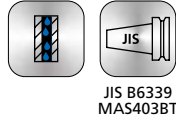
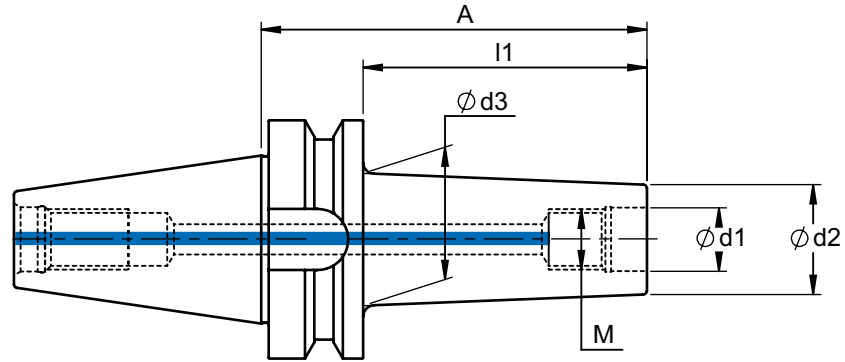

JIS B6339  
MAS403BT

Bestell-Nr. order number	M	d1	d2	d3	A	l1	
962 - 0625BT	M6	6,5	10	17	52	25	G6,3/10.000
962 - 0625BTZY	M6	6,5	10	10	52	25	
962 - 0650BT	M6	6,5	10	23	77	50	
962 - 0675BT	M6	6,5	10	25	102	75	
962 - 0825BT	M8	8,5	13,8	18	52	25	
962 - 0825BTZY	M8	8,5	13,8	13,8	52	25	
962 - 0850BT	M8	8,5	13,8	23	77	50	
962 - 0850BTZY	M8	8,5	13,8	13,8	77	50	
962 - 0875BT	M8	8,5	13,8	25	102	75	
962 - 0875BTZY	M8	8,5	13,8	13,8	102	75	
962 - 08100BT	M8	8,5	13,8	30	127	100	
962 - 08125BT	M8	8,5	13,8	34	152	125	
962 - 1025BT	M10	10,5	18	23	52	25	
962 - 1025BTZY	M10	10,5	18	18	52	25	
962 - 1050BT	M10	10,5	18	25	77	50	
962 - 1050BTZY	M10	10,5	18	18	77	50	
962 - 1075BT	M10	10,5	18	30	102	75	
962 - 1075BTZY	M10	10,5	18	18	102	75	
962 - 10100BT	M10	10,5	18	35	127	100	
962 - 10100BTZY	M10	10,5	18	18	127	100	
962 - 10125BT	M10	10,5	18	40	152	125	
962 - 10150BT	M10	10,5	18	45	177	150	

## Fräsaufnahme BT40 für Einschraubfräser

modular screw on holder BT40

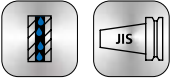
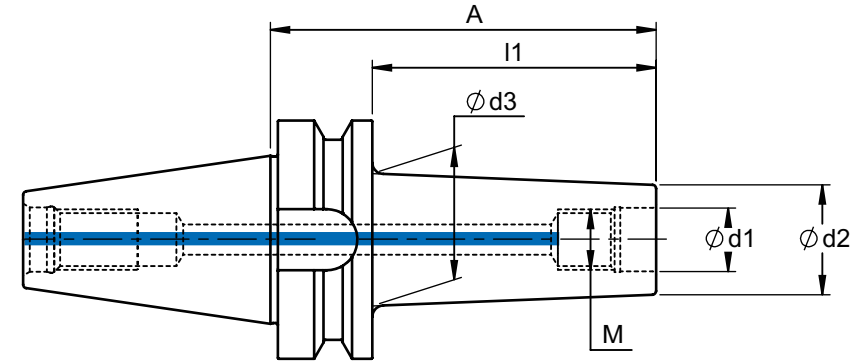

JIS B6339  
MAS403BT

Bestell-Nr. order number	M	d1	d2	d3	A	l1	
962 - 1225BT	M12	12,5	21	24	52	25	G6,3/10.000
962 - 1250BT	M12	12,5	21	30	77	50	
962 - 1250BTZY	M12	12,5	22	22	77	50	
962 - 1275BT	M12	12,5	21	35	102	75	
962 - 1275BTZY	M12	12,5	22	22	102	75	
962 - 12100BT	M12	12,5	21	38	127	100	
962 - 12100BTZY	M12	12,5	22	22	127	100	
962 - 12125BT	M12	12,5	21	43	152	125	
962 - 12150BT	M12	12,5	21	45	177	150	
962 - 1625BT	M16	17	29	29	52	25	
962 - 1650BT	M16	17	29	34	77	50	
962 - 1650BTZY	M16	17	29	29	77	50	
962 - 1675BT	M16	17	29	35	102	75	
962 - 1675BTZY	M16	17	29	29	102	75	
962 - 16100BT	M16	17	29	40	127	100	
962 - 16100BTZY	M16	17	29	29	127	100	
962 - 16125BT	M16	17	29	44	152	125	
962 - 16125BTZY	M16	17	29	29	152	125	
962 - 16150BT	M16	17	29	45	177	150	
962 - 16175BT	M16	17	29	50	202	175	
962 - 16200BT	M16	17	29	50	227	200	
962 - 16225BT	M16	17	29	50	252	225	
962 - 16250BT	M16	17	29	50	277	250	

# Fräsaufnahme BT50 für Einschraubfräser

modular screw on holder BT50

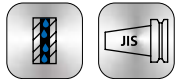
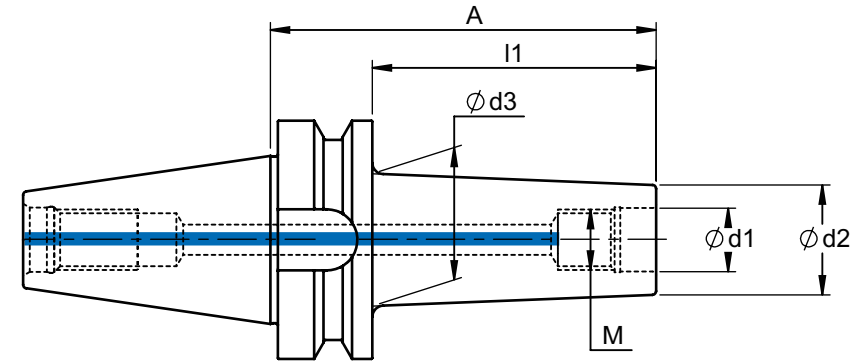

JIS B6339  
MAS403BT

Bestell-Nr. order number	M	d1	d2	d3	A	l1	
963 - 0850BT	M8	8,5	13,8	23	88	50	G6,3/8.000
963 - 08100BT	M8	8,5	13,8	30	138	100	
963 - 08150BT	M8	8,5	13,8	35	188	150	
963 - 1050BT	M10	10,5	18	25	88	50	
963 - 10100BT	M10	10,5	18	35	138	100	
963 - 10150BT	M10	10,5	18	38	188	150	
963 - 1250BT	M12	12,5	21	34	88	50	
963 - 1250BTZY	M12	12,5	22	22	88	50	
963 - 1275BT	M12	12,5	21	37	113	75	
963 - 1275BTZY	M12	12,5	22	22	113	75	
963 - 12100BT	M12	12,5	21	41	138	100	
963 - 12100BTZY	M12	12,5	22	22	138	100	
963 - 12150BT	M12	12,5	21	50	188	150	
963 - 12200BT	M12	12,5	21	57	238	200	
963 - 12250BT	M12	12,5	21	62	288	250	
963 - 12300BT	M12	12,5	21	67	338	300	
963 - 1650BT	M16	17	29	35	88	50	
963 - 1650BTZY	M16	17	29	29	88	50	
963 - 1675BT	M16	17	29	37	113	75	
963 - 1675BTZY	M16	17	29	29	113	75	
963 - 16100BT	M16	17	29	41	138	100	
963 - 16100BTZY	M16	17	29	29	138	100	
963 - 16150BT	M16	17	29	50	188	150	
963 - 16150BTZY	M16	17	29	29	188	150	
963 - 16200BT	M16	17	29	57	238	200	
963 - 16200BTZY	M16	17	29	29	238	200	
963 - 16250BT	M16	17	29	62	288	250	
963 - 16300BT	M16	17	29	67	338	300	

## Fräsdorne BT40

arbors BT40 for shell cutter

Lieferumfang: BT-Aufnahme mit Anzugsschraube und Mitnehmersteinen  
 delivery: with drive keys and retaining screw

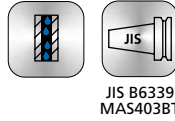
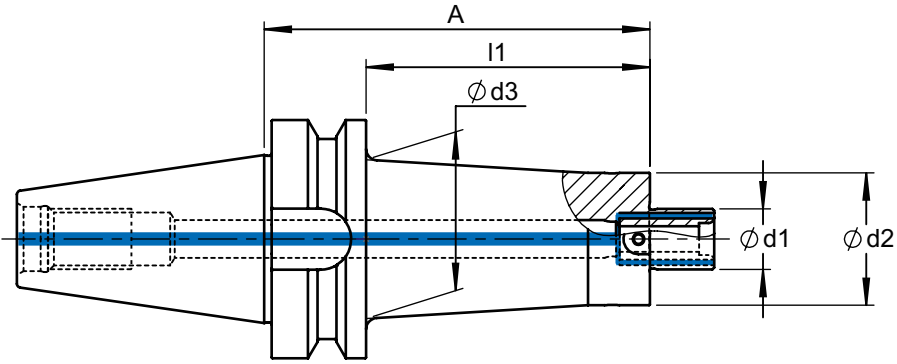

JIS B6339  
MAS403BT

Bestell-Nr. order number	d1	d2	d3	l1	A					
972-BT401625	16	35	35	25	52	x	959-16	-	957-M8	-
972-BT401650	16	35	42	50	77	x	959-16	-	957-M8	-
972-BT401675	16	35	45	75	102	x	959-16	-	957-M8	-
972-BT4016100	16	35	50	100	127	x	959-16	-	957-M8	-
972-BT4016150	16	35	50	150	177	x	959-16	-	957-M8	-
972-BT4016200	16	35	50	200	227	x	959-16	-	957-M8	-
972-BT402225	22	40	40	25	52	x	959-22	-	957-M10	-
972-BT402250	22	40	45	50	77	x	959-22	-	957-M10	-
972-BT402275	22	40	50	75	102	x	959-22	-	957-M10	-
972-BT4022100	22	40	50	100	127	x	959-22	-	957-M10	-
972-BT4022150	22	40	50	150	177	x	959-22	-	957-M10	-
972-BT4022200	22	40	50	200	227	x	959-22	-	957-M10	-
972-BT402725	27	45	45	25	52	x	959-27	-	957-M12	-
972-BT402750	27	45	45	50	77	x	959-27	-	957-M12	-
972-BT402775	27	45	45	75	102	x	959-27	-	957-M12	-
972-BT4027100	27	45	45	100	127	x	959-27	-	957-M12	-

G6,3/8.000

## Fräsdorne BT50

arbors BT50 for shell cutter

Lieferumfang: BT-Aufnahme mit Anzugsschraube und Mitnehmersteinen  
 delivery: with drive keys and retaining screw

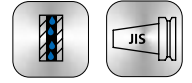
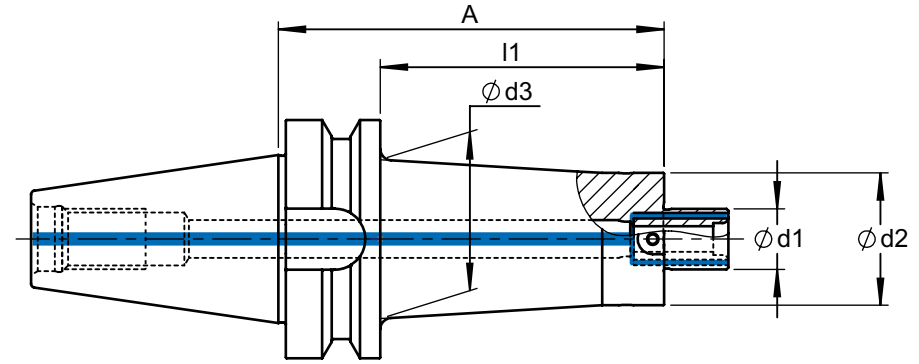

JIS B6339  
MAS403BT



Bestell-Nr. order number	d1	d2	d3	l1	A					
972-BT501650	16	35	40	50	88	x	959-16	-	957-M8	-
972-BT5016100	16	35	50	100	138	x	959-16	-	957-M8	-
972-BT5016150	16	35	53	150	188	-	959-16	-	957-M8	-
972-BT5016200	16	35	60	200	238	-	959-16	-	957-M8	-
972-BT502250	22	40	40	50	88	x	959-22	-	957-M10	-
972-BT5022100	22	40	50	100	138	x	959-22	-	957-M10	-
972-BT5022150	22	40	62	150	188	-	959-22	-	957-M10	-
972-BT5022200	22	40	68	200	238	-	959-22	-	957-M10	-
972-BT502720	27	60	60	20	58	x	959-27	-	957-M12	-
972-BT502750	27	60	60	50	88	x	959-27	-	957-M12	-
972-BT5027100	27	60	70	100	138	x	959-27	-	957-M12	-
972-BT5027150	27	60	78	150	188	-	959-27	-	957-M12	-
972-BT5027200	27	60	78	200	238	-	959-27	-	957-M12	-
972-BT503250	32	70	70	50	88	-	959-32	957-32	-	958-32
972-BT5032100	32	70	95	100	138	-	959-32	957-32	-	958-32
972-BT5032150	32	70	95	150	188	-	959-32	957-32	-	958-32
972-BT504050	40	95	95	50	88	-	959-40	957-40	-	958-40
972-BT5040100	40	95	95	100	138	-	959-40	957-40	-	958-40

G6,3/8.000

## Fräserhülsen BT40, 50 mit Anzugsgewinde für Morsekegel

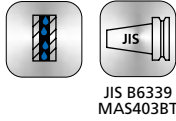
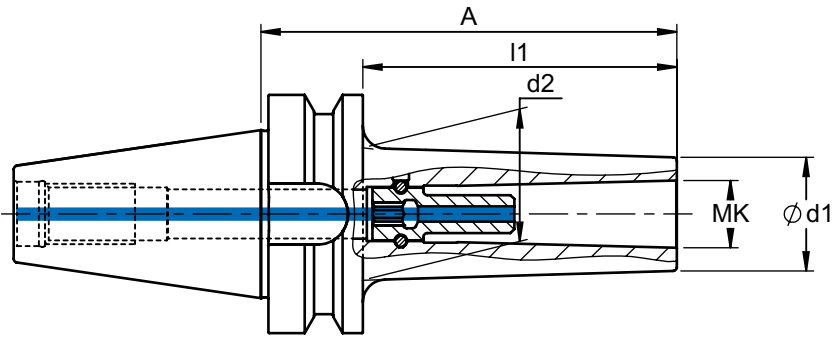
morse taper adaptor BT40, 50

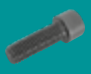

Bestell-Nr. order number	MK	d1	d2	l1	A				
405 - BT50 MK2A60	MK 2	30	35	22	60	957-MK2-SW6	952-SW6-490	G6,3/8.000	
405 - BT50 MK2A110	MK 2	30	40	72	110	957-MK2-SW6	952-SW6-490		
405 - BT50 MK2A160	MK 2	30	45	122	160	957-MK2-SW6	952-SW6-490		
405 - BT50 MK3A65	MK 3	36	43	27	65	957-MK3-SW7	952-SW7-450		
405 - BT50 MK3A120	MK 3	36	50	82	120	957-MK3-SW7	952-SW7-450		
405 - BT50 MK3A170	MK 3	36	60	132	170	957-MK3-SW7	952-SW7-450		
405 - BT50 MK3A220	MK 3	36	70	182	220	957-MK3-SW7	952-SW7-450		
405 - BT50 MK4A100	MK 4	44	55	62	100	957-MK4-SW8	952-SW8-450		
405 - BT50 MK4A150	MK 4	44	60	112	150	957-MK4-SW8	952-SW8-450		
405 - BT50 MK4A200	MK 4	44	70	162	200	957-MK4-SW8	952-SW8-450		
405 - BT50 MK5A120	MK 5	56	70	82	120	957-MK5-SW10	952-SW10-355		
405 - BT50 MK5A170	MK 5	56	70	132	170	957-MK5-SW10	952-SW10-355		
405 - BT50 MK5A220	MK 5	56	75	182	220	957-MK5-SW10	952-SW10-355		

## Zwischenhülsen BT40, 50

morse taper adaptor BT40, 50

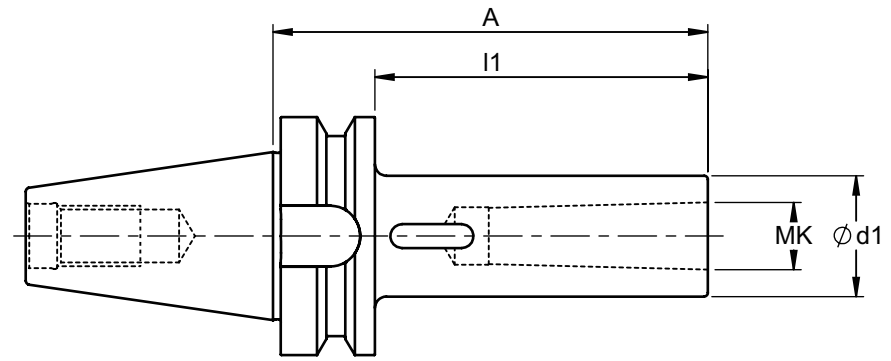

Bestell-Nr. order number	MAS	MK	d1	l1	A	
906 - BT40MK150	BT40	MK1	25	23	50	G6,3/8.000
906 - BT40MK250	BT40	MK2	32	23	50	
906 - BT40MK370	BT40	MK3	40	43	70	
906 - BT40MK495	BT40	MK4	48	68	95	
906 - BT50MK260	BT50	MK2	32	22	60	
906 - BT50MK365	BT50	MK3	40	27	65	
906 - BT50MK495	BT50	MK4	48	57	95	
906 - BT50MK5105	BT50	MK5	63	67	105	

## Spannzangenfutter BT30 - 50 für Spannzangen ER 16/25/32/40 mit Spannmutter UM

collet chucks BT30 - 50 for collets ER 16/25/32/40 with nut type UM

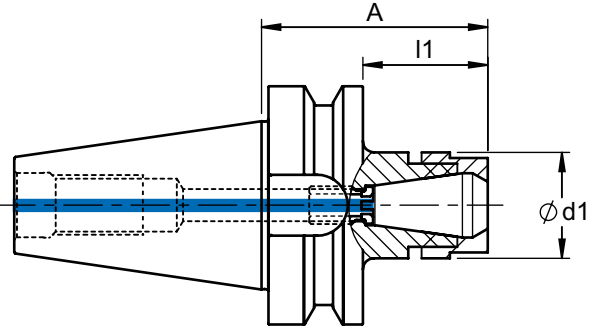

Lieferumfang: BT-Aufnahme mit Spannmutter UM  
delivery: collet chuck with nut UM

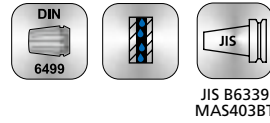

Bestell-Nr. order number	MAS	ER	d1	l1	A				
910 - BT3050	BT30	16	28	28	50	953-UM16	948-M10	954-034	G6,3/8.000
910 - BT3070	BT30	16	28	48	70	953-UM16	948-M10	954-034	
912 - BT3070	BT30	25	42	48	70	953-UM25	948-M12	954-013ER25	
912 - BT4060	BT40	25	42	33	60	953-UM25	948-M12	954-013ER25	
913 - BT4070	BT40	32	50	43	70	953-UM32	948-M16	954-014ER32	
914 - BT4080	BT40	40	63	53	80	953-UM40	948-M16	954-015ER40	
913 - BT5070	BT50	32	50	32	70	953-UM32	948-M16	954-014ER32	
914 - BT5080	BT50	40	63	42	80	953-UM40	948-M16	954-015ER40	

## Spannzangenfutter BT30, 40 für Spannzangen ER 20 mit Spannmutter MS

collet chucks BT30, 40 for collets ER 20 with nut type MS

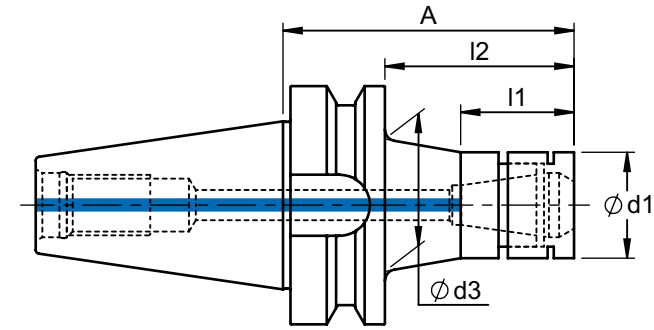

Lieferumfang: BT-Aufnahme mit Spannmutter MS  
delivery: collet chuck with nut MS

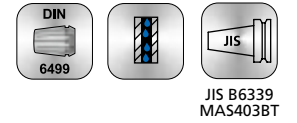

Bestell-Nr. order number	MAS	d1	d3	l1	l2	A			
911 - BT3040	BT30	28	33	30	40	62	953-MS20	954-063E20	G2,5/15.000
911 - BT3080	BT30	28	39	30	80	102	953-MS20	954-063E20	
911 - BT4050	BT40	28	33	30	50	77	953-MS20	954-063E20	oder/or U<1gmm
911 - BT40100	BT40	28	35	30	100	127	953-MS20	954-063E20	
911 - BT40150	BT40	28	36	30	150	177	953-MS20	954-063E20	
911 - BT40200	BT40	28	36	30	200	227	953-MS20	954-063E20	

## CNC- Bohrfutter BT30 - 50 für Rechts- und Linkslauf

CNC- drill chucks BT30 - 50 for clockwise and anti clockwise rotation

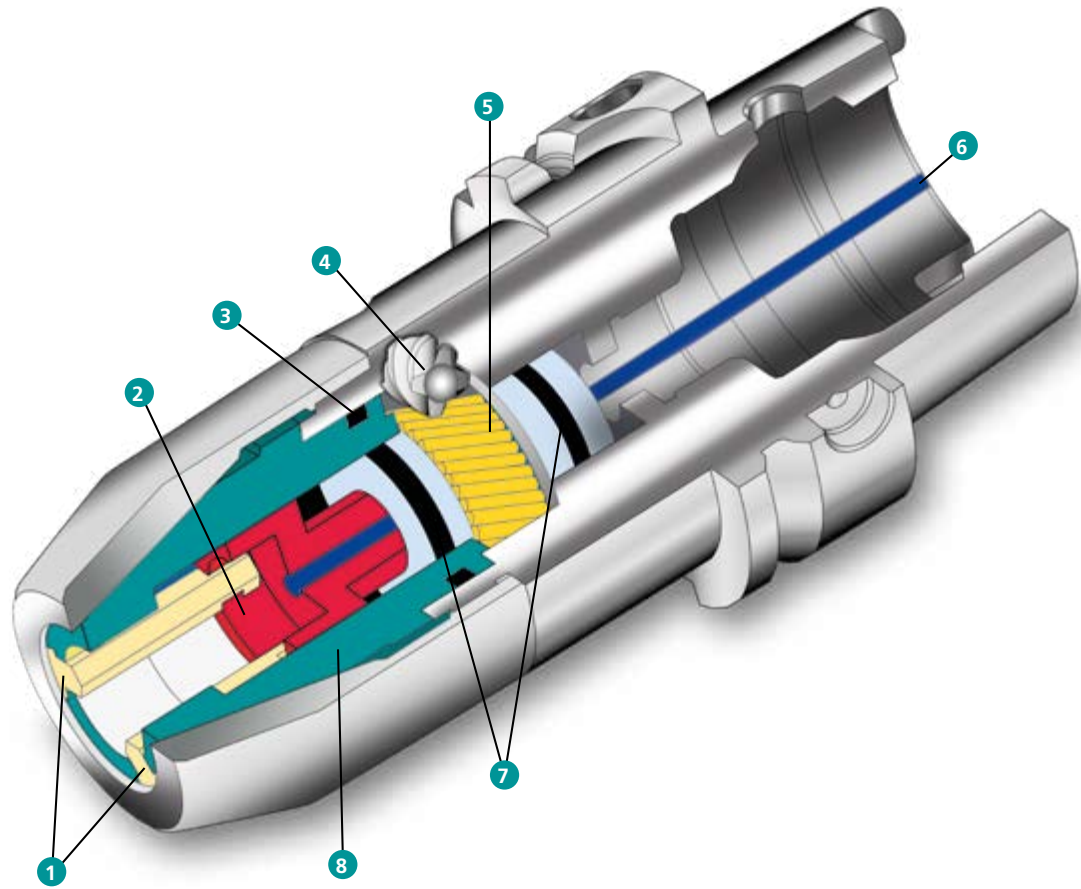

- |                            |                       |
|----------------------------|-----------------------|
| 1 Spannbacken              | 1 Clamping jaws       |
| 2 Backenantrieb            | 2 Jaws driver         |
| 3 Abdichtung Backenführung | 3 Seal for jaws guide |
| 4 Schnecke                 | 4 Worm                |
| 5 Schneckenrad             | 5 Worm gear           |
| 6 IKZ                      | 6 Internal cooling    |
| 7 Abdichtung Getriebe      | 7 Seal for gearbox    |
| 8 Backenführung            | 8 Jaws guide          |

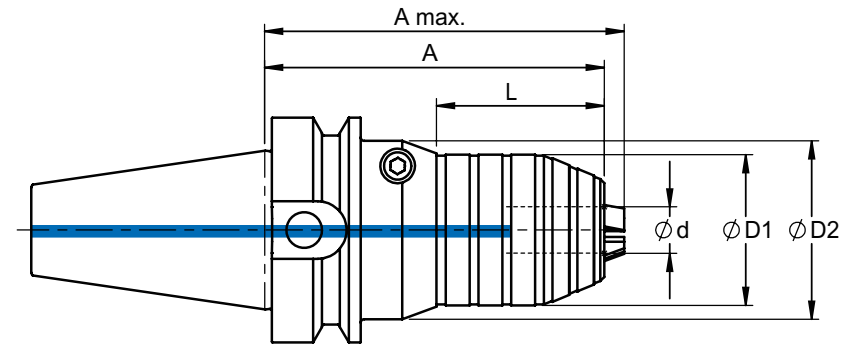

JIS B6339  
MAS403BT

Bestell-Nr. order number	SK	d	D1	D2	L	A	A max.	
407 - BT3008A80	30	0,5 - 8	34,5	45,0	40,0	80,0	82,5	G6,3/8.000
407 - BT4008A85	40	0,5 - 8	34,5	45,0	40,0	85,0	87,5	
407 - BT4013A95	40	1 - 13	42,0	50,0	47,0	95,0	104,0	
407 - BT4016A95	40	2,5 - 16	49,0	50,0	50,0	95,0	106,0	
407 - BT5013A110	50	1 - 13	42,0	50,0	47,0	110,0	119,0	
407 - BT5016A110	50	2,5 - 16	49,0	50,0	50,0	110,0	121,0	



