

M304



**Corps de fraise avec
plaquette interchangeable**

Ø Alésage à partir de 7,7 mm

**Corpo fresa a inserti
intercambiabili**

Foro-Ø da 7,7 mm

B

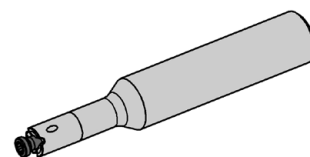
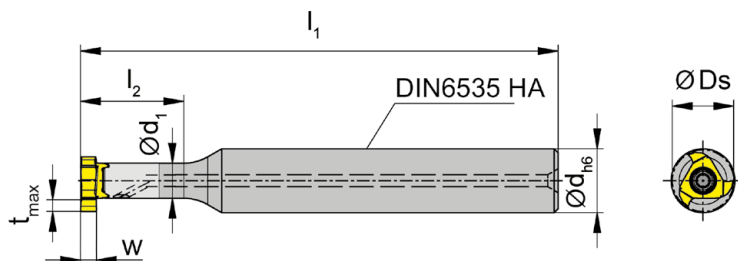
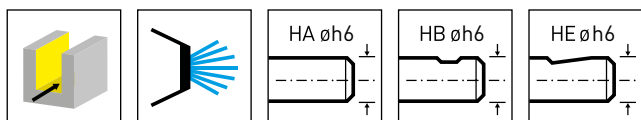

N° de commande Codice prodotto	d	l ₁	l ₂	d ₁	Forme Forma	HWS
M304.0008.01A	8	60	13	4,4	A	304044R
M304.0008.02A	8	64	17	4,4	A	304044R
M304.0008.03A	8	68	21	4,4	A	304044R
M304.0008.01B	8	60	13	4,4	B	304044R
M304.0008.02B	8	64	17	4,4	B	304044R
M304.0008.03B	8	68	21	4,4	B	304044R
M304.0008.01E	8	60	13	4,4	E	304044R
M304.0008.02E	8	64	17	4,4	E	304044R
M304.0008.03E	8	68	21	4,4	E	304044R

w, Ds, tmax voir plaquettes
w, Ds, tmax vd. Inserti

Pièces Détachées

Ricambi

Corps de fraise Corpo fresa	Vis de serrage Vite di serraggio	Tournevis TORX PLUS® Cacciavite TORX PLUS®
M304...	1.8.4T6EP	T6PL

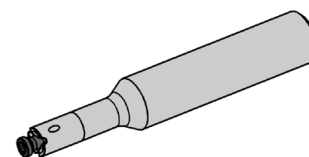
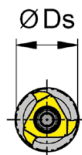
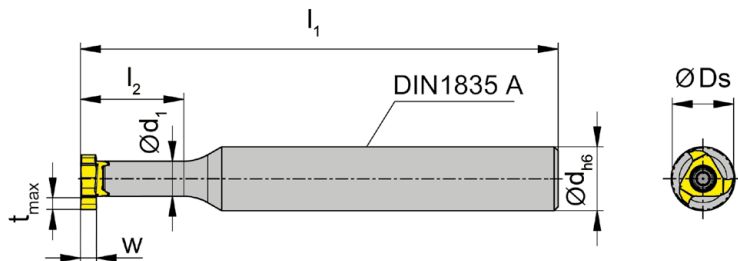
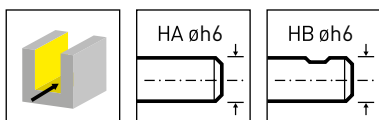

N° de commande Codice prodotto	d	l ₁	l ₂	d ₁	Forme Forma	HWS
M304.ST08.01A	8	60	13	4,4	A	304044R
M304.ST08.01B	8	60	13	4,4	B	304044R

w, Ds, tmax voir plaquettes
w, Ds, tmax vd. Inserti

Pièces Détachées

Ricambi

Corps de fraise Corpo fresa	Vis de serrage Vite di serraggio	Tournevis TORX PLUS® Cacciavite TORX PLUS®
M304...	1.8.4T6EP	T6PL

B

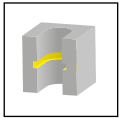

z3

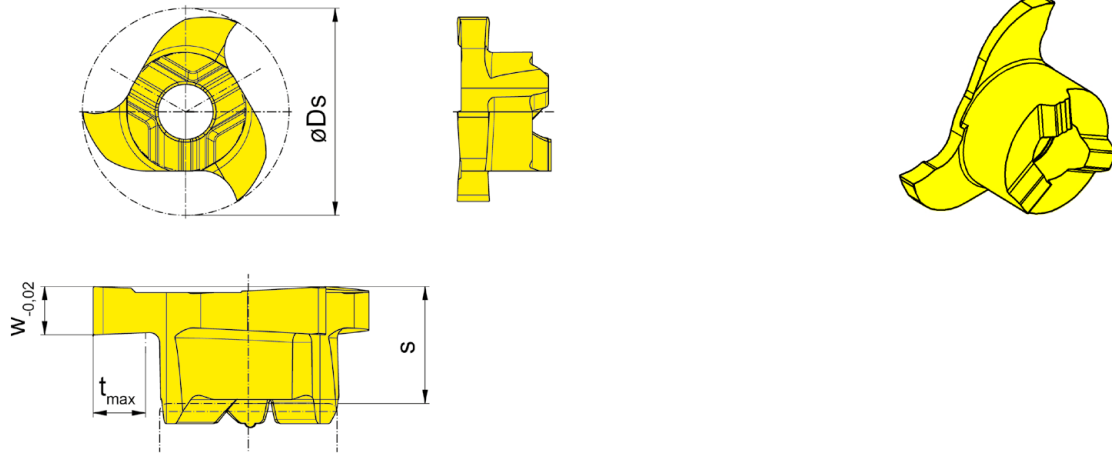

Illustration de coupe à droite représentée
Figura = taglio destro

Nuance
Leghe
▲ en stock
a stock
Δ 4 semaines
4 settimane

N° de commande Codice prodotto	Ds	w	s	r	t _{max}	Z	HIS	EG35	EG55	IG35
304.0025.20	7,7	0,25	2,6	-	1,3	3	304044R	▲		Δ
304.0030.20	7,7	0,3	2,6	-	1,3	3	304044R	▲		Δ
304.0040.20	7,7	0,4	2,6	-	1,3	3	304044R	▲		Δ
304.0050.20	7,7	0,5	2,6	-	1,3	3	304044R		▲	▲
304.0060.20	7,7	0,6	2,6	-	1,3	3	304044R	▲		Δ
304.0070.20	7,7	0,7	2,6	-	1,3	3	304044R	▲		Δ
304.0100.20	7,7	1	2,6	-	1,3	3	304044R		▲	▲
304.0150.20	7,7	1,5	2,9	0,1	1,3	3	304044R		▲	▲
304.0200.20	7,7	2	2,9	0,2	1,3	3	304044R		▲	▲
P	●	●	-							
M	●	○	●							
K	○	○	-							
N	-	-	-							
S	-	-	●							
H	-	-	-							

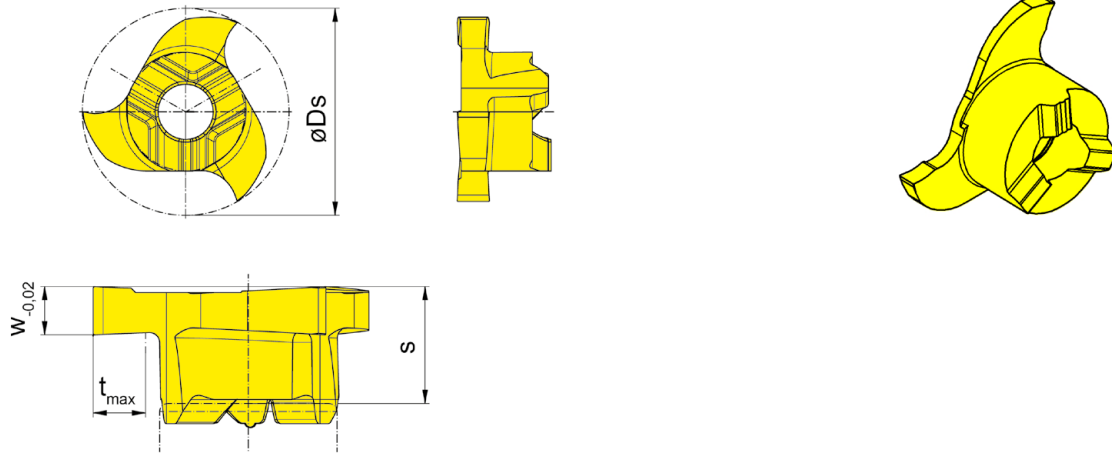

Illustration de coupe à droite représentée
Figura = taglio destro

Nuance
Leghe
▲ en stock
a stock
Δ 4 semaines
4 settimane

N° de commande Codice prodotto	Ds	Nw	w	s	t _{max}	Z	HIS	EG55	IG35
304.0080.20	7,7	0,8	0,87	2,6	1,3	3	304044R	▲	▲
304.0090.20	7,7	0,9	0,97	2,6	1,3	3	304044R	▲	▲
304.0110.20	7,7	1,1	1,21	2,9	1,3	3	304044R	▲	▲
304.0130.20	7,7	1,3	1,41	2,9	1,3	3	304044R	▲	▲
								P	● -
								M	○ ●
								K	○ -
								N	- -
								S	- ●
								H	- -

B

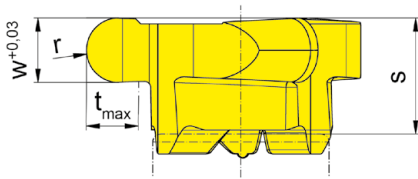
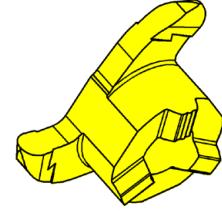
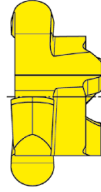
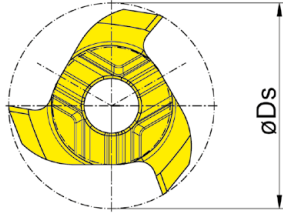

Illustration de coupe à droite représentée
Figura = taglio destro

Nuance
Leghe
▲ en stock
a stock
Δ 4 semaines
4 settimane

N° de commande Codice prodotto	Ds	w	s	r	t _{max}	Z	HIS	EG55	IG35
304.0004.08	7,7	0,8	2,6	0,4	1,3	3	304044R	▲	▲
304.0006.12	7,7	1,2	2,9	0,6	1,3	3	304044R	▲	▲
304.0008.16	7,7	1,6	2,9	0,8	1,3	3	304044R	Δ	Δ
								P	● -
								M	○ ●
								K	○ -
								N	- -
								S	- ●
								H	- -

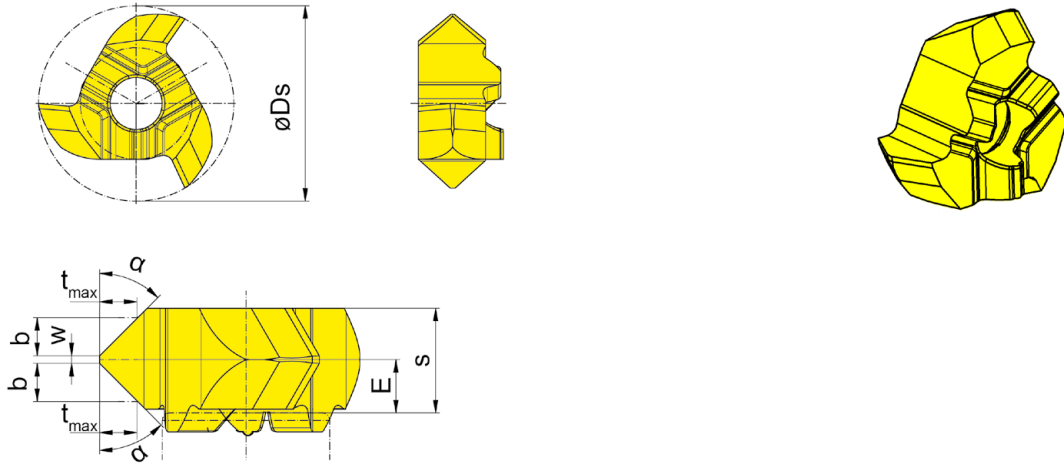

Illustration de coupe à droite représentée
Figura = taglio destro

Nuance
Leghe
▲ en stock
a stock
Δ 4 semaines
4 settimane

N° de commande Codice prodotto	Ds	E	s	w	a	b	t _{max}	Z	HIS	EG55	IG35	
304.1515.20	7,7	1,4	2,75	0,2	15°	1	0,3	3	304044R	Δ	Δ	
304.3030.20	7,7	1,4	2,75	0,2	30°	1	0,6	3	304044R	▲	▲	
304.4545.20	7,7	1,4	2,75	0,2	45°	1	1	3	304044R	▲	▲	
										P	●	-
										M	○	●
										K	○	-
										N	-	-
										S	-	●
										H	-	-

Fraisage de gorge par interpolation circ.

Fresatura di gole per interpolazione circolare



B

Corps de fraise
Corpo fresa
M306/M306.ER/M306.ST

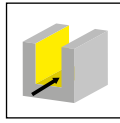

Page/Pag.
38-42

Base de support
Attacco Base
WFB

Page/Pag.
43

Corps de fraise vissé
Fresa avvitabile
M306.M

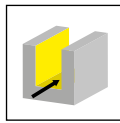

Page/Pag.
44

Plaquette
Inserto
108/306/606

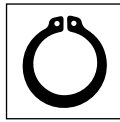

Page/Pag.
45-46, 50-54, 60

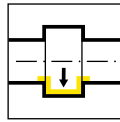

Page/Pag.
47

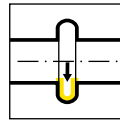

Page/Pag.
48

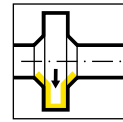

Page/Pag.
49

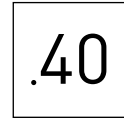

Page/Pag.
54, 57

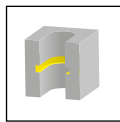

Page/Pag.
55-57, 61

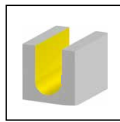

Page/Pag.
58

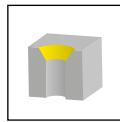

Page/Pag.
59, 62-63

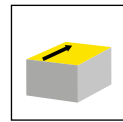

Page/Pag.
64-65