

**223**

**C**



**Porte outils et plaquettes**

Largeur de gorge 1,1 - 3 mm

**Portainserito e inserti**

Larghezza della gola 1,1 - 3 mm

C

Géométries et avances  
Geometrie e avanzamenti

Page/Pag.  
95

Base de support  
Attacco Base  
B223

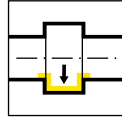

Page/Pag.  
96

Cassette  
Cartuccia  
BK223

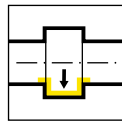

Page/Pag.  
97

Porte outils  
Portainsero  
B223/H223

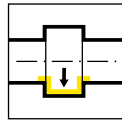

Page/Pag.  
98-101

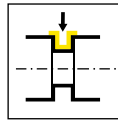

Page/Pag.  
102

Cartouche  
Cartuccia  
E223

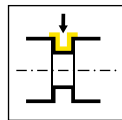

Page/Pag.  
103

Plaquette amovible  
Inserto  
S223

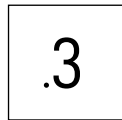

Page/Pag.  
104



Page/Pag.  
105



Page/Pag.  
106

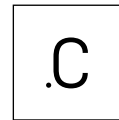

Page/Pag.  
107-108



Page/Pag.  
109

# Géométries et avances

Geometrie e avanzamenti



Géométrie Geometria	Matière Materiale	Avance f [mm/trs] Avanzamento f [mm/giro]	Usinage Lavorazione						
	<table border="1"> <tr> <td>P</td> <td>M</td> <td>K</td> </tr> <tr> <td>N</td> <td>S</td> <td>H</td> </tr> </table>	P	M	K	N	S	H	<p>↓ 0,15-0,25</p> <p>↔ 0,15-0,40</p>	
P	M	K							
N	S	H							
	<table border="1"> <tr> <td>P</td> <td>M</td> <td>K</td> </tr> <tr> <td>N</td> <td>S</td> <td>H</td> </tr> </table>	P	M	K	N	S	H	<p>↓ 0,10-0,45</p> <p>↔ 0,15-0,60</p>	
P	M	K							
N	S	H							
	<table border="1"> <tr> <td>P</td> <td>M</td> <td>K</td> </tr> <tr> <td>N</td> <td>S</td> <td>H</td> </tr> </table>	P	M	K	N	S	H	<p>↓ 0,02-0,10</p>	
P	M	K							
N	S	H							
	<table border="1"> <tr> <td>P</td> <td>M</td> <td>K</td> </tr> <tr> <td>N</td> <td>S</td> <td>H</td> </tr> </table>	P	M	K	N	S	H	<p>↓ 0,02-0,10</p> <p>↔ 0,02-0,15</p>	
P	M	K							
N	S	H							



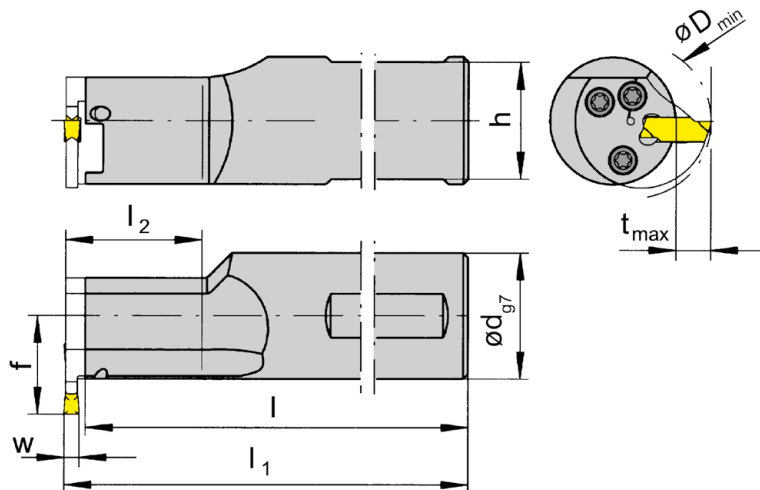
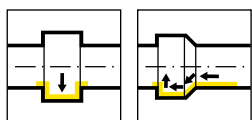

R = version à droite représentée  
R = versione destra come in figura

L = version à gauche  
L = versione sinistra a specchio

N° de commande Codice prodotto	$l_1$	d	l	$l_2$	h	f	HWS
RB223.0025.1.K2	$l+b_1+w/2$	25	116,1	30	23	19,5	BK2231
RB223.0025.2.K2	$l+b_1+w/2$	25	146,1	60	23	19,5	BK2231
RB223.0032.1.K2	$l+b_1+w/2$	32	146,1	30	30	23	BK2231
RB223.0032.2.K2	$l+b_1+w/2$	32	176,1	60	30	23	BK2231
LB223.0025.1.K2	$l+b_1+w/2$	25	116,1	30	23	19,5	BK2232
LB223.0025.2.K2	$l+b_1+w/2$	25	146,1	60	23	19,5	BK2232
LB223.0032.1.K2	$l+b_1+w/2$	32	146,1	30	30	23	BK2232
LB223.0032.2.K2	$l+b_1+w/2$	32	176,1	60	30	23	BK2232

w voir plaquettes amovibles  
w vd. inserti

Dimensions pour Dmin, tmax et b1 voir cassettes  
Per le dimensioni Dmin, tmax e b1 vd. sezione cartucce

### Pièces Détachées

Ricambi

Base de support Attacco Base	Vis de serrage Vite di serraggio	Tournevis TORX PLUS® Cacciavite TORX PLUS®
R/LB223...	4.09T15P	T15PL

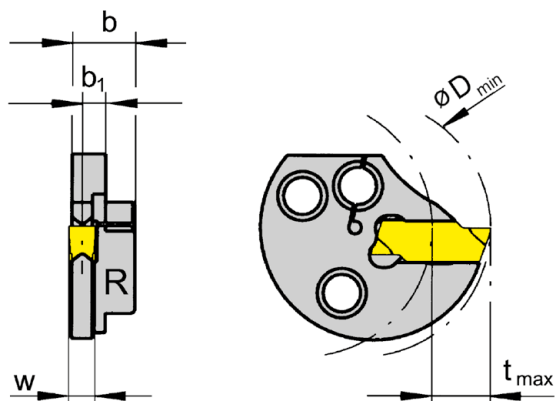
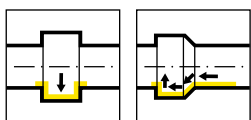

R = version à droite représentée  
R = versione destra come in figura

L = version à gauche  
L = versione sinistra a specchio

N° de commande Codice prodotto	D <sub>min</sub>	t <sub>max</sub>	b	b <sub>1</sub>	HWS	HMS
<b>RBK223.0028.01</b>	28	6,3	7,4	3,1	22301	BK2231
<b>RBK223.0028.02</b>	28	6,3	7,4	2,95	22302	BK2231
<b>RBK223.0028.03</b>	28	6,3	7,4	2,7	22303	BK2231
<b>LBK223.0028.01</b>	28	6,3	7,4	3,1	22301	BK2232
<b>LBK223.0028.02</b>	28	6,3	7,4	2,95	22302	BK2232
<b>LBK223.0028.03</b>	28	6,3	7,4	2,7	22303	BK2232

w voir plaquettes amovibles  
w vd. inserti

La vis de serrage est vendue avec le base de support.  
La vite di bloccaggio è fornita col portainserito base - non va ordinata separatamente.

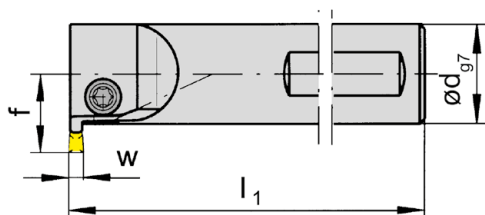
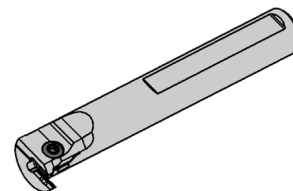
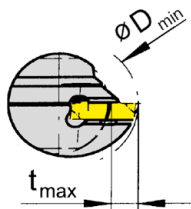
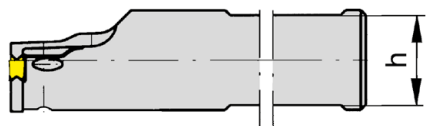
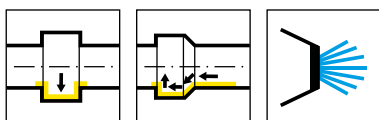

R = version à droite représentée  
R = versione destra come in figura

L = version à gauche  
L = versione sinistra a specchio

N° de commande Codice prodotto	d	l <sub>1</sub>	h	f	t <sub>max</sub>	D <sub>min</sub>	HWS
RB223.0016.0.42	16	110	14	13	4,5	22	22302
RB223.0016.0.43	16	110	14	13	4,5	22	22303
RB223.0020.0.52	20	120	18	15,7	5,3	27	22302
RB223.0020.0.53	20	120	18	15,7	5,3	27	22303
RB223.0025.0.62	25	150	23	19,3	6,3	33	22302
RB223.0025.0.63	25	150	23	19,3	6,3	33	22303
LB223.0016.0.42	16	110	14	13	4,5	22	22302
LB223.0016.0.43	16	110	14	13	4,5	22	22303
LB223.0020.0.52	20	120	18	15,7	5,3	27	22302
LB223.0020.0.53	20	120	18	15,7	5,3	27	22303
LB223.0025.0.62	25	150	23	19,3	6,3	33	22302
LB223.0025.0.63	25	150	23	19,3	6,3	33	22303

w voir plaquettes amovibles  
w vd. inserti

### Pièces Détachées

Ricambi

Porte outils Portainsero	Vis de serrage Vite di serraggio	Tournevis TORX PLUS® Cacciavite TORX PLUS®
R/LB223...	5.11T15P	T15PL

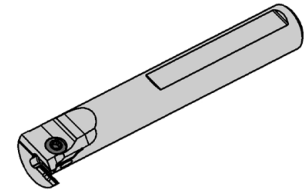
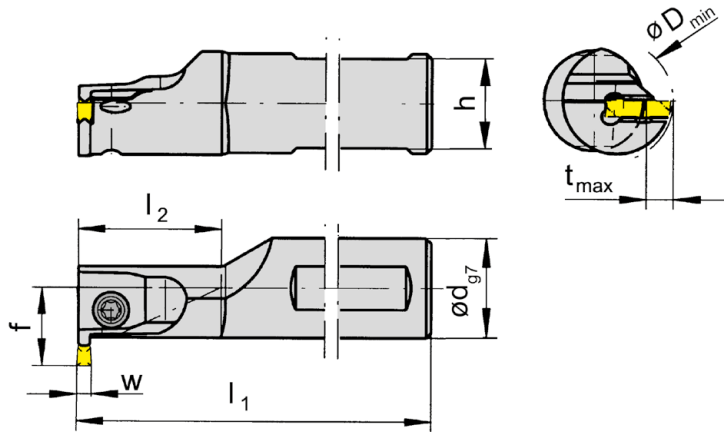
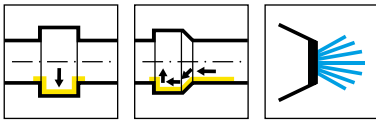

R = version à droite représentée  
R = versione destra come in figura

L = version à gauche  
L = versione sinistra a specchio

N° de commande Codice prodotto	d	l <sub>1</sub>	l <sub>2</sub>	h	f	t <sub>max</sub>	D <sub>min</sub>	HWS
RB223.0016.1.42	16	110	25	14	13	4,5	18	22302
RB223.0016.1.43	16	110	25	14	13	4,5	18	22303
RB223.0020.1.52	20	120	30	18	15,7	5,3	20	22302
RB223.0020.1.53	20	120	30	18	15,7	5,3	20	22303
RB223.0025.1.62	25	150	50	23	18,8	6,3	25	22302
RB223.0025.1.63	25	150	50	23	18,8	6,3	25	22303
LB223.0016.1.42	16	110	25	14	13	4,5	18	22302
LB223.0016.1.43	16	110	25	14	13	4,5	18	22303
LB223.0020.1.52	20	120	30	18	15,7	5,3	20	22302
LB223.0020.1.53	20	120	30	18	15,7	5,3	20	22303
LB223.0025.1.62	25	150	50	23	18,8	6,3	25	22302
LB223.0025.1.63	25	150	50	23	18,8	6,3	25	22303

w voir plaquettes amovibles  
w vd. inserti

### Pièces Détachées

Ricambi

Porte outils Portainsero	Vis de serrage Vite di serraggio	Tournevis TORX PLUS® Cacciavite TORX PLUS®
R/LB223...	5.11T15P	T15PL

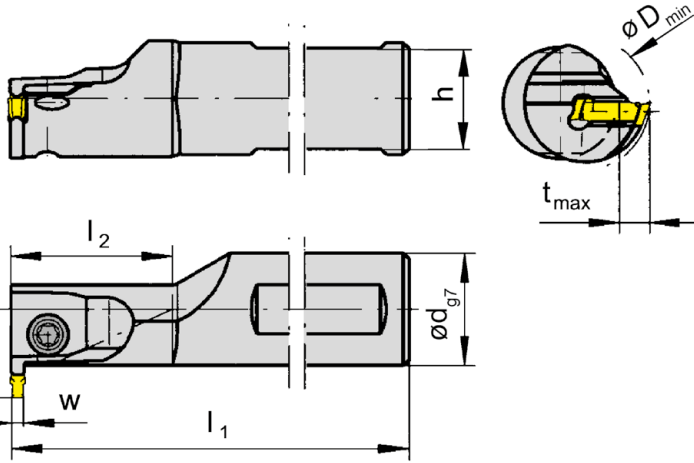
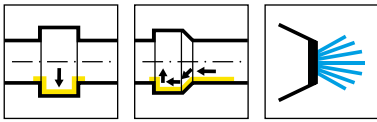

R = version à droite représentée  
R = versione destra come in figura

L = version à gauche  
L = versione sinistra a specchio

N° de commande Codice prodotto	d	l <sub>1</sub>	l <sub>2</sub>	h	f	t <sub>max</sub>	D <sub>min</sub>	HWS
RB223.0016.1.22	16	110	25	14	13	1,65	18	22302
RB223.0020.1.22	20	120	30	18	15,7	1,65	20	22302
LB223.0016.1.22	16	110	25	14	13	1,65	18	22302
LB223.0020.1.22	20	120	30	18	15,7	1,65	20	22302

w voir plaquettes amovibles  
w vd. inserti

**Pièces Détachées**

Ricambi

Porte outils Portainsero	Vis de serrage Vite di serraggio	Tournevis TORX PLUS® Cacciavite TORX PLUS®
R/LB223...	5.11T15P	T15PL



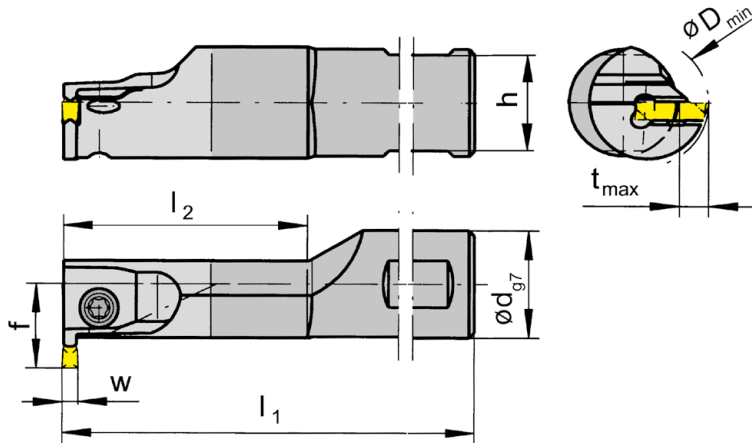
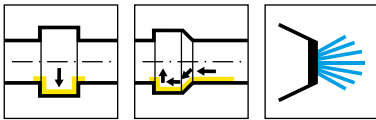

R = version à droite représentée  
R = versione destra come in figura

L = version à gauche  
L = versione sinistra a specchio

N° de commande Codice prodotto	d	l <sub>1</sub>	l <sub>2</sub>	h	f	t <sub>max</sub>	D <sub>min</sub>	HWS
RB223.HM16.2.42	16	130	50	14	13	4,5	18	22302
RB223.HM16.2.43	16	130	50	14	13	4,5	18	22303
RB223.HM20.2.52	20	150	60	18	15,7	5,3	20	22302
RB223.HM20.2.53	20	150	60	18	15,7	5,3	20	22303
RB223.HM25.2.62	25	160	70	23	18,8	6,3	25	22302
RB223.HM25.2.63	25	160	70	23	18,8	6,3	25	22303
LB223.HM16.2.42	16	130	50	14	13	4,5	18	22302
LB223.HM16.2.43	16	130	50	14	13	4,5	18	22303
LB223.HM20.2.52	20	150	60	18	15,7	5,3	20	22302
LB223.HM20.2.53	20	150	60	18	15,7	5,3	20	22303
LB223.HM25.2.62	25	160	70	23	18,8	6,3	25	22302
LB223.HM25.2.63	25	160	70	23	18,8	6,3	25	22303

w voir plaquettes amovibles  
w vd. inserti

### Pièces Détachées

Ricambi

Porte outils Portainsero	Vis de serrage Vite di serraggio	Tournevis TORX PLUS® Cacciavite TORX PLUS®
R/LB223...	5.11T15P	T15PL

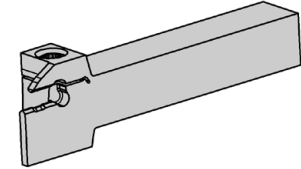
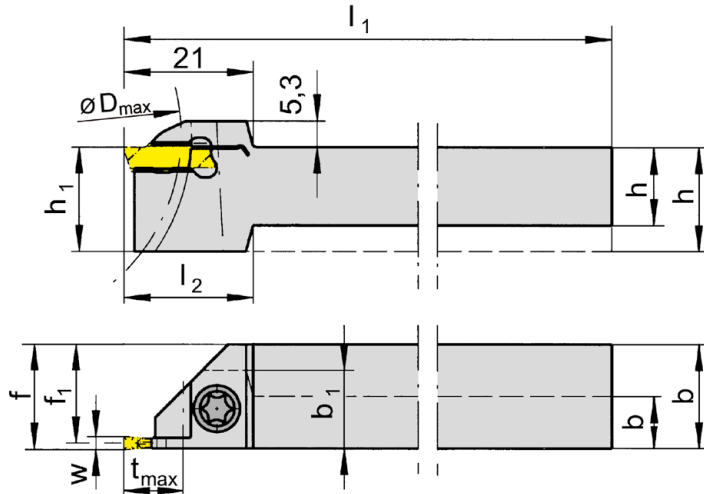
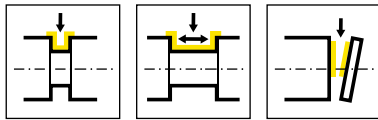

R = version à droite représentée  
R = versione destra come in figura

L = version à gauche  
L = versione sinistra a specchio

N° de commande Codice prodotto	h	b	l <sub>1</sub>	l <sub>2</sub>	h <sub>1</sub>	b <sub>1</sub>	f <sub>1</sub>	f	t <sub>max</sub>	D <sub>max</sub>	HWS
RH223.1010.01	10	10	80	20	12	12	9,2	f <sub>1</sub> +w/2	8	25	22301
RH223.1010.03	10	10	80	20	12	12	8,8	f <sub>1</sub> +w/2	8	25	22303
RH223.1212.01	12	12	100	21	16	-	11,2	f <sub>1</sub> +w/2	10	50	22301
RH223.1212.02	12	12	100	21	16	-	11,05	f <sub>1</sub> +w/2	10	50	22302
RH223.1212.03	12	12	100	21	16	-	10,8	f <sub>1</sub> +w/2	10	50	22303
RH223.1616.01	16	16	125	-	16	-	15,2	f <sub>1</sub> +w/2	10	50	22301
RH223.1616.02	16	16	125	-	16	-	15,05	f <sub>1</sub> +w/2	10	50	22302
RH223.1616.03	16	16	125	-	16	-	14,8	f <sub>1</sub> +w/2	10	50	22303
RH223.2020.01	20	20	125	-	20	-	19,2	f <sub>1</sub> +w/2	10	50	22301
RH223.2020.02	20	20	125	-	20	-	19,05	f <sub>1</sub> +w/2	10	50	22302
RH223.2020.03	20	20	125	-	20	-	18,8	f <sub>1</sub> +w/2	10	50	22303
RH223.2525.01	25	25	150	-	25	-	24,2	f <sub>1</sub> +w/2	10	50	22301
RH223.2525.02	25	25	150	-	25	-	24,05	f <sub>1</sub> +w/2	10	50	22302
RH223.2525.03	25	25	150	-	25	-	23,8	f <sub>1</sub> +w/2	10	50	22303
LH223.1010.01	10	10	80	20	12	12	9,2	f <sub>1</sub> +w/2	8	25	22301
LH223.1010.02	10	10	80	20	12	12	9,05	f <sub>1</sub> +w/2	8	25	22302
LH223.1010.03	10	10	80	20	12	12	8,8	f <sub>1</sub> +w/2	8	25	22303
LH223.1212.01	12	12	100	21	16	-	11,2	f <sub>1</sub> +w/2	10	50	22301
LH223.1212.02	12	12	100	21	16	-	11,05	f <sub>1</sub> +w/2	10	50	22302
LH223.1212.03	12	12	100	21	16	-	10,8	f <sub>1</sub> +w/2	10	50	22303
LH223.1616.01	16	16	125	-	16	-	15,2	f <sub>1</sub> +w/2	10	50	22301
LH223.1616.02	16	16	125	-	16	-	15,05	f <sub>1</sub> +w/2	10	50	22302
LH223.1616.03	16	16	125	-	16	-	14,8	f <sub>1</sub> +w/2	10	50	22303
LH223.2020.01	20	20	125	-	20	-	19,2	f <sub>1</sub> +w/2	10	50	22301
LH223.2020.02	20	20	125	-	20	-	19,05	f <sub>1</sub> +w/2	10	50	22302
LH223.2020.03	20	20	125	-	20	-	18,8	f <sub>1</sub> +w/2	10	50	22303
LH223.2525.01	25	25	150	-	25	-	24,2	f <sub>1</sub> +w/2	10	50	22301
LH223.2525.02	25	25	150	-	25	-	24,05	f <sub>1</sub> +w/2	10	50	22302
LH223.2525.03	25	25	150	-	25	-	23,8	f <sub>1</sub> +w/2	10	50	22303

Pièces Détachées

Ricambi

w voir plaquettes amovibles  
w vd. inserti

Porte outils Portainsero	Vis de serrage Vite di serraggio	Tournevis TORX PLUS® Cacciavite TORX PLUS®
R/LH223...	5.11T15P	T15PL

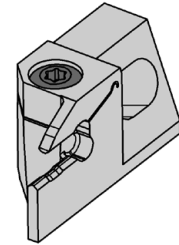
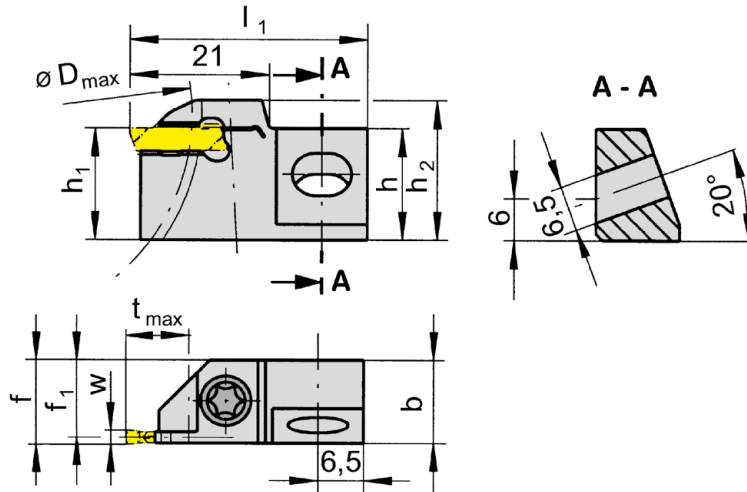
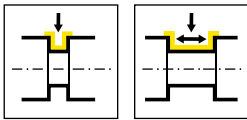

R = version à droite représentée  
R = versione destra come in figura

L = version à gauche  
L = versione sinistra a specchio

N° de commande Codice prodotto	h	b	l <sub>1</sub>	h <sub>1</sub>	f <sub>1</sub>	f	t <sub>max</sub>	D <sub>max</sub>	h <sub>2</sub>
RE223.1212.01	16	12	34	12	11,2	f <sub>1</sub> +w/2	10	50	17,3
RE223.1212.02	16	12	34	12	11,05	f <sub>1</sub> +w/2	10	50	17,3
RE223.1212.03	16	12	34	12	10,8	f <sub>1</sub> +w/2	10	50	17,3
RE223.1616.01	16	12	34	16	11,2	f <sub>1</sub> +w/2	10	50	21,3
RE223.1616.02	16	12	34	16	11,05	f <sub>1</sub> +w/2	10	50	21,3
RE223.1616.03	16	12	34	16	10,8	f <sub>1</sub> +w/2	10	50	21,3
LE223.1212.01	16	12	34	12	11,2	f <sub>1</sub> +w/2	10	50	17,3
LE223.1212.02	16	12	34	12	11,05	f <sub>1</sub> +w/2	10	50	17,3
LE223.1212.03	16	12	34	12	10,8	f <sub>1</sub> +w/2	10	50	17,3
LE223.1616.01	16	12	34	16	11,2	f <sub>1</sub> +w/2	10	50	21,3
LE223.1616.02	16	12	34	16	11,05	f <sub>1</sub> +w/2	10	50	21,3
LE223.1616.03	16	12	34	16	10,8	f <sub>1</sub> +w/2	10	50	21,3

w voir plaquettes amovibles  
w vd. inserti

**Pièces Détachées**

Ricambi

Cartouche Cartuccia	Vis de serrage Vite di serraggio	Vis Vite	Tournevis TORX PLUS® Cacciavite TORX PLUS®
R/LE223...	5.11T15P	6.20.232	T15PL

# Plaquette amovible

Inserto

# S223

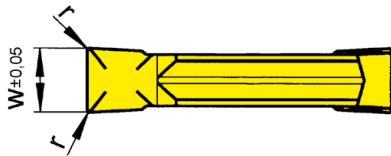
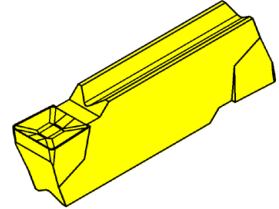
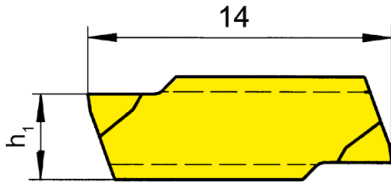
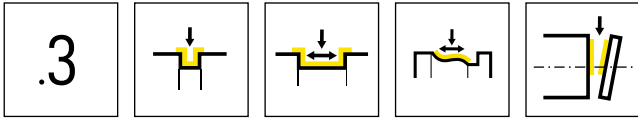

Nuance  
Leghe

▲ en stock  
a stock

Δ 4 semaines  
4 settimane

N° de commande Codice prodotto	w	r	h <sub>1</sub>	HIS		MG12	EG55	H54	TI25	TN35
S223.0200.32	2	0,2	3,65	22301		▲	▲	▲	▲	▲
S223.0250.32	2,5	0,2	3,75	22302		▲	▲	▲	▲	▲
S223.0300.32	3	0,2	3,95	22303		▲	▲	▲	▲	▲
					P	o	•	•	•	•
					M	-	o	•	•	•
					K	-	o	-	•	•
					N	-	-	-	•	•
					S	-	-	-	•	•
					H	-	-	-	-	-

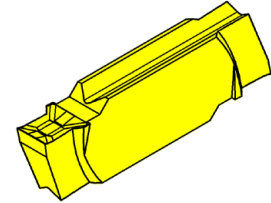
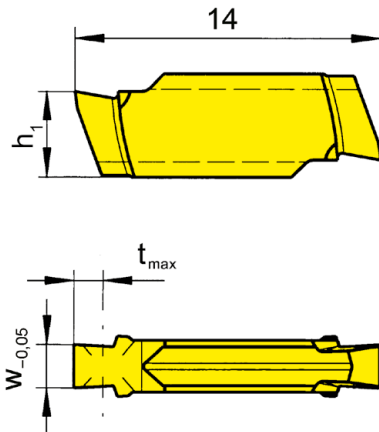
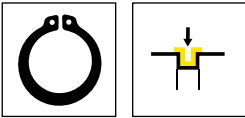

Nuance  
Leghe

▲ en stock  
a stock

Δ 4 semaines  
4 settimane

N° de commande Codice prodotto	w	Nw	t <sub>max</sub>	h <sub>1</sub>	HIS	Nuance	
						EG55	TN35
S223.0110.32	1,24	1,1	0,6	3,75	22302	Δ	▲
S223.0130.32	1,44	1,3	1,1	3,75	22302	Δ	▲
S223.0160.32	1,74	1,6	1,15	3,75	22302	Δ	▲
S223.0185.32	1,99	1,85	1,4	3,75	22302	Δ	▲
S223.0215.32	2,29	2,15	1,65	3,75	22302	Δ	▲
						P	● ●
						M	○ ●
						K	○ ●
						N	- ●
						S	- ●
						H	- -

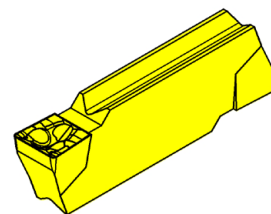
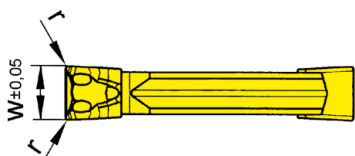
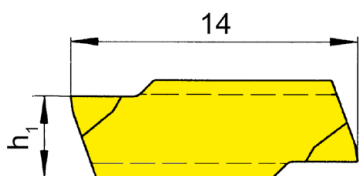
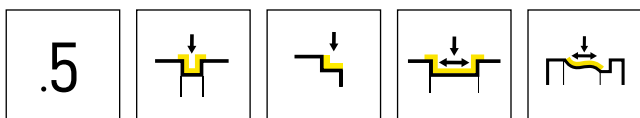

Nuance  
Leghe

▲ en stock  
a stock

Δ 4 semaines  
4 settimane

N° de commande Codice prodotto	w	r	h <sub>1</sub>	HIS	Nuance		
					EG55	TH35	TI25
S223.0200.52	2	0,2	3,65	22301	▲	▲	●
S223.0250.52	2,5	0,2	3,75	22302	▲	●	▲
S223.0300.52	3	0,2	3,95	22303	▲	▲	Δ
P	●	●	●				
M	○	●	●				
K	○	●	●				
N	-	●	●				
S	-	●	●				
H	-	-	-				

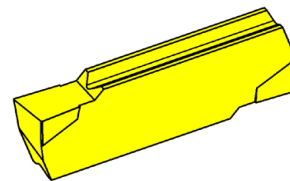
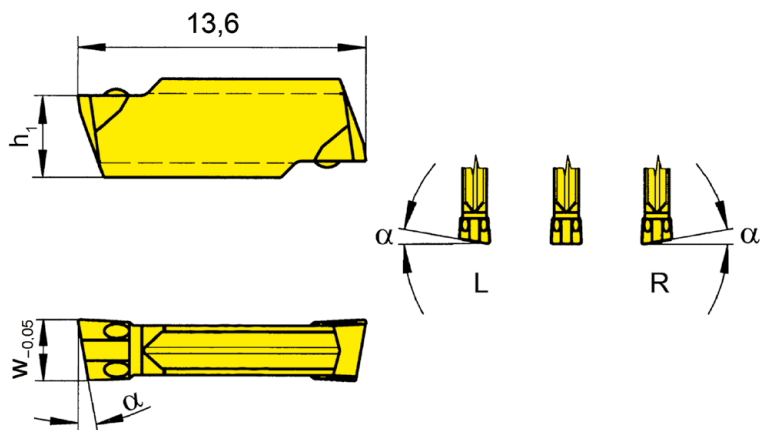
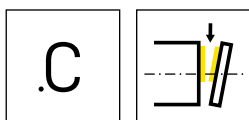

R = version à droite représentée  
R = versione destra come in figura

L = version à gauche  
L = versione sinistra a specchio

▲ en stock  
a stock

Nuance  
Leghe  
Δ 4 semaines  
4 settimane

N° de commande Codice prodotto	w	α	h <sub>1</sub>	HIS	Nuance Leghe			
					EG55	TF45	TI25	TN35
RS223.0420.C0	2	4°	3,65	22301	Δ	Δ	▲	▲
RS223.0425.C0	2,5	4°	3,75	22302	Δ	Δ	▲	▲
RS223.0430.C0	3	4°	3,95	22303	Δ	Δ	Δ	Δ
RS223.0820.C0	2	8°	3,65	22301	▲	▲	▲	▲
RS223.0825.C0	2,5	8°	3,75	22302	▲	▲	▲	▲
RS223.0830.C0	3	8°	3,95	22303	Δ	▲	▲	▲
RS223.1520.C0	2	15°	3,65	22301	▲	▲	▲	▲
LS223.0420.C0	2	4°	3,65	22301	Δ	Δ		▲
LS223.0425.C0	2,5	4°	3,75	22302	Δ	Δ	Δ	Δ
LS223.0430.C0	3	4°	3,95	22303	Δ	Δ	Δ	Δ
LS223.0820.C0	2	8°	3,65	22301	Δ		▲	▲
LS223.0825.C0	2,5	8°	3,75	22302	Δ	Δ	Δ	
LS223.0830.C0	3	8°	3,95	22303	Δ	Δ	Δ	Δ
LS223.1520.C0	2	15°	3,65	22301	Δ	Δ	▲	▲
S223.0020.C0	2	0°	3,65	22301	▲	▲	▲	▲
S223.0025.C0	2,5	0°	3,75	22302	Δ	Δ	▲	Δ
S223.0030.C0	3	0°	3,95	22303	Δ	Δ	▲	▲
P					●	●	●	●
M					○	●	●	●
K					○	●	●	●
N					-	●	●	●
S					-	●	●	●
H					-	-	-	-

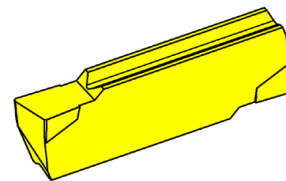
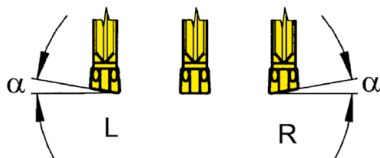
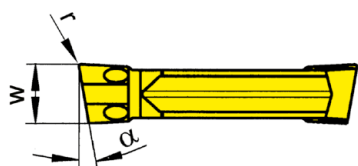
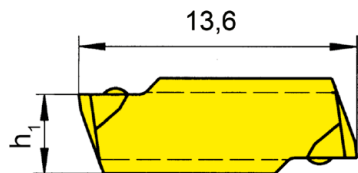
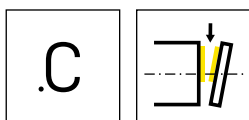

R = version à droite représentée  
R = versione destra come in figura

L = version à gauche  
L = versione sinistra a specchio

▲ en stock  
a stock

Nuance  
Leghe  
Δ 4 semaines  
4 settimane

N° de commande Codice prodotto	w	r	α	h <sub>1</sub>	HIS	EG55	TF45	TI25	TN35
RS223.0420.C1	2	0,15	4°	3,65	22301	Δ	Δ	Δ	▲
RS223.0425.C1	2,5	0,15	4°	3,75	22302	Δ	Δ	Δ	Δ
RS223.0430.C1	3	0,15	4°	3,95	22303	Δ	Δ		Δ
RS223.0820.C1	2	0,15	8°	3,65	22301	Δ	▲	▲	▲
RS223.0825.C1	2,5	0,15	8°	3,75	22302	Δ	Δ	▲	Δ
RS223.0830.C1	3	0,15	8°	3,95	22303	Δ	▲	Δ	
RS223.1520.C1	2	0,15	15°	3,65	22301	Δ	▲	Δ	▲
LS223.0420.C1	2	0,15	4°	3,65	22301	Δ	Δ	Δ	▲
LS223.0425.C1	2,5	0,15	4°	3,75	22302	Δ	Δ	Δ	Δ
LS223.0430.C1	3	0,15	4°	3,95	22303	Δ	Δ	Δ	Δ
LS223.0820.C1	2	0,15	8°	3,65	22301	Δ		Δ	Δ
LS223.0825.C1	2,5	0,15	8°	3,75	22302	Δ		Δ	Δ
LS223.0830.C1	3	0,15	8°	3,95	22303	Δ	Δ	Δ	Δ
LS223.1520.C1	2	0,15	15°	3,65	22301	Δ		Δ	Δ
S223.0020.C1	2	0,15	0°	3,65	22301	Δ	▲	▲	▲
S223.0025.C1	2,5	0,15	0°	3,75	22302	Δ	Δ	▲	Δ
S223.0030.C1	3	0,15	0°	3,95	22303	Δ	▲	▲	▲

P	●	●	●	●
M	○	●	●	●
K	○	●	●	●
N	-	●	●	●
S	-	●	●	●
H	-	-	-	-



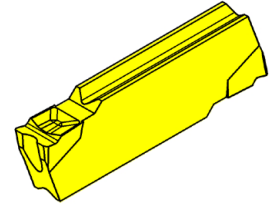
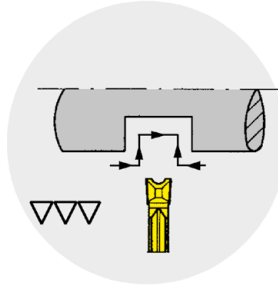
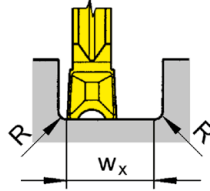
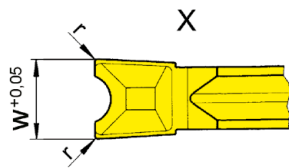
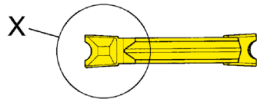
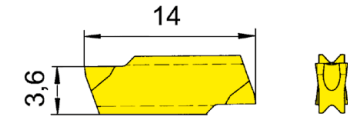
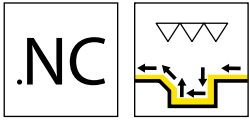

Nuance  
Leghe

▲ en stock  
a stock

Δ 4 semaines  
4 settimane

N° de commande Codice prodotto	w	r	t <sub>max</sub>	w <sub>x</sub>	HIS	EG55	TI25
<b>S223.NC20.D2</b>	2	0,2	10	2,7	22301	Δ	▲
						P ● ●	
						M ○ ●	
						K ○ ●	
						N - ●	
						S - ●	
						H - -	

wx = largeur de gorge - R(droite) - R(gauche)  
wx = larghezza gola - R(destro) - R(sinistro)