

ES-Bore Digital 3E^{TECH+} Fine Boring Cartridges | Insert Forms 101 and 20

Diameter Range: ≥1.102" (28.00 mm)

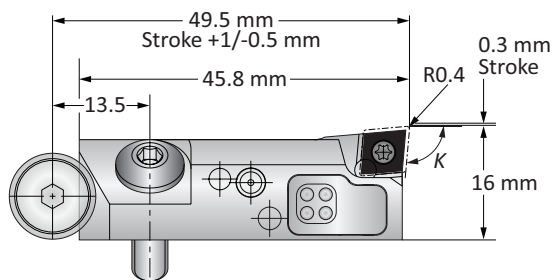

Holder Type	K	ISO	Minimum Boring Diameter	Cutting Direction	Insert Form	Weight	Part No.
	90°	CC.. 0602..	28.00	Right	101	0.06 (kg)	345032
	90°	CC.. 0602..	28.00	Left	101	0.06 (kg)	345033
	90°	TOGX 0802..	28.00	Right	20	0.06 (kg)	345042
	90°	TOGX 0802..	28.00	Left	20	0.06 (kg)	345043
	95°	CC.. 0602..	28.00	Right	101	0.06 (kg)	345030
	95°	CC.. 0602..	28.00	Left	101	0.06 (kg)	345031
	95°	TOGX 0802..	28.00	Right	20	0.06 (kg)	345040
	95°	TOGX 0802..	28.00	Left	20	0.06 (kg)	345041

NOTE: ES-Bore digital fine boring cartridges must be used with the new 3E^{TECH+} and adapter plate. The ES-Bore cannot be used with 3E^{TECH}.
NOTE: 3E^{TECH+} module, adapter, and charging unit sold separately.

3E^{TECH+} Digital Readout Module

Part No.	Charging Unit*
536015	536016

NOTE: WEEE-Reg.-Nr. DE 15820388
 *Charging unit sold separately



NOTE: 3E^{TECH+} adjustment accuracy of 0.001 mm on diameter

Adapter Plate for 3E^{TECH+}

Cutting Direction	Part No.
Right	536017
Left	536018

NOTE: Adapter sold separately.



B10-M: 12-13 B10-H B10: VI-VII

m = Metric (mm)
 Inserts sold separately



ES-Bore Analogue Fine Boring Cartridges | Insert Forms 101 and 20

Diameter Range: $\geq 1.102''$ (28.00 mm)

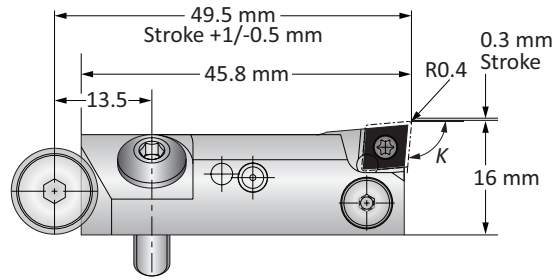

Holder Type	K	ISO	Minimum Boring Diameter	Cutting Direction	Insert Form	Weight	Part No.
	90°	CC.. 0602..	28.00	Right	101	0.06 (kg)	345036
	90°	CC.. 0602..	28.00	Left	101	0.06 (kg)	345037
	90°	TOGX 0802..	28.00	Right	20	0.06 (kg)	345046
	90°	TOGX 0802..	28.00	Left	20	0.06 (kg)	345047
	95°	CC.. 0602..	28.00	Right	101	0.06 (kg)	345034
	95°	CC.. 0602..	28.00	Left	101	0.06 (kg)	345035
	95°	TOGX 0802..	28.00	Right	20	0.06 (kg)	345044
	95°	TOGX 0802..	28.00	Left	20	0.06 (kg)	345045

Ⓜ

Key on B10-L-1

B10-M: 12-13

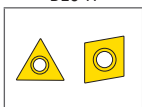

B10: VI-VII

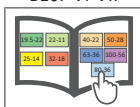

Ⓜ = Metric (mm)
Inserts sold separately

ES-Bore Accessories

Screws | Service Keys | 3E^{TECH+} Accessories

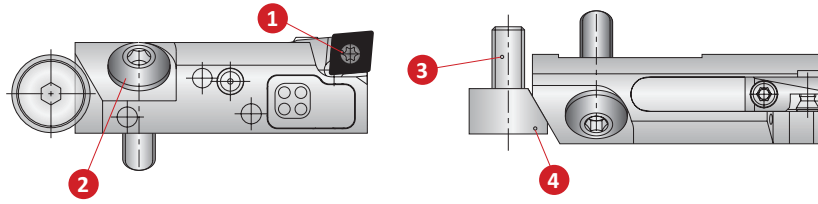

	1 Insert Screw		2 Mounting Screw	3 Height Adjusting Screw	4 Height Adjusting Wedge
	Insert Form 101	Insert Form 20			
Screw	115676 (T8)	115535 (T7)	515632 (s3)	115466 (s3)	415721
Service Key	115590	115591	051110	051110	-

3E^{TECH+} Accessories

1 Charging Unit
Part No.
536016

NOTE: Charging unit sold separately from 3E^{TECH+}



NOTE: 3E^{TECH+} adjustment accuracy of 0.001 mm on diameter

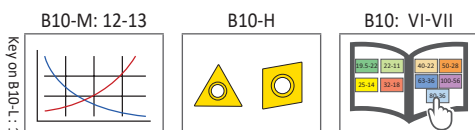

 = Metric (mm)
Inserts sold separately