

Reducing Sleeves

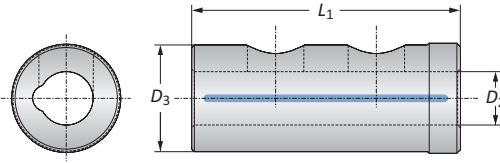

Reducing Sleeve				Part No.
D_3	D_2	L_1		
8.00	4.00	20.00		514201
8.00	5.00	20.00		514202
8.00	6.00	20.00		514210
8.00	7.00	20.00		514203

Ⓜ

B10-M: 12-13
Key on B10-A: 1

B10-A: 58

B10-H

B10: VI-VII

Ⓜ = Metric (mm)
Inserts sold separately