

BARREAUX CARBURE

BARRE CILINDRICHE IN METALLO DURO



BARREAUX CARBURE Type **WOR**

BARRE IN METALLO DURO Tipo

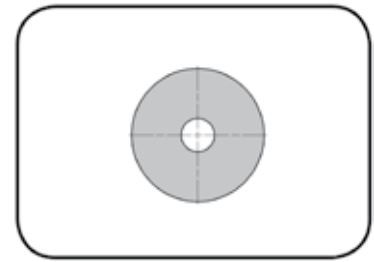

Barreaux carbure cylindriques, frittés, avec trou d'arrosage
Barre piene in metallo duro con foro centrale di lubrorefrigerazione

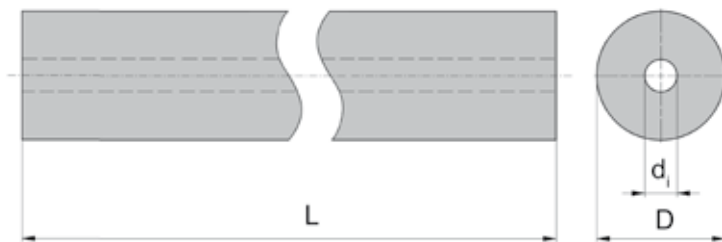

N° de commande Codice prodotto	Description Descrizione	D	d _i	L	HK1F	HK6F
WOR04333000040	Ø 4,3 x 0,4 x 330	4,3	0,4	330		Δ
WOR04333000060	Ø 4,3 x 0,6 x 330	4,3	0,6		Δ	
WOR04333000080	Ø 4,3 x 0,8 x 330	4,3	0,8		Δ	
WOR04333000100	Ø 4,3 x 1,0 x 330	4,3	1,0		Δ	
WOR04333000140	Ø 4,3 x 1,4 x 330	4,3	1,4		Δ	
WOR04333000180	Ø 4,3 x 1,8 x 330	4,3	1,8		Δ	
WOR05333000050	Ø 5,3 x 0,5 x 330	5,3	0,5		Δ	
WOR05333000100	Ø 5,3 x 1,0 x 330	5,3	1,0		▲	
WOR05333000200	Ø 5,3 x 2,0 x 330	5,3	2,0		Δ	
WOR06333000050	Ø 6,3 x 0,5 x 330	6,3	0,5		Δ	
WOR06333000100	Ø 6,3 x 1,0 x 330	6,3	1,0		▲	
WOR06333000150	Ø 6,3 x 1,5 x 330	6,3	1,5		▲	
WOR06333000200	Ø 6,3 x 2,0 x 330	6,3	2,0		▲	
WOR08333000080	Ø 8,3 x 0,8 x 330	8,3	0,8		▲	
WOR08333000100	Ø 8,3 x 1,0 x 330	8,3	1,0			Δ
WOR08333000150	Ø 8,3 x 1,5 x 330	8,3	1,5		▲	
WOR08333000200	Ø 8,3 x 2,0 x 330	8,3	2,0		▲	
WOR10333000100	Ø 10,3 x 1,0 x 330	10,3	1,0			Δ
WOR10333000150	Ø 10,3 x 1,5 x 330	10,3	1,5		▲	
WOR10333000200	Ø 10,3 x 2,0 x 330	10,3	2,0		▲	
WOR10833000150	Ø 10,8 x 1,5 x 330	10,8	1,5		Δ	

▲ en stock / a stock Δ 4 semaines / consegna 4 settimane

● Premier choix / raccomandato

○ Choix alternatif / alternativa

■ Nuance non revêtue / non rivestito

■ Nuance revêtue / rivestito

■ brasé/Cermet / saldobrasato/Cermet

P	●	●
M	○	○
K	●	●
N	●	●
S	○	○
H		

Dimensions en mm
Dimensioni in mm

Nuance
Leghe

BARREAUX CARBURE

BARRE CILINDRICHE IN METALLO DURO



BARREAUX CARBURE Type **WOR**

BARRE IN METALLO DURO Tipo

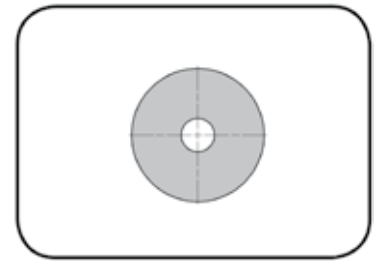

Barreaux carbure cylindriques, frittés, avec trou d'arrosage
Barre piene in metallo duro con foro centrale di lubrorefrigerazione

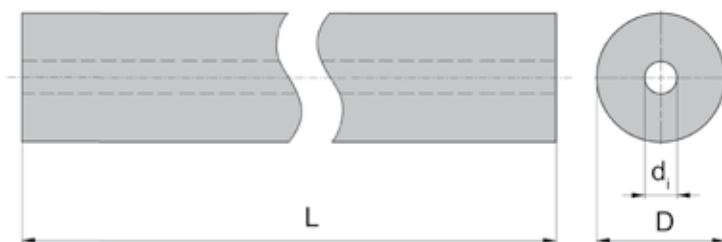

N° de commande Codice prodotto	Description Descrizione	D	d _i	L	HK1F	HK6F
WOR12333000150	Ø 12,3 x 1,5 x 330	12,3	1,5	330	▲	
WOR12333000200	Ø 12,3 x 2,0 x 330	12,3	2,0		▲	▲
WOR12333000250	Ø 12,3 x 2,5 x 330	12,3	2,5			Δ
WOR12333000300	Ø 12,3 x 3,0 x 330	12,3	3,0			Δ
WOR14333000200	Ø 14,3 x 2,0 x 330	14,3	2,0		▲	
WOR14333000250	Ø 14,3 x 2,5 x 330	14,3	2,5		▲	▲
WOR16333000200	Ø 16,3 x 2,0 x 330	16,3	2,0		▲	
WOR16333000300	Ø 16,3 x 3,0 x 330	16,3	3,0		▲	▲
WOR18333000200	Ø 18,3 x 2,0 x 330	18,3	2,0		▲	
WOR18333000300	Ø 18,3 x 3,0 x 330	18,3	3,0			▲
WOR20333000200	Ø 20,3 x 2,0 x 330	20,3	2,0		▲	▲
WOR20333000300	Ø 20,3 x 3,0 x 330	20,3	3,0			Δ
WOR20333000350	Ø 20,3 x 3,5 x 330	20,3	3,5		▲	
WOR22333000200	Ø 22,3 x 2,0 x 330	22,3	2,0			Δ
WOR22333000350	Ø 22,3 x 3,5 x 330	22,3	3,5		▲	
WOR25333000300	Ø 25,3 x 3,0 x 330	25,3	3,0			Δ
WOR25333000500	Ø 25,3 x 5,0 x 330	25,3	5,0		▲	▲
WOR28333000500	Ø 28,3 x 5,0 x 330	28,3	5,0			Δ
WOR30333000300	Ø 30,3 x 3,0 x 330	30,3	3,0			Δ
WOR30333000500	Ø 30,3 x 5,0 x 330	30,3	5,0			Δ
WOR32633000500	Ø 32,6 x 5,0 x 330	32,6	5,0	▲		

▲ en stock / a stock Δ 4 semaines / consegna 4 settimane

● Premier choix / raccomandato

○ Choix alternatif / alternativa

■ Nuance non revêtue / non rivestito

■ Nuance revêtue / rivestito

■ brasé/Cermet / saldobrasato/Cermet

P	●	●
M	○	○
K	●	●
N	●	●
S	○	○
H		

Nuance
Leghe

Dimensions en mm

Dimensioni in mm

HARTMETALLSTAB Typ
CARBIDE ROD Type

WOS

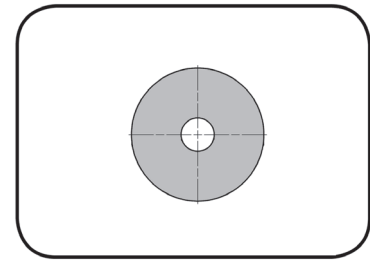

Rundstäbe geschliffen h6, mit Kühlbohrung
Solid carbide rods, ground h6, with coolant hole

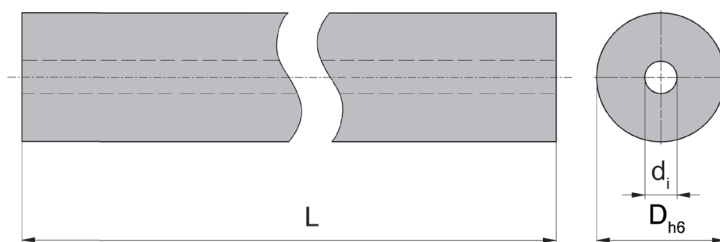

Bestellnummer Part number	Bezeichnungen Description	D	d _i	L	HK1F	HK6F
WOS04033000040	Ø 4h6 x 0,4 x 330	4	0,4	330		
WOS04033000060	Ø 4h6 x 0,6 x 330	4	0,6			
WOS04033000080	Ø 4h6 x 0,8 x 330	4	0,8			
WOS04033000100	Ø 4h6 x 1,0 x 330	4	1,0			
WOS04033000140	Ø 4h6 x 1,4 x 330	4	1,4			
WOS04033000180	Ø 4h6 x 1,8 x 330	4	1,8			
WOS05033000050	Ø 5h6 x 0,5 x 330	5	0,5			
WOS05033000100	Ø 5h6 x 1,0 x 330	5	1,0			▲
WOS05033000200	Ø 5h6 x 2,0 x 330	5	2,0			
WOS06033000050	Ø 6h6 x 0,5 x 330	6	0,5			
WOS06033000100	Ø 6h6 x 1,0 x 330	6	1,0			▲
WOS06033000150	Ø 6h6 x 1,5 x 330	6	1,5			▲
WOS06033000200	Ø 6h6 x 2,0 x 330	6	2,0			▲
WOS08033000080	Ø 8h6 x 0,8 x 330	8	0,8			▲
WOS08033000100	Ø 8h6 x 1,0 x 330	8	1,0			
WOS08033000150	Ø 8h6 x 1,5 x 330	8	1,5			▲
WOS08033000200	Ø 8h6 x 2,0 x 330	8	2,0			▲
WOS09033000150	Ø 9h5 x 1,5 x 330	9	1,5			
WOS10033000100	Ø 10h6 x 1,0 x 330	10	1,0			
WOS10033000150	Ø 10h6 x 1,5 x 330	10	1,5			▲
WOS10033000200	Ø 10h6 x 2,0 x 330	10	2,0		▲	

▲ ab Lager
▲ on stock

HM-Sorten
Carbide grades

Abmessungen in mm
Dimensions in mm

Weitere Abmessungen und HM-Sorten auf Anfrage!
Further dimensions and carbide grades upon request!

HARTMETALLSTAB Typ
CARBIDE ROD Type

WOS

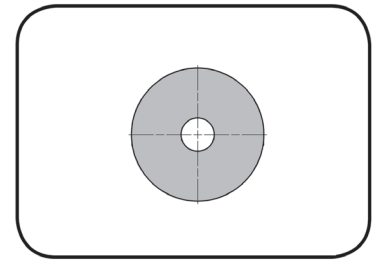

Rundstäbe geschliffen h6, mit Kühlbohrung
Solid carbide rods, ground h6, with coolant hole

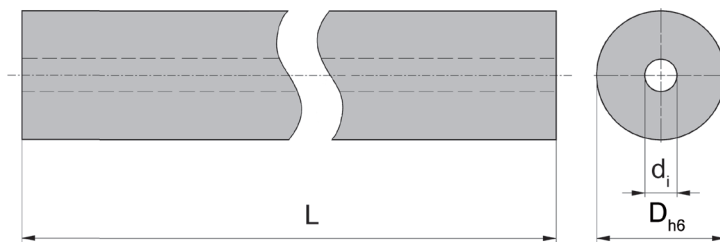

Bestellnummer Part number	Bezeichnungen Description	D	d _i	L	HK1F	HK6F
WOS10533000150	Ø 10,5h6 x 1,5 x 330	10,5	1,5	330		
WOS12033000150	Ø 12h6 x 1,5 x 330	12,0	1,5		▲	
WOS12033000200	Ø 12h6 x 2,0 x 330	12,0	2,0		▲	▲
WOS12033000250	Ø 12h6 x 2,5 x 330	12,0	2,5			
WOS12033000300	Ø 12h6 x 3,0 x 330	12,0	3,0			
WOS14033000200	Ø 14h6 x 2,0 x 330	14,0	2,0		▲	
WOS14033000250	Ø 14h6 x 2,5 x 330	14,0	2,5			▲
WOS16033000200	Ø 16h6 x 2,0 x 330	16,0	2,0		▲	
WOS16033000300	Ø 16h6 x 3,0 x 330	16,0	3,0		▲	▲
WOS18033000200	Ø 18h6 x 2,0 x 330	18,0	2,0		▲	
WOS18033000300	Ø 18h6 x 3,0 x 330	18,0	3,0		▲	▲
WOS20033000200	Ø 20h6 x 2,0 x 330	20,0	2,0		▲	▲
WOS20033000300	Ø 20h6 x 3,0 x 330	20,0	3,0			
WOS20033000350	Ø 20h6 x 3,5 x 330	20,0	3,5		▲	
WOS22033000200	Ø 22h6 x 2,0 x 330	22,0	2,0			
WOS22033000350	Ø 22h6 x 3,5 x 330	22,0	3,5		▲	
WOS25033000300	Ø 25h6 x 3,0 x 330	25,0	3,0			
WOS25033000500	Ø 25h6 x 5,0 x 330	25,0	5,0		▲	▲
WOS28033000500	Ø 28h6 x 5,0 x 330	28,0	5,0			
WOS30033000300	Ø 30h6 x 3,0 x 330	30,0	3,0			
WOS30033000500	Ø 30h6 x 5,0 x 330	30,0	5,0			
WOS32033000500	Ø 32h6 x 5,0 x 330	32,0	5,0		▲	

▲ ab Lager
▲ on stock

HM-Sorten
Carbide grades

Abmessungen in mm
Dimensions in mm

Weitere Abmessungen und HM-Sorten auf Anfrage!
Further dimensions and carbide grades upon request!