

# BARREAUX CARBURE

## BARRE CILINDRICHE IN METALLO DURO



**BARREAUX CARBURE Type**  
BARRE IN METALLO DURO Tipo

# WRR

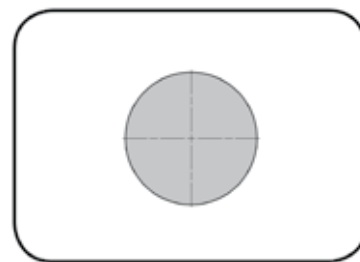

Barreaux carbure cylindriques, frittés  
Barre piene in metallo duro

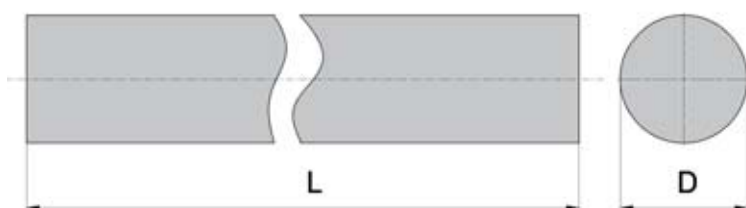

N° de commande Codice prodotto	Description Descrizione	D	L	HK1F	HK6F	HK1U	HK2U
WRR01333000000	Ø 1,3 x 330	1,3	330	▲	▲		
WRR01533000000	Ø 1,5 x 330	1,5		▲	▲		
WRR01633000000	Ø 1,6 x 330	1,6		▲	▲		
WRR01833000000	Ø 1,8 x 330	1,8		▲	▲		
WRR02033000000	Ø 2,0 x 330	2,0		▲	▲		
WRR02333000000	Ø 2,3 x 330	2,3		▲	▲		
WRR02533000000	Ø 2,5 x 330	2,5		▲	▲		
WRR02833000000	Ø 2,8 x 330	2,8		▲	▲		
WRR03233000000	Ø 3,2 x 330	3,2		▲	▲		
WRR03333000000	Ø 3,3 x 330	3,3		▲	▲	▲	▲
WRR03533000000	Ø 3,5 x 330	3,5		▲	▲		
WRR03833000000	Ø 3,8 x 330	3,8		▲	▲		
WRR04333000000	Ø 4,3 x 330	4,3		▲	▲		
WRR04833000000	Ø 4,8 x 330	4,8		▲	▲		
WRR05333000000	Ø 5,3 x 330	5,3		▲	▲	▲	▲
WRR05433000000	Ø 5,4 x 330	5,4		▲	▲		
WRR05833000000	Ø 5,8 x 330	5,8		▲	▲		
WRR06333000000	Ø 6,3 x 330	6,3		▲	▲	▲	▲
WRR06733000000	Ø 6,7 x 330	6,7		▲	▲		
WRR07333000000	Ø 7,3 x 330	7,3		▲	▲		
WRR07833000000	Ø 7,8 x 330	7,8	▲	▲			
▲ en stock / a stock Δ 4 semaines / consegna 4 settimane				P	•	•	•
• Premier choix / raccomandato				M	o	o	o
o Choix alternatif / alternativa				K	•	•	•
■ Nuance non revêtue / non rivestito				N	•	•	•
■ Nuance revêtue / rivestito				S	o	o	o
■ brasé/Cermet / saldobrasato/Cermet				H			

Dimensions en mm  
Dimensioni in mm

Nuance  
Leghe

# BARREAUX CARBURE

## BARRE CILINDRICHES IN METALLO DURO



### BARREAUX CARBURE Type **WRR**

BARRE IN METALLO DURO Tipo

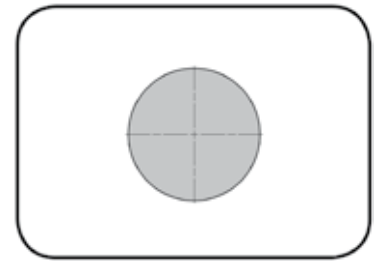

Barreaux carbure cylindriques, frittés  
Barre piene in metallo duro

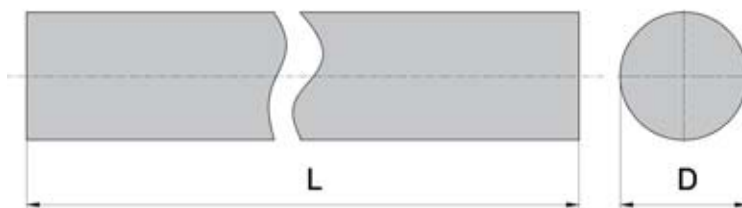

N° de commande Codice prodotto	Description Descrizione	D	L	HK1F	HK6F	HK1U	HK2U
WRR0833300000	Ø 8,3 x 330	8,3	330	▲	▲	▲	▲
WRR0883300000	Ø 8,8 x 330	8,8					
WRR0933300000	Ø 9,3 x 330	9,3					
WRR0983300000	Ø 9,8 x 330	9,8					
WRR1033300000	Ø 10,3 x 330	10,3					
WRR1083300000	Ø 10,8 x 330	10,8					
WRR1133300000	Ø 11,3 x 330	11,3					
WRR1233300000	Ø 12,3 x 330	12,3					
WRR1283300000	Ø 12,8 x 330	12,8					
WRR1333300000	Ø 13,3 x 330	13,3					
WRR1433300000	Ø 14,3 x 330	14,3					
WRR1483300000	Ø 14,8 x 330	14,8					
WRR1533300000	Ø 15,3 x 330	15,3					
WRR1633300000	Ø 16,3 x 330	16,3					
WRR1683300000	Ø 16,8 x 330	16,8					
WRR1733300000	Ø 17,3 x 330	17,3					
WRR1833300000	Ø 18,3 x 330	18,3					
WRR1883300000	Ø 18,8 x 330	18,8					
WRR1933300000	Ø 19,3 x 330	19,3					
WRR2033300000	Ø 20,3 x 330	20,3					
WRR2083300000	Ø 20,8 x 330	20,8					
▲ en stock / a stock   Δ 4 semaines / consegna 4 settimane				P	•	•	•
● Premier choix / raccomandato				M	o	o	o
o Choix alternatif / alternativa				K	•	•	•
■ Nuance non revêtue / non rivestito				N	•	•	•
■ Nuance revêtue / rivestito				S	o	o	o
■ brasé/Cermet / saldobrasato/Cermet				H			

Dimensions en mm  
Dimensioni in mm

Nuance  
Leghe

# BARREAUX CARBURE

## BARRE CILINDRICHE IN METALLO DURO



### BARREAUX CARBURE Type **WRR**

BARRE IN METALLO DURO Tipo

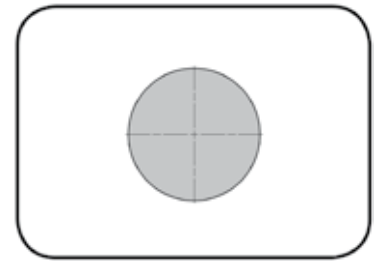

Barreaux carbure cylindriques, frittés  
Barre piene in metallo duro

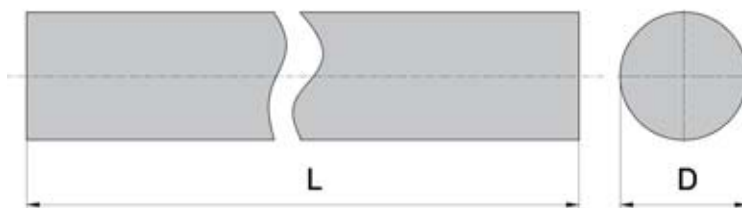

N° de commande Codice prodotto	Description Descrizione	D	L	HK1F	HK6F	HK1U	HK2U		
WRR2133300000	Ø 21,3 x 330	21,3	330	▲	▲				
WRR2233300000	Ø 22,3 x 330	22,3		▲	▲				
WRR2283300000	Ø 22,8 x 330	22,8		▲	▲				
WRR2333300000	Ø 23,3 x 330	23,3		▲	▲				
WRR2433300000	Ø 24,3 x 330	24,3		▲	▲				
WRR2533300000	Ø 25,3 x 330	25,3		▲	▲	▲	▲		
WRR2583300000	Ø 25,8 x 330	25,8		▲	▲				
WRR2633300000	Ø 26,3 x 330	26,3		▲	▲				
WRR2833300000	Ø 28,3 x 330	28,3		▲	▲				
WRR3033300000	Ø 30,3 x 330	30,3		▲	▲				
WRR3263300000	Ø 32,6 x 330	32,6		▲	▲				
WRR3463300000	Ø 34,6 x 330	34,6		▲	▲				
WRR3663300000	Ø 36,6 x 330	36,6		▲	▲				
WRR3863300000	Ø 38,6 x 330	38,6		▲	▲				
WRR4063300000	Ø 40,6 x 330	40,6		▲	▲				
WRR5063300000	Ø 50,6 x 330	50,6		▲	▲				
WRR6063300000	Ø 60,6 x 330	60,6		▲	▲				
▲ en stock / a stock   Δ 4 semaines / consegna 4 settimane					P	•	•	•	•
• Premier choix / raccomandato					M	o	o	o	o
o Choix alternatif / alternativa				K	•	•	•	•	
■ Nuance non revêtue / non rivestito				N	•	•	•	•	
■ Nuance revêtue / rivestito				S	o	o	o	o	
■ brasé/Cermet / saldobrasato/Cermet				H					

Dimensions en mm  
Dimensioni in mm

Nuance  
Leghe

# BARREAUX CARBURE

## BARRE CILINDRICHE IN METALLO DURO



### BARREAUX CARBURE Type **WRG**

BARRE IN METALLO DURO Tipo

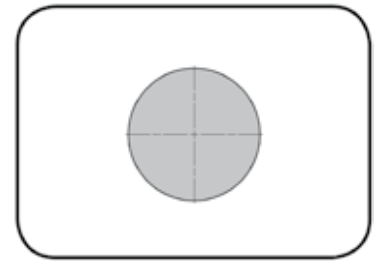

Barreaux carbure cylindrique, rectifiés h6  
Barre piene in metallo duro rettificate con tolleranza h6

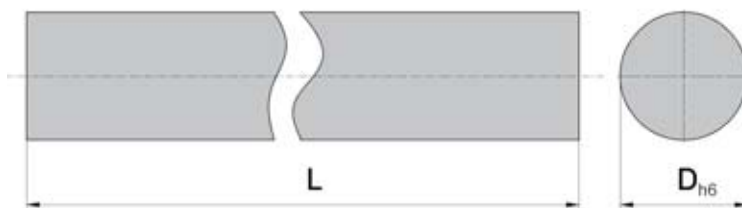

N° de commande Codice prodotto	Description Descrizione	D	L	HK1F	HK6F	HK1U	HK2U
WRG01033000000	Ø 1h6 x 330	1,0	330	▲	▲		
WRG01533000000	Ø 1,5h6 x 330	1,5	330	▲	▲		
WRG02033000000	Ø 2h6 x 330	2,0	330	▲	▲		▲
WRG02533000000	Ø 2,5h6 x 330	2,5	330	▲	▲		
WRG03010000000	Ø 3h6 x 100	3,0	100	Δ			
WRG03033000000	Ø 3h6 x 330	3,0	330	Δ	▲	▲	▲
WRG03533000000	Ø 3,5h6 x 330	3,5	330	▲	▲		
WRG04010000000	Ø 4h6 x 100	4,0	100	Δ			
WRG04033000000	Ø 4h6 x 330	4,0	330	▲	▲	▲	▲
WRG04533000000	Ø 4,5h6 x 330	4,5	330	Δ	Δ		
WRG05010000000	Ø 5h6 x 100	5,0	100	Δ			
WRG05033000000	Ø 5h6 x 330	5,0	330	▲	▲	▲	▲
WRG05533000000	Ø 5,5h6 x 330	5,5	330	Δ	Δ		
WRG06010000000	Ø 6h6 x 100	6,0	100	Δ			
WRG06033000000	Ø 6h6 x 330	6,0	330	▲	▲	▲	▲
WRG06533000000	Ø 6,5h6 x 330	6,5	330	Δ	Δ		
WRG07033000000	Ø 7h6 x 330	7,0	330	▲	▲		
WRG07533000000	Ø 7,5h6 x 330	7,5	330	Δ	Δ		
WRG08010000000	Ø 8h6 x 100	8,0	100	Δ			
WRG08033000000	Ø 8h6 x 330	8,0	330	Δ	▲	▲	▲
WRG08533000000	Ø 8,5h6 x 330	8,5	330	Δ	Δ		
				P	●	●	●
				M	○	○	○
				K	●	●	●
				N	●	●	●
				S	○	○	○
				H			

- ▲ en stock / a stock Δ 4 semaines / consegna 4 settimane
- Premier choix / raccomandato
- Choix alternatif / alternativa
- Nuance non revêtue / non rivestito
- Nuance revêtue / rivestito
- brasé/Cermet / saldobrasato/Cermet

Dimensions en mm  
Dimensioni in mm

Nuance  
Leghe

# BARREAUX CARBURE

## BARRE CILINDRICHE IN METALLO DURO



### BARREAUX CARBURE Type **WRG**

BARRE IN METALLO DURO Tipo

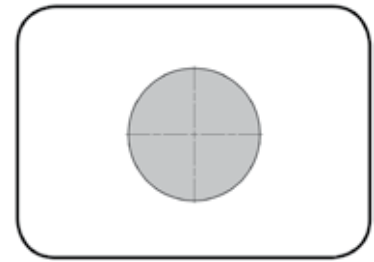

Barreaux carbure cylindriques, rectifiés h6  
Barre piene in metallo duro rettificate con tolleranza h6

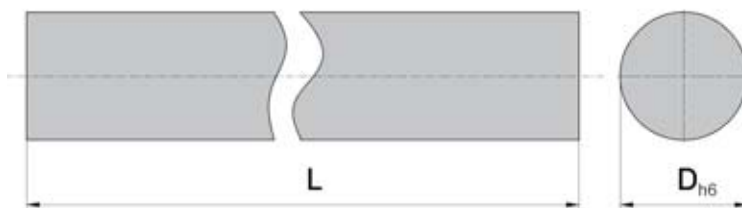

N° de commande Codice prodotto	Description Descrizione	D	L	HK1F	HK6F	HK1U	HK2U
WRG09033000000	Ø 9h6 x 330	9,0	330	▲	▲		
WRG09533000000	Ø 9,5h6 x 330	9,5	330	△	△		
WRG10010000000	Ø 10h6 x 100	10,0	100	△			
WRG10033000000	Ø 10h6 x 330	10,0	330	▲	▲	▲	▲
WRG10533000000	Ø 10,5h6 x 330	10,5	330	△	△		
WRG11033000000	Ø 11h6 x 330	11,0	330	△	△		
WRG11533000000	Ø 11,5h6 x 330	11,5	330	△	△		
WRG12010000000	Ø 12h6 x 100	12,0	100	△			
WRG12033000000	Ø 12h6 x 330	12,0	330	▲	▲	▲	▲
WRG12533000000	Ø 12,5h6 x 330	12,5	330	△	△		
WRG13033000000	Ø 13h6 x 330	13,0	330	▲	▲		
WRG13533000000	Ø 13,5h6 x 330	13,5	330	△	△		
WRG14010000000	Ø 14h6 x 100	14,0	100	△			
WRG14033000000	Ø 14h6 x 330	14,0	330	▲	▲	▲	▲
WRG14533000000	Ø 14,5h6 x 330	14,5	330	△	△		
WRG15033000000	Ø 15h6 x 330	15,0	330	▲	△		
WRG16010000000	Ø 16h6 x 100	16,0	100	△			
WRG16033000000	Ø 16h6 x 330	16,0	330	▲	▲	▲	▲
WRG17033000000	Ø 17h6 x 330	17,0	330	△	△		
WRG18033000000	Ø 18h6 x 330	18,0	330	▲	▲		

▲ en stock / a stock    △ 4 semaines / consegna 4 settimane

● Premier choix / raccomandato

○ Choix alternatif / alternativa

■ Nuance non revêtue / non rivestito

■ Nuance revêtue / rivestito

■ brasé/Cermet / saldobrasato/Cermet

P	●	●	●	●
M	○	○	○	○
K	●	●	●	●
N	●	●	●	●
S	○	○	○	○
H				

Dimensions en mm  
Dimensioni in mm

Nuance  
Leghe

# BARREAUX CARBURE

## BARRE CILINDRICHE IN METALLO DURO



### BARREAUX CARBURE Type **WRG**

BARRE IN METALLO DURO Tipo

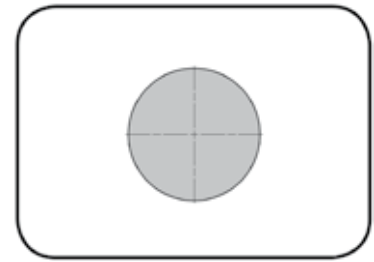

Barreaux carbure cylindriques, rectifiés h6  
Barre piene in metallo duro rettificate con tolleranza h6

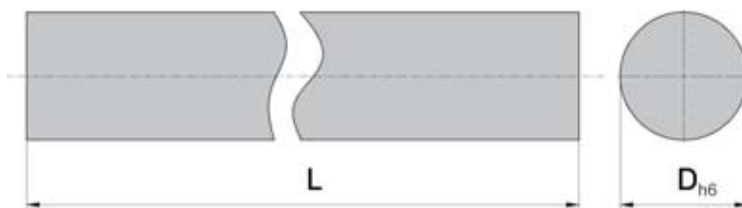

N° de commande Codice prodotto	Description Descrizione	D	L	HK1F	HK6F	HK1U	HK2U
WRG19033000000	Ø 19h6 x 330	19	330	Δ	Δ		
WRG20010000000	Ø 20h6 x 100	20	100	Δ			
WRG20033000000	Ø 20h6 x 330	20	330	▲	▲	▲	▲
WRG21033000000	Ø 21h6 x 330	21	330	Δ	Δ		
WRG22033000000	Ø 22h6 x 330	22	330	▲			
WRG23033000000	Ø 23h6 x 330	23	330	Δ	Δ		
WRG24033000000	Ø 24h6 x 330	24	330	▲			
WRG25010000000	Ø 25h6 x 100	25	100	Δ			
WRG25033000000	Ø 25h6 x 330	25	330	▲	▲	▲	▲
WRG26033000000	Ø 26h6 x 330	26	330	Δ	Δ		
WRG28033000000	Ø 28h6 x 330	28	330	▲	▲		
WRG30033000000	Ø 30h6 x 330	30	330	▲	▲		
WRG32033000000	Ø 32h6 x 330	32	330	▲	▲		
WRG34033000000	Ø 34h6 x 330	34	330	▲	▲		
WRG36033000000	Ø 36h6 x 330	36	330	Δ	Δ		
WRG38033000000	Ø 38h6 x 330	38	330	Δ	Δ		
WRG40033000000	Ø 40h6 x 330	40	330	Δ	Δ		
				P	•	•	•
				M	o	o	o
				K	•	•	•
				N	•	•	•
				S	o	o	o
				H			

▲ en stock / a stock Δ 4 semaines / consegna 4 settimane

• Premier choix / raccomandato

o Choix alternatif / alternativa

■ Nuance non revêtue / non rivestito

■ Nuance revêtue / rivestito

■ brasé/Cermet / saldobrasato/Cermet

Dimensions en mm

Dimensioni in mm

Nuance  
Leghe

# BARREAUX CARBURE

## BARRE CILINDRICHE IN METALLO DURO



### BARREAUX CARBURE Type **WRG**

BARRE IN METALLO DURO Tipo

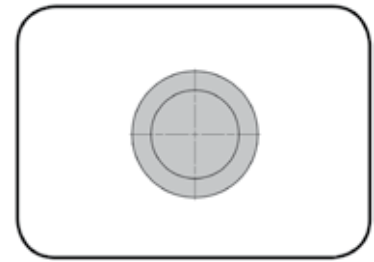

Barreaux carbure cylindriques, rectifiés h6, avec un coté chanfreiné  
Barre piene in metallo duro con smusso; rettificata con tolleranza h6

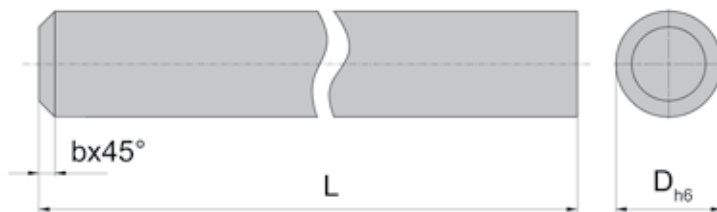

N° de commande Codice prodotto	Description Descrizione	D	L	b	HK1F	HK2U
WRG030038F0000	Ø 3h6 x 38	3	38	0,3	▲	▲
WRG030057F0000	Ø 3h6 x 57	3	57	0,3	▲	▲
WRG040050F0000	Ø 4h6 x 50	4	50	0,4	▲	▲
WRG040054F0000	Ø 4h6 x 54	4	54	0,4	▲	
WRG040057F0000	Ø 4h6 x 57	4	57	0,4	▲	
WRG050050F0000	Ø 5h6 x 50	5	50	0,4	▲	▲
WRG050054F0000	Ø 5h6 x 54	5	54	0,4	▲	
WRG050057F0000	Ø 5h6 x 57	5	57	0,4	▲	
WRG060054F0000	Ø 6h6 x 50	6	50	0,4	▲	▲
WRG060057F0000	Ø 6h6 x 57	6	57	0,4	▲	▲
WRG080058F0000	Ø 8h6 x 58	8	58	0,4	▲	
WRG080063F0000	Ø 8h6 x 63	8	63	0,4	▲	▲
WRG100066F0000	Ø 10h6 x 66	10	66	0,5	▲	▲
WRG100072F0000	Ø 10h6 x 72	10	72	0,5	▲	▲
WRG120073F0000	Ø 12h6 x 73	12	73	0,6	▲	▲
WRG120083F0000	Ø 12h6 x 83	12	83	0,6	▲	▲
WRG140075F0000	Ø 14h6 x 75	14	75	0,8	▲	
WRG140083F0000	Ø 14h6 x 83	14	83	0,8	▲	▲
WRG160082F0000	Ø 16h6 x 82	16	82	0,8	▲	▲
WRG160092F0000	Ø 16h6 x 92	16	92	0,8	▲	▲

▲ en stock / a stock Δ 4 semaines / consegna 4 settimane

● Premier choix / raccomandato

○ Choix alternatif / alternativa

■ Nuance non revêtue / non rivestito

■ Nuance revêtue / rivestito

■ brasé/Cermet / saldobrasato/Cermet

P	●	●
M	○	○
K	●	●
N	●	●
S	○	○
H		

Dimensions en mm  
Dimensioni in mm

Nuance  
Leghe

# BARREAUX CARBURE

## BARRE CILINDRICHE IN METALLO DURO



### BARREAUX CARBURE Type **WRG**

BARRE IN METALLO DURO Tipo

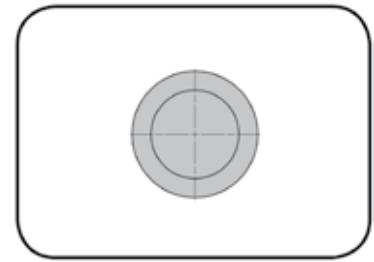

Barreaux carbure cylindriques, rectifiés h6, avec un coté chanfreiné  
Barre piene in metallo duro con smusso; rettificata con tolleranza h6

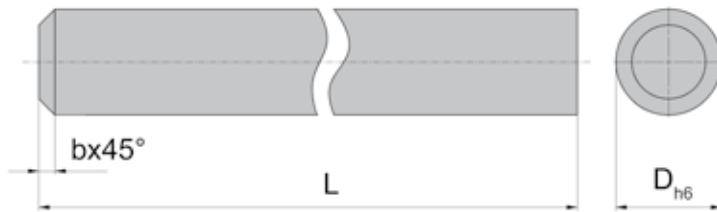

N° de commande Codice prodotto	Description Descrizione	D	L	b	HK1F	HK2U
<b>WRG160125F0000</b>	Ø 16h6 x 125	16	125	0,8	Δ	
<b>WRG160150F0000</b>	Ø 16h6 x 150	16	150	0,8	Δ	
<b>WRG180084F0000</b>	Ø 18h6 x 84	18	84	1,0	▲	
<b>WRG180092F0000</b>	Ø 18h6 x 92	18	92	1,0	▲	▲
<b>WRG200092F0000</b>	Ø 20h6 x 92	20	92	1,0	▲	
<b>WRG200125F0000</b>	Ø 20h6 x 125	20	125	1,0	▲	▲
<b>WRG200150F0000</b>	Ø 20h6 x 150	20	150	1,0	Δ	
<b>WRG250122F0000</b>	Ø 25h6 x 122	25	122	1,0	Δ	
<b>WRG250150F0000</b>	Ø 25h6 x 150	25	150	1,0	Δ	

▲ en stock / a stock Δ 4 semaines / consegna 4 settimane

● Premier choix / raccomandato

o Choix alternatif / alternativa

■ Nuance non revêtue / non rivestito

■ Nuance revêtue / rivestito

■ brasé/Cermet / saldobrasato/Cermet

P	●	●
M	○	○
K	●	●
N	●	●
S	○	○
H		

Dimensions en mm

Dimensioni in mm

Nuance  
Leghe