

HSK Master Shanks (DIN 69893)

Balanced

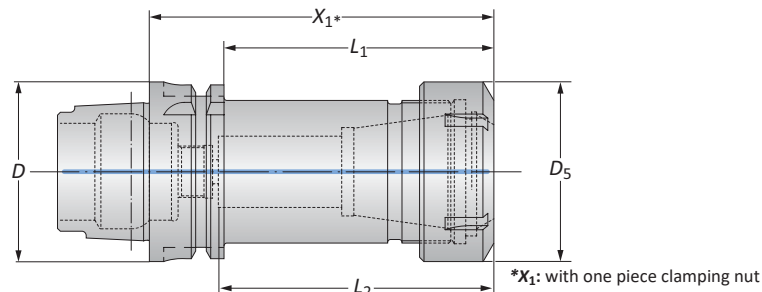
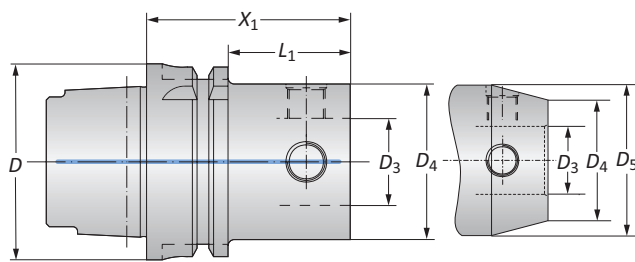

Taper Size	Connection	Shank				Weight	Part No.		
		D	D ₄ D ₃	X ₁	L ₁			L ₂	D ₅
40	40 - 22	40	22	56.00	-	-	-	0.40 (kg)	246016
40	50 - 28	40	28	70.00	-	-	-	0.70 (kg)	246004
50	40 - 22	50	22	56.00	30.00	-	-	0.60 (kg)	246015
50	50 - 28	50	28	65.00	-	-	-	0.80 (kg)	245011
63	25 - 14	63	14	46.00	20.00	-	-	0.70 (kg)	246012
63	32 - 18	63	18	56.00	30.00	-	-	0.80 (kg)	246013
63	40 - 22	63	22	56.00	30.00	-	-	0.80 (kg)	246014
63	50 - 28	63	28	65.00	39.00	-	-	1.10 (kg)	245012
63	63 - 36	63	36	80.00	-	-	-	1.50 (kg)	245013
63	80 - 36	63	36	80.00	-	-	-	2.10 (kg)	246009
63	ER 40	63	ER 40	120.00	94.00	95.00	63.00	1.70 (kg)	252090**
100	50 - 28	100	28	65.00	36.00	-	-	2.40 (kg)	245014
100	50 - 28	100	28	180.00	151.00	-	60.00	5.00 (kg)	246020
100	50 - 28*	100	28	180.00	151.00	-	-	4.00 (kg)	246021
100	63 - 36	100	36	80.00	51.00	-	-	2.90 (kg)	245015
100	63 - 36	100	36	205.00	176.00	-	78.00	7.80 (kg)	246019
100	63 - 36	100	36	205.00	176.00	-	-	7.80 (kg)	246022
100	80 - 36	100	36	80.00	51.00	-	-	3.70 (kg)	245016
100	80 - 36	100	36	255.00	226.00	-	90.00	12.60 (kg)	246018
100	80 - 36	100	36	255.00	226.00	-	-	10.40 (kg)	246023
100	100 - 56	100	56	100.00	-	-	-	5.00 (kg)	246010
100	100 - 56	100	56	300.00	221.00	-	-	17.50 (kg)	246017
100	ER 40	100	ER 40	120.00	91.00	88.00	63.00	3.50 (kg)	252091**

NOTE: Balanced refers to a specific residual imbalance of ≤4.00 gmm/kg

*D₄ = 49.50 mm

**Balanced without clamping nut

B10-M: 12-13

B10: VI-VII

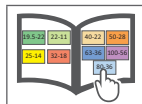
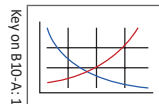

Ⓜ = Metric (mm)

⚠ WARNING Exceeding weight capacity for machine tool spindle and tool changer can cause machine damage and/or serious injury. To prevent:

- Consult machine tool builder for machine's weight limitations.
- Refer to example on page B10-M: 11 for calculating tool assembly weight
- Factory technical assistance is also available for specific applications through our Application Engineering department. *email: engineering.eu@alliedmachine.com*

⚠ WARNING Tool failure can cause serious injury. To prevent:

- Do not exceed recommended 10xD length-to-diameter ratio or exceed 4 total components (including shank)
- When using Alu-Line® components, do not exceed recommended 5xD length-to-diameter ratio
- When using tool steel components, do not exceed recommended 6xD length-to-diameter ratio
- When using heavy metal reducers, do not exceed recommended 8xD length-to-diameter ratio
- When using a carbide shank, do not exceed recommended 9xD length-to-diameter ratio
- When using a NOVITECH® module, do not exceed recommended 10xD length-to-diameter ratio
- Refer to examples on pages B10-M: 8-10 for calculating length-to-diameter ratio
- Factory technical assistance is available for your specific applications through our Application Engineering department. *email: engineering.eu@alliedmachine.com*

A
B
C
D
E
F
G
H
I
J
K
L
M
INDEX