

DIN 2080 Master Shanks

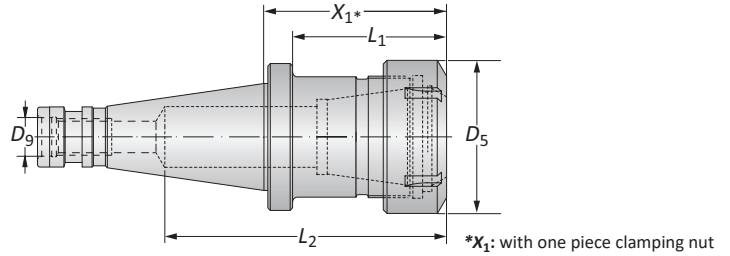

Taper Size	Connection	Shank					Weight	Part No.	
	$D_4 D_3$	X_1	L_1	L_2	D_5	D_9			
m	40	50 - 28	38.00	26.40	-	-	M16 x 2	1.30 (kg)	132022T010229
	40	63 - 36	48.00	36.40	-	-	M16 x 2	1.50 (kg)	132066T010229
	50	50 - 28	42.00	26.80	-	-	M24 x 3	3.00 (kg)	132022T003704
	50	63 - 36	52.00	36.80	-	-	M24 x 3	3.50 (kg)	132066T003704
	50	80 - 36	52.00	36.80	-	-	M24 x 3	4.00 (kg)	132088T003704
	50	100 - 56	90.00	74.80	-	-	M24 x 3	4.90 (kg)	132076T003704
	50	ER 40	80.00	64.80	134.00	63.00	M24 x 3	3.30 (kg)	259084

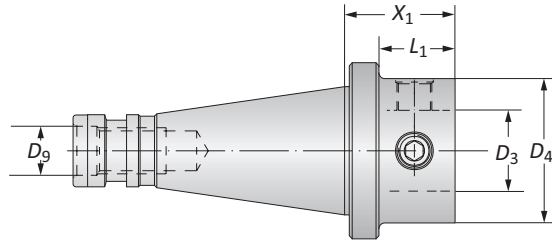
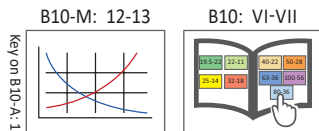

m = Metric (mm)

WARNING Exceeding weight capacity for machine tool spindle and tool changer can cause machine damage and/or serious injury. To prevent:
 -Consult machine tool builder for machine's weight limitations.
 -Refer to example on page B10-M: 11 for calculating tool assembly weight
 Factory technical assistance is also available for specific applications through our Application Engineering department. *email: engineering.eu@alliedmachine.com*

WARNING Tool failure can cause serious injury. To prevent:
 -Do not exceed recommended 10xD length-to-diameter ratio or exceed 4 total components (including shank)
 -When using Alu-Line® components, do not exceed recommended 5xD length-to-diameter ratio
 -When using tool steel components, do not exceed recommended 6xD length-to-diameter ratio
 -When using heavy metal reducers, do not exceed recommended 8xD length-to-diameter ratio
 -When using a carbide shank, do not exceed recommended 9xD length-to-diameter ratio
 -When using a NOVITECH® module, do not exceed recommended 10xD length-to-diameter ratio
 -Refer to examples on pages B10-M: 8-10 for calculating length-to-diameter ratio
 Factory technical assistance is available for your specific applications through our Application Engineering department. *email: engineering.eu@alliedmachine.com*

A
B
C
D
E
F
G
H
I
J
K
L
M
INDEX